

Series 65 Dummy Receptacles

for MIL-DTL-83723 Series III and MIL-DTL-26500 Connectors

650ES001, 650ES002

650ES001 DUMMY RECEPTACLE FOR MIL-DTL-83723 SERIES III AND MIL-DTL-26500 CONNECTORS

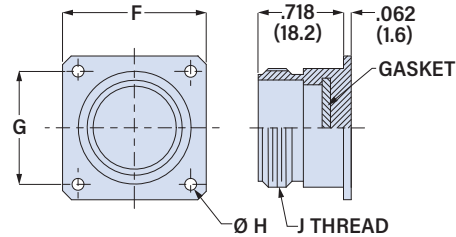

Use dummy storage receptacle to secure and protect unused plugs. 650ES001 receptacle accommodates MIL-DTL-83723 Series III and MIL-DTL-26500 threaded coupling plug connectors. Silicone gasket.

Shell Size	Part Number * = Finish Code from Table 1	J Thread UNEF-2A	F		G		Ø H	
			± .015 (0.4) In.	mm.	± .015 (0.4) In.	mm.	± .015 (0.4) In.	mm.
08	650ES001*08	.5625-24	.812	20.6	.594	15.1	.125	3.2
10	650ES001*10	.6875-24	.937	23.8	.719	18.3	.125	3.2
12	650ES001*12	.8750-20	1.031	26.2	.812	20.6	.125	3.2
14	650ES001*14	.9375-20	1.125	28.6	.906	23.0	.125	3.2
16	650ES001*16	1.0625-18	1.250	31.8	.969	24.6	.125	3.2
18	650ES001*18	1.1875-18	1.343	34.1	1.062	27.0	.125	3.2
20	650ES001*20	1.3125-18	1.437	36.5	1.156	29.4	.125	3.2
22	650ES001*22	1.4375-18	1.562	39.7	1.250	31.8	.125	3.2
24	650ES001*24	1.5625-18	1.703	43.3	1.375	34.9	.154	3.9

TABLE 1 FINISH CODES

Aluminum	Stainless Steel
C Black Anodize	Z1 Passivate
M Electroless Nickel	
NF Olive Drab Cadmium	
MT Nickel-PTFE	
ZR Black Zinc-Nickel	
TZ Tin-Zinc	

650ES002 DUMMY RECEPTACLE FOR MIL-DTL-83723 SERIES III AND MIL-DTL-26500 CONNECTORS

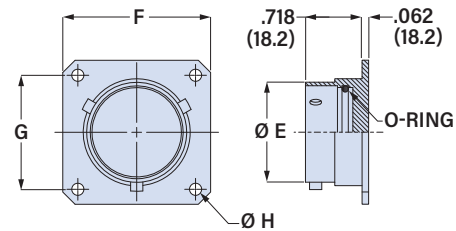

Use dummy storage receptacle to secure and protect unused plugs. 650ES002 receptacle accommodates MIL-DTL-83723 Series III and MIL-DTL-26500 bayonet coupling plug connectors. Silicone O-ring, stainless steel bayonet pins. Paint stripes indicate bayonet pin locations.

Shell Size	Part Number * = Finish Code from Table 1	Ø E		F		G		Ø H	
		± .015 (0.4) In.	mm.	± .015 (0.4) In.	mm.	± .015 (0.4) In.	mm.	± .015 (0.4) In.	mm.
08	650ES002*08	.536	13.6	.812	20.6	.594	15.1	.125	3.2
10	650ES002*10	.659	16.7	.937	23.8	.719	18.3	.125	3.2
12	650ES002*12	.829	21.8	1.031	26.2	.812	20.6	.125	3.2
14	650ES002*14	.898	22.8	1.125	28.6	.906	23.0	.125	3.2
16	650ES002*16	1.025	26.0	1.250	31.8	.969	24.6	.125	3.2
18	650ES002*18	1.131	28.7	1.343	34.1	1.062	27.0	.125	3.2
20	650ES002*20	1.256	31.9	1.437	36.5	1.156	29.4	.125	3.2
22	650ES002*22	1.381	35.1	1.562	39.7	1.250	31.8	.125	3.2
24	650ES002*24	1.506	38.3	1.703	43.3	1.375	34.9	.154	3.9

TABLE 1 FINISH CODES

Aluminum	Stainless Steel
C Black Anodize	Z1 Passivate
M Electroless Nickel	
NF Olive Drab Cadmium	
MT Nickel-PTFE	
ZR Black Zinc-Nickel	
TZ Tin-Zinc	