

# Series 66 Protective Covers

for Series 801 Mighty Mouse Connectors

## 667-218 Receptacle Cover

### MM801 Receptacle Cover



667-218 protective cover fits Glenair Series 801 and Series 811 receptacle connectors. Aluminum or stainless steel, with stainless steel fittings. Fluorosilicone gasket.

**TABLE 1 MATERIAL / FINISH**

Aluminum	Stainless Steel
-C Black Anodize	-Z1 Passivate
-M Electroless Nickel	
-NF Olive Drab Cadmium	
-MT Nickel-PTFE	
-ZR Black Zinc-Nickel	
-TZ Tin-Zinc	

**TABLE 2 ATTACHMENT TYPE**

<b>D</b>	<b>SST Bead Chain</b> .125 (3.2) diameter, size 6, -65 to +200 °C
<b>F</b>	<b>Wire Rope, Blue Nylon Jacket</b> 6/6 nylon over stainless steel rope, fair flexibility, good abrasion resistance, -55 to +100 °C
<b>G</b>	<b>Black Nylon Rope</b> Very flexible, good abrasion and fuel resistance, .094 (2.4) diameter, -55 to +100 °C
<b>H</b>	<b>Wire Rope, Clear FEP Jacket</b> Clear FEP jacket over SST rope, fair flexibility, good abrasion resistance, .100" diameter, -65 to +200 °C
<b>S</b>	<b>Sash Chain</b> #8 sash chain, stainless steel. Length tolerance is ± one link.280 (71)
<b>SK</b>	<b>Nylon Rope with Slip Knot</b> Very flexible, good abrasion and fuel resistance, .094 (2.4) diameter. Length includes .5" (13mm) dia. loop, -55 to +100 °C
<b>T</b>	<b>SST Wire Rope, No Jacket</b> Good flexibility, good abrasion resistance, .047 (1.2) diameter, passivated, -65 to +200 °C
<b>U</b>	<b>Wire Rope, Black Polyurethane</b> Stainless steel rope with black polyurethane coating, flexible, excellent abrasion resistance and resistance to fuels, .080" (2mm) diameter, -55 to +125 °C

### PART NUMBER

	667-218	-ZR	-S	13	04	-5
<b>Base P/N</b>	<b>667-218</b>					
<b>Material/Finish</b>	See Table 1					
<b>Attachment Type</b>	<b>-N</b> No Attachment See Table 2 for Attachment Types					
<b>Shell Size</b>	<b>5 6 7 8 9 10 11 13 16 17 19 21</b>					
<b>Attachment Ring</b>	Omit for Attachment Types N and SK <b>-00</b> No Ring See Table 3 for Attachment Ring Codes					
<b>Attachment Length</b>	Omit for Attachment Type N Length in One Inch Increments					

Shell Size	A Thread	ø C Max	ø D	
			In.	mm.
5	.3125-.05P-.1L-2B	.488	12.4	.368 9.3
6	.375-.05P-.1L-2B	.555	14.1	.453 11.5
7	.4375-.05P-.1L-2B	.615	15.6	.538 13.7
8	.5000-.05P-.1L-2B	.675	17.1	.587 14.9
9	.5625-.05P-.1L-2B	.840	21.3	.648 16.5
10	.6250-.05P-.1L-2B	.905	23.0	.712 18.1
11	.6875-.05P-.1L-2B	.948	24.1	.778 19.8
13	.8125-.1P-.2L-2B	.995	25.3	.904 22.9
16	1.000-.1P-.2L-2B	1.261	32.0	1.092 27.7
17	1.062-.1P-.2L-2B	1.321	33.6	1.158 29.4
19	1.1875-.1P-.2L-2B	1.447	36.8	1.283 32.6
21	1.3125-.1P-.2L-2B	1.570	39.9	1.412 35.8

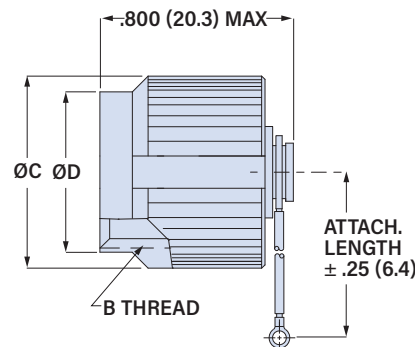

**TABLE 3 ATTACHMENT RING**

EYELET		SOLID RING		SPLIT RING		CABLE TIE	
<b>Code</b>	<b>Eyelet I.D.</b> ±.010 (0.3)	<b>Code</b>	<b>Ring I.D.</b> ±.015 (0.4)	<b>Code</b>	<b>Ring I.D.</b> ±.015 (0.4)	<b>Code</b>	<b>Ring I.D.</b> ±.015 (0.4)
01	.125 (3.2)	32	.265 (6.7)	19	.885 (22.5)	50	.432 (11.0)
02	.145 (3.7)	29	.315 (8.0)	26	.950 (24.1)	52	.492 (12.5)
04	.182 (4.6)	14	.385 (9.8)	28	1.015 (25.8)	54	.648 (16.5)
06	.197 (5.0)	15	.445 (11.3)	20	1.070 (27.2)	56	.757 (19.2)
		33	.510 (13.0)	21	1.135 (28.8)	58	.898 (22.8)
		16	.570 (14.5)	22	1.210 (30.7)	60	1.023 (26.0)
		17	.635 (16.1)	23	1.275 (32.4)	64	1.137 (28.9)
		18	.695 (17.7)	24	1.380 (35.1)	68	1.357 (34.5)
		27	.766 (19.5)	30	1.380 (35.1)		
		31	.820 (20.8)	25	1.530 (38.9)		
							<b>Code WS</b> Black 6/6 nylon cable tie 1.77 (45.0) max. wire bundle dia.