

# Swing-Arm® Clamps

for MIL-DTL-38999 Series I and II Connectors

## 870F004 Swing-Arm Saddle Clamp, EMI Banding Adapter, Composite

**Self-Locking**



**Shielded, self-locking, adjustable arms.** 870F004 Swing-Arm saddle clamp fits MIL-DTL-38999 Series I and II connectors. Adjustable arms pivot to 0°, 45° or 90° positions. Banding adapter has optional "T" slots for pigtailed individual shields. Terminate shield braid to adapter with optional Band-Master ATS® pre-coiled banding strap. Full radius saddles with self-locking clinch nuts. Available in two clamp sizes: standard clamp fits most wire bundles, large clamp has increased clearance for oversize wire bundles. Coupling nut has anti-decoupling mechanism for audible detented coupling and prevents backoff under high vibration.

**Adapter Code F**

This accessory fits these connectors:  
MIL-DTL-38999 Series I and Series II

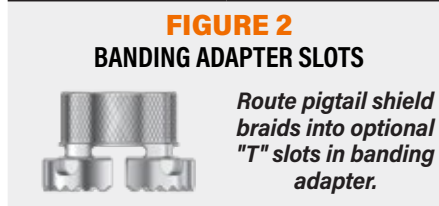
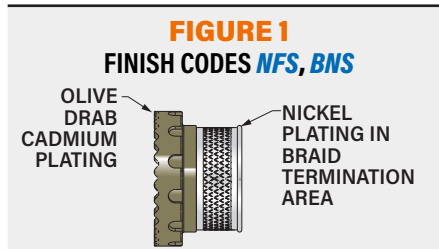

**PART NUMBER**

<b>Base P/N</b>	<b>870F004</b>	<b>870F004</b>	<b>M</b>	<b>22</b>	<b>A</b>	<b>S</b>	<b>K</b>																																																									
<b>Banding Adapter Material/Finish</b>	<p><b>M</b> Alum/Electroless Nickel</p> <p><b>NF</b> Alum/Olive Drab Cadmium</p> <p><b>NFS</b> Alum/O.D. Cadmium, selective (fig. 1)</p> <p><b>MT</b> Alum/Nickel-PTFE</p> <p><b>TZ</b> Alum/Tin-Zinc</p> <p><b>BM</b> Brass/Electroless Nickel</p> <p><b>BN</b> Brass/Olive Drab Cadmium</p> <p><b>BNS</b> Brass/O.D. Cadmium, selective (fig. 1)</p> <p><b>BMT</b> Brass/Nickel-PTFE</p>																																																															
<b>Shell Size</b>	<table border="1"> <tr> <td></td> <td colspan="10">Shell Size</td> </tr> <tr> <td>38999 Series I</td> <td>9</td><td>11</td><td>13</td><td>15</td><td>17</td><td>19</td><td>21</td><td>23</td><td>25</td> <td></td><td></td> </tr> <tr> <td>38999 Series II</td> <td>8</td><td>10</td><td>12</td><td>14</td><td>16</td><td>18</td><td>20</td><td>22</td><td>24</td> <td></td><td></td> </tr> <tr> <td></td> <td colspan="10">Size Code</td> </tr> <tr> <td></td> <td><b>08</b></td><td><b>10</b></td><td><b>12</b></td><td><b>14</b></td><td><b>16</b></td><td><b>18</b></td><td><b>20</b></td><td><b>22</b></td><td><b>24</b></td> <td></td><td></td> </tr> </table>		Shell Size										38999 Series I	9	11	13	15	17	19	21	23	25			38999 Series II	8	10	12	14	16	18	20	22	24				Size Code											<b>08</b>	<b>10</b>	<b>12</b>	<b>14</b>	<b>16</b>	<b>18</b>	<b>20</b>	<b>22</b>	<b>24</b>							
	Shell Size																																																															
38999 Series I	9	11	13	15	17	19	21	23	25																																																							
38999 Series II	8	10	12	14	16	18	20	22	24																																																							
	Size Code																																																															
	<b>08</b>	<b>10</b>	<b>12</b>	<b>14</b>	<b>16</b>	<b>18</b>	<b>20</b>	<b>22</b>	<b>24</b>																																																							
<b>Clamp Size</b>	<p><b>A</b> Standard Clamp</p> <p><b>B</b> Large Clamp</p>																																																															
<b>Banding Adapter Slots</b>	<p>Omit if not required. See Figure 2.</p> <p><b>S</b> "T" Slots in Banding Adapter for Shield Pigtailed</p>																																																															
<b>Band</b>	<p>Omit if not required.</p> <p><b>K</b> Pre-Coiled Micro Band included With Clamp</p> <p><b>J</b> Pre-Coiled Slim Micro Band included With Clamp</p>																																																															

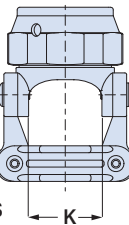
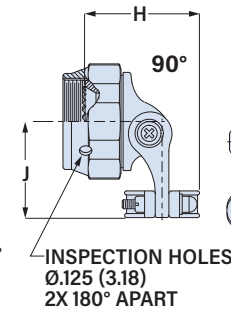
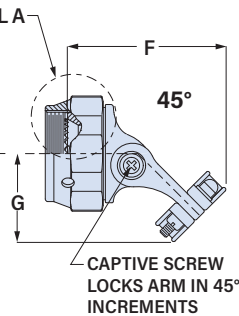
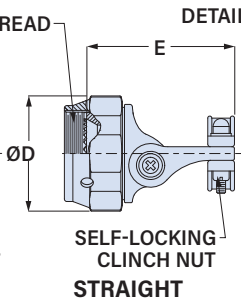
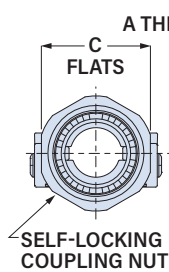
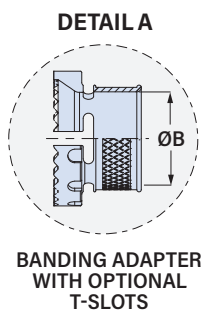

Shell Size	A Thread UNEF-2B	ø B Min in	mm	C Flats in	mm	D Max in	mm	E Max in	mm	F Max in	mm	G Max in	mm	H Max in	mm	J Max in	mm	K Ref. in	mm
8/9	0.4375-28	.178	4.5	.750	19.1	.812	20.6	1.53	38.9	1.46	37.1	.79	20.1	1.01	25.7	.86	21.8	.393	10.0
10/11	0.5625-24	.305	7.7	.875	22.2	.938	23.8	1.58	40.1	1.52	38.6	.83	21.1	1.04	26.4	.93	23.6	.455	11.6
12/13	0.6875-24	.404	10.3	1.000	25.4	1.125	28.6	1.66	42.2	1.67	42.4	.93	23.6	1.17	29.7	1.03	26.2	.598	15.2
14/15	0.8125-20	.526	13.4	1.125	28.6	1.250	31.8	1.67	42.4	1.76	44.7	1.00	25.4	1.28	32.5	1.10	27.9	.710	18.0
16/17	0.9375-20	.631	16.0	1.250	31.8	1.375	34.9	1.77	45.0	1.89	48.0	1.09	27.7	1.40	35.6	1.16	29.5	.839	21.3
18/19	1.0625-18	.748	19.0	1.375	34.9	1.500	38.1	1.77	45.0	1.96	49.8	1.14	29.0	1.50	38.1	1.22	31.0	.934	23.7
20/21	1.1875-18	.877	22.3	1.500	38.1	1.625	41.3	1.92	48.8	2.11	53.6	1.22	31.0	1.57	39.9	1.29	32.8	1.068	27.1
22/23	1.3125-18	.999	25.4	1.625	41.3	1.750	44.5	1.95	49.5	2.18	55.4	1.28	32.5	1.67	42.4	1.36	34.5	1.197	30.4
24/25	1.4375-18	1.127	28.6	1.750	44.5	1.875	47.6	1.98	50.3	2.25	57.2	1.34	34.0	1.73	43.9	1.43	36.3	1.323	33.6

# Swing-Arm® Clamps

for MIL-DTL-38999 Series I and II Connectors

## 870F004 Swing-Arm Saddle Clamp, EMI Banding Adapter, Composite

### CLAMP DIMENSIONS

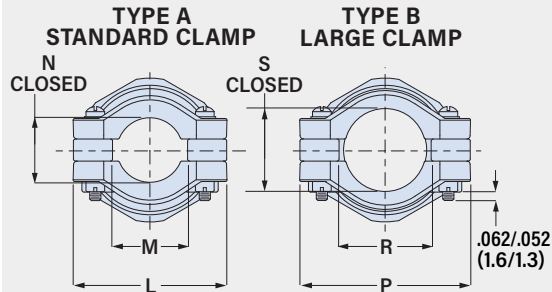

Standard Clamp							Large Clamp						
Shell Size	L Max in	L Max mm	M Min in	M Min mm	N Ref. in	N Ref. mm	Shell Size	P Max in	P Max mm	R Min in	R Min mm	S Ref. in	S Ref. mm
08	.97	24.6	.22	5.6	.264	6.7	08	.98	24.9	.33	8.4	.356	9.0
10	1.03	26.2	.29	7.4	.310	7.9	10	1.20	30.5	.45	11.4	.422	10.7
12	1.21	30.7	.34	8.6	.422	10.7	12	1.45	36.8	.62	15.7	.637	16.2
14	1.32	33.5	.45	11.4	.538	13.7	14	1.54	39.1	.68	17.3	.707	18.0
16	1.45	36.8	.55	14.0	.590	15.0	16	1.60	40.6	.80	20.3	.759	19.3
18	1.54	39.1	.65	16.5	.660	16.8	18	1.73	43.9	.90	22.9	.841	21.4
20	1.67	42.4	.74	18.8	.744	18.9	20	1.95	49.5	1.05	26.7	.996	25.3
22	1.79	45.5	.87	22.1	.826	21.0	22	2.08	52.8	1.18	30.0	1.060	26.9
24	1.92	48.8	.99	25.1	.896	22.8	24	2.32	58.9	1.30	33.0	1.124	28.5

### MATERIAL/FINISH

- Coupling nut, body, arms, saddles: polyetherimide (PEI)/ unplated black
- Screws, washers, inserts: stainless steel/ passivated
- Anti-decoupling springs: thermoplastic
- Banding adapter: aluminum alloy or brass
- Band (optional): stainless steel/ passivated
- Clinch Nuts: stainless steel/ silver plated

### BAND INFORMATION

Terminate cable braid to band adapter with optional pre-coiled banding strap. Glenair's Band-Master ATS® banding system provides quick, easy, cost-effective and highly reliable termination. Band is passivated stainless steel.



Shell Size	Pre-Coiled Micro Band Part No.	Pre-Coiled Slim Micro Band Part No.	Length in	Length mm	Max Diameter in	Max Diameter mm
8 - 12	601-061	601-601	8.125	206	.88	22.4
14 - 24	601-065	601-603	14.25	362	1.88	47.8