

MICRO-CRIMP RECTANGULAR CONNECTORS

Series 793 Dual-Bay



793-019

Receptacle, Cable Mount, Vertical, Crimp

- ◆ Cable mount
- ◆ Pin contacts
- ◆ Crimp termination

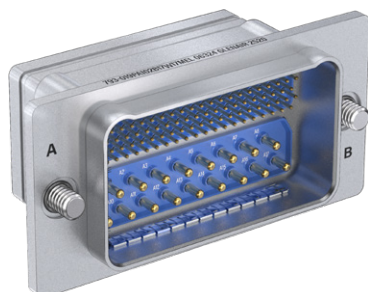

Dual bay cable mount. Space-saving 793-019 receptacle features high-density, high current and high frequency capabilities, saves size and weight compared to legacy rack-and-panel types. Machined scoop-proof shell has groove for attaching backshell. Size 23 contacts are included with connector; size 8, 12 or 16 contacts are ordered separately. Connectors become non-scoop proof at parallel horizontal angles of entry from 16°–47°.

- Aerospace-grade high-density rectangular connector with two inserts
- Scoop-proof polarization
- M39029-type contacts: crimp termination, rear-release

INSERT ARRANGEMENTS

Identification numbers are mating face of receptacle (pin) connector

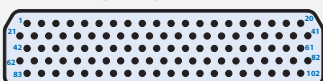

102

102 #23 Contacts

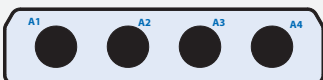

4W4

4 #8 Contacts

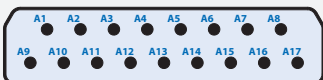

17W17

17 #16 Contacts

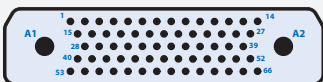

68W2

66 #23, 2 #12 Contacts

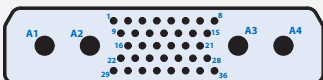

40W4

36 #23, 4 #12 Contacts

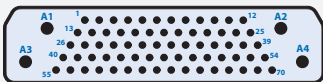

74W4

70 #23, 4 #16 Contacts

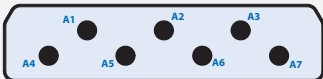

7W7

7 #12 Contacts

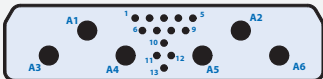

19W6

13 #23, 6 #12 Contacts

HOW TO ORDER

| Sample Part Number | 793-019P | A4W4 | B102 | M | E | P | B |
|----------------------------|--|-----------------|---------------|---------------|---|---|---|
| Basic Part Number | 793-019P Receptacle, Pin Contacts | | | | | | |
| Bay "A" Insert Arr. | A102 A40W4 | A68W2 A17W17 | A7W7 A74W4 | A4W4 A19W6 | | | |
| Bay "B" Insert Arr. | B102 B40W4 | B68W2 B17W17 | B7W7 B74W4 | B4W4 B19W6 | | | |
| Shell Finish | M Electroless Nickel MT Nickel / PTFE N Olive Drab Cadmium TZ Tin-Zinc ZR Black Zinc-Nickel | | | | | | |
| EMI Spring | E EMI Spring N No EMI Spring | | | | | | |
| Hardware Option Table 1 | N Thru-Hole <i>No Hardware</i> K Extended Jackscrews <i>Slot head male</i> L Jackscrews <i>Socket head male</i> P Female Jackposts S Screwlocks <i>Socket head male</i> T Extended Screwlocks <i>Slot head male</i> | | | | | | |
| Polarization Key Option | Enter Letter Designator for Position A, B, C, D, E, F, G, H, J, K, L , or M per Mod Code 1502 (see page D-5 for details) Omit for none | | | | | | |

TABLE ONE HARDWARE OPTION

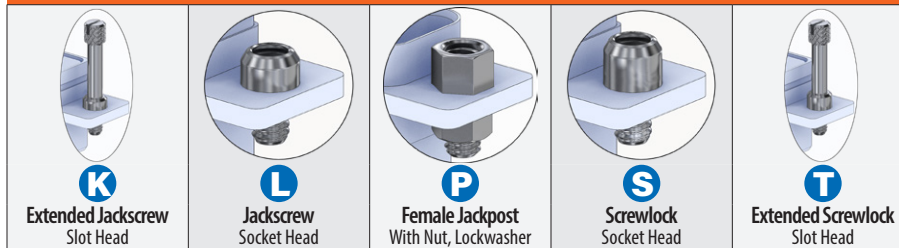

Screwlocks allow connector to be plugged in before the screws are tightened. Jackscrews must be tightened in order to mate connector.

RATINGS

- Voltage (DWV): size 23 contacts 750 VAC, Size 8, 12 and 16: 1800 VAC
- Current: #23 5A, #16 13A, #12 23A, #8 46A
- Operating temperature: -65 to +150 °C
- Durability: 500 mating cycles
- Shock: 300 g
- Vibration: 20 g random
- Altitude immersion: 75,000 feet
- Ingress protection: IP67

CONSTRUCTION

- Contacts: Copper alloy, gold over nickel finish
- Shell: Aluminum
- Insulators: High performance thermoplastic
- Ground spring: BeCu, electroless nickel plated
- Wire grommet, face seal: Fluorosilicone/silicone blend
- Contact retaining clip: Beryllium copper, unplated
- Hardware: Stainless steel

MICRO-CRIMP RECTANGULAR CONNECTORS

Series 793 Dual-Bay

SERIES™
793
Dual-Bay

793-019

Receptacle, Cable Mount, Vertical, Crimp

- ◆ Cable mount
- ◆ Pin contacts
- ◆ Crimp termination

SERIES 793 DUAL-BAY

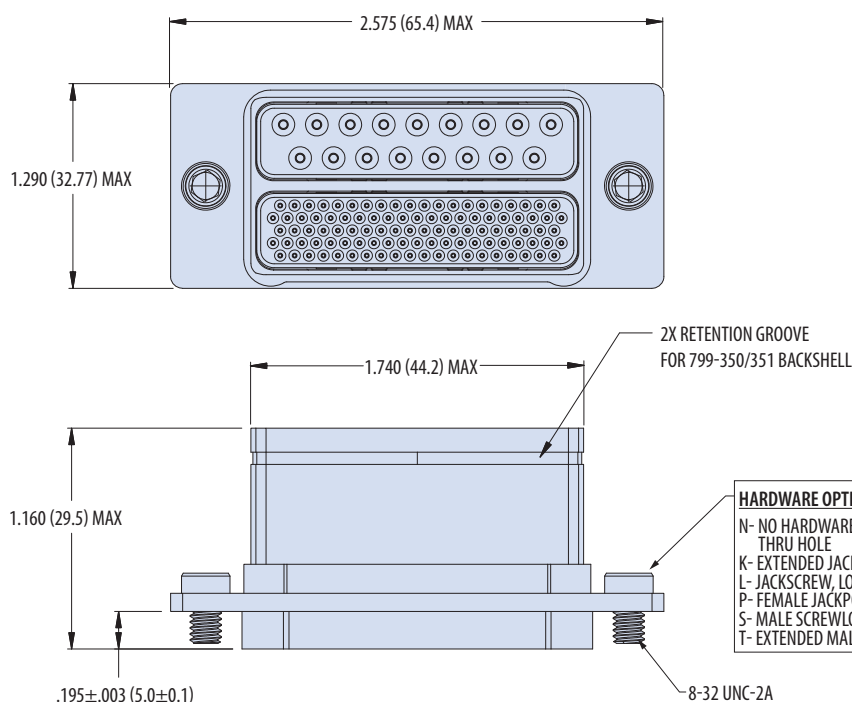

HARDWARE OPTION 2X:
 N- NO HARDWARE: .200 (5.1) DIAMETER THRU HOLE
 K- EXTENDED JACKSCREW, SLOT HD
 L- JACKSCREW, LOW PROFILE SKT HD
 P- FEMALE JACKPOST
 S- MALE SCREWLOCK, LOW PROFILE SKT HD
 T- EXTENDED MALE SCREWLOCK, SLOT HD

⚠ Application Note

EMI Banding Backshell for 793-019 connector

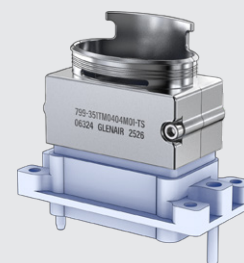

Use backshell part number **799-350** (dual port) or **799-351** (single port). Two piece backshell has lip to lock into groove on connector. Available in top or side entry

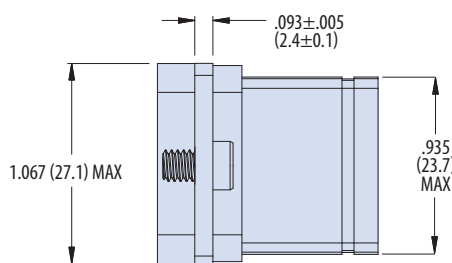

HARDWARE DIMENSIONS

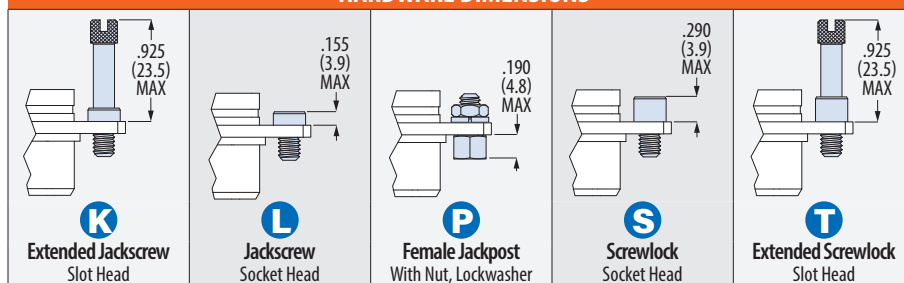

⚠ Application Note

Polarization Key Positions
 See Mod Code 1502 pg. D-5 for details



CRIMP CONTACTS

Size 23 contacts are included with connector. Size 16, 12, and 8 contacts are not included and are ordered separately. See "Contacts and Tools" section for crimp tool info and coaxial contact ordering information.

| Contact Size | Pin Contact Part No. | AWG Wire Size |
|--------------|-----------------------------------|---------------|
| 23 | 809-001 | 22 – 28 |
| 16 | 809-110 (M39029/58-364) | 16 – 20 |
| 12 | 809-112 (M39029/58-365) | 12 – 14 |
| 8 | 850-014F | 8 |