

180-071 (-3) Wall Mount Receptacle Single Channel Connector Environmental Resistant for 181-002 Rear-Release Pin Termini



Tight-tolerance 180-071 single-channel fiber optic wall-mount receptacle connectors are compatible with Size 16 snap-in, rear-release MIL-PRF-29504 pin termini (Glenair Series 181-002). Ultra miniature shell is precision-machined for optimum optical fiber alignment and low dB data loss performance. Backshell accessory threads support the wide range of Glenair fiber optic cable and conduit adapters. Keyed mating interface with five alternate polarizations protects against mis-mating.

MATERIAL AND FINISH

- Interfacial Seal, Rear Grommet: Fluorosilicone.
- Retention Clip: BeCu Alloy

NOTES

- Operating Temperature Range: -55°C to +125°C.
- See Glenair drawing 181-002 for fiber optic pin terminus.
- Recommended Insertion/Extraction tool: P/N M81969/14-03 or equivalent

RECOMMENDED PANEL CUT WALL MOUNT RECEPTACLE

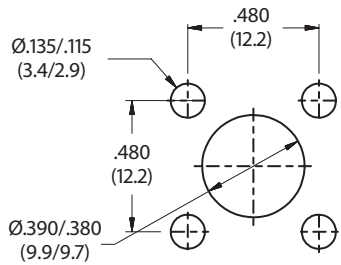

HOW TO ORDER				
Sample Part Number	180-071	-C	3	1
Basic Number	Single-channel fiber optic connector			
Material/Finish	See Material and Finish table			
Wall Mount Receptacle	3			
Alternate Key Position	1, 2, 3, 4, & 5 (See Keyway Polarizations table)			

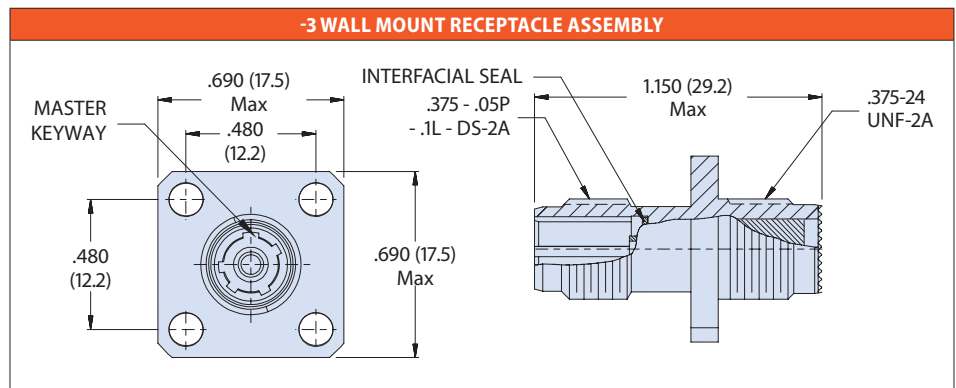

KEY POLARIZATIONS					
	Pos	A°	B°	C°	D°
	1	95	141	208	300
	2	80	141	208	300
	3	95	141	223	300
	4	80	141	223	300
5	95	141	208	275	

MATERIAL AND FINISH		
Code	Material	Finish
C	Aluminum Alloy	Anodize, Black
M*		Electroless Nickel
ME		Electroless Nickel
MT		Nickel-PTFE, Gray
NF		Cadmium, Olive Drab, over Electroless Nickel
TZ		Tin-Zinc, Bronze-Gold
ZN		Zinc-Nickel, Olive Drab, over Electroless Nickel
ZR		Zinc-Nickel, Black
ZN	Zinc-Nickel, Olive Drab	
ZI	Stainless	Passivate
ZL	Steel	Electro-Deposited Nickel

*Inactive for new design. Use "ME" finish.