

SERIES 80 MIGHTY MOUSE CONNECTORS Accessories, Backshells, and Tools



Series 800, 801, 803, 804, and 805 Direct Coupling, Non-Environmental Saddle Clamp



620MS064

Non-environmental clamps provide strain relief for open wire bundles. Add tubing or tape to build up smaller diameter wires to fit the clamps.

Direct coupling clamps provide a low profile solution where space is a concern and are available for Series 800, 801, 803, 804, and 805 Mighty Mouse connectors.

NOTES

1. Material and finish
 - Coupling Nut, Clamp, and Saddles: Aluminum Alloy 6061-T6 or 300 Series SST
 - Hardware: 300 Series Stainless Steel

How To Order	
Sample Part Number	620MS064 M 07
Series (See Table I)	620MS064 = Straight Direct Coupling
Shell Material and Finish	See Table I
Size Code	05, 06, 11, 07, 08, 09, 10, 12, 13, 14, 15, 16, 17; see Table II

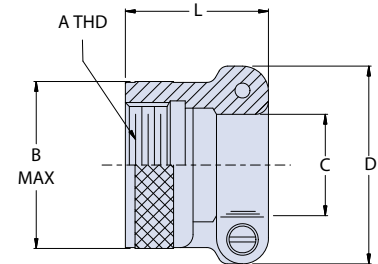

Table I: Material and Finish	
Symbol	Description
C	Aluminum / Black Anodize (Non-Conductive) RoHS Compliant
M	Aluminum / Electroless Nickel
NF	Aluminum / Cadmium with Olive Drab
UCR	Aluminum / Zinc Cobalt / Black
ZN	Aluminum / Zinc-Nickel with Olive Drab Chromate
ZNU	Aluminum / Zinc-Nickel / Black Over Electroless Nickel
MT	Aluminum / Nickel-PTFE
Z1	Stainless Steel / Passivated

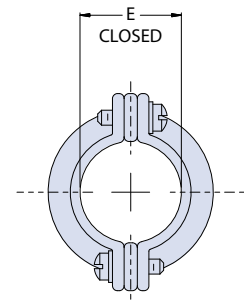

Table II: Size Code and Dimensions								
Size Code	Shell Size Ref		A Thread Class -2B	B Max.	C Dia.	D Dia.	E Dia. Closed	L Max
	Series 800, 801, 803, 804	Series 805						
05	5	N/A	.2500-32 UNEF	.350 (8.89)	.119 (3.02)	.496 (12.60)	.11 (2.79)	.625 (15.88)
06	6	N/A	.3125-32 UNEF	.415 (10.54)	.182 (4.62)	.582 (14.78)	.17 (4.32)	.625 (15.88)
11	N/A	8	.375-32 UNEF	.465 (11.81)	.182 (4.62)	.582 (14.78)	.17 (4.32)	.625 (15.88)
07	7	9	.4375-28 UNEF	.530 (13.46)	.244 (6.20)	.656 (16.66)	.23 (5.84)	.688 (17.48)
08	8	10	.5000-28 UNEF	.595 (15.11)	.307 (7.80)	.726 (18.44)	.30 (7.62)	.688 (17.48)
09	9	11	.5625-24 UNEF	.650 (16.51)	.307 (7.80)	.726 (18.44)	.30 (7.62)	.750 (19.05)
10	10	12	.6250-24 UNEF	.715 (18.16)	.369 (9.37)	.885 (22.48)	.36 (9.14)	.875 (22.23)
12	11/12/13	13	.6875-24 UNEF	.785 (19.94)	.432 (10.97)	.952 (24.18)	.42 (10.67)	.875 (22.23)
13	N/A	15	.750-20 UNEF	.830 (21.08)	.432 (10.97)	.952 (24.18)	.42 (10.67)	.875 (22.23)
14	14/15/16/17	18/19	.9375-20 UNEF	1.020 (25.91)	.494 (12.55)	1.018 (25.86)	.48 (12.19)	1.000 (25.40)
15	14/15/16/17	18/19	.9375-20 UNEF	1.020 (25.91)	.619 (15.72)	1.148 (29.16)	.61 (15.49)	1.000 (25.40)
16	19	21	1.0625-18 UNEF	1.155 (29.34)	.744 (18.90)	1.273 (32.33)	.73 (18.54)	1.000 (25.40)
17	21	23	1.1875-18 UNEF	1.280 (32.51)	.869 (22.07)	1.400 (35.56)	.86 (21.84)	1.125 (28.58)