

SERIES 80

Mighty Mouse Contacts and Tools



Size #23 Large-Bore Non-Removable Crimp Contacts for Size #20 to #22 AWG Wire

SIZE #23 CRIMP CONTACTS FOR AWG #20 WIRE (NON-REMOVABLE)

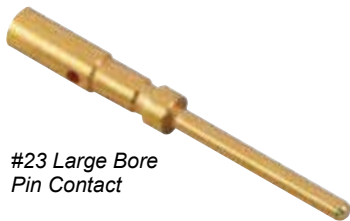

#23 Large Bore Pin Contact

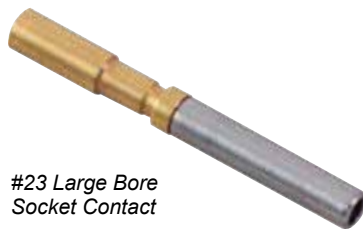

#23 Large Bore Socket Contact

Select "large-bore" version size #23 contacts for termination of size #20 to #22 AWG wire. Contacts are bulk packaged. Terminate with standard M22520 crimper with special positioner. **Note contacts are installed with standard size #23 insertion tools.**

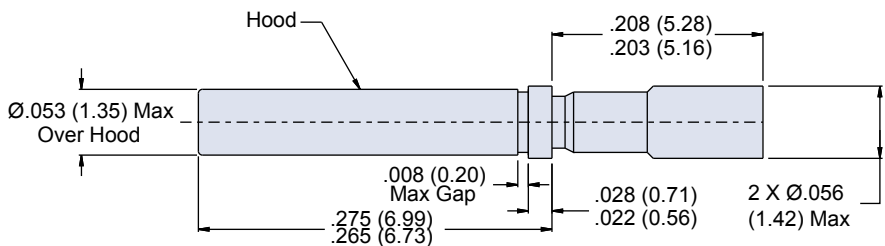
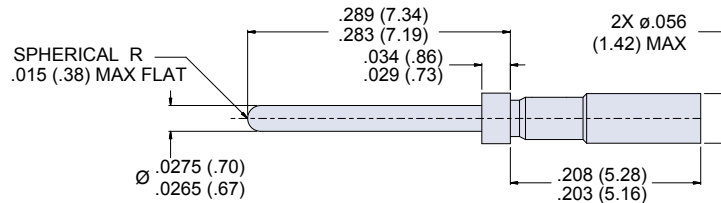

NOTES

Material

- Pin: beryllium copper per ASTM B196 or ASTM B 197
- Socket: beryllium copper per ASTM B196 or ASTM B197
- Socket hood: CRES per QQ-S-763; ASTM A240; AMS5514; etc.

Finish

- Pin and Socket: 50 microinches minimum gold plating per ASTM B488 over nickel underplate. Crimp area may have less plating.
- Socket hood: passivated per QQ-P-35

Specifications

- Current Rating: 5 Amps maximum
- Voltage Drop (at 5 Amps and 25° C): 70 millivolts maximum
- Socket contact minimum separation force: 0.5 ounces
- Socket contact maximum engagement force

Size #23 Non-Removable Crimp Contacts				
Contact Type	Wire Size	Material	Part Number	Color Band
Pin	#23 - #20	BeCu	809-299	None
Socket	#23 - #20	BeCu	809-300	None

Crimp Tensile Strength (Values are in pounds and are minimums.)	
Wire Gage	Axial Load
#20	20
#22	12

Contact Crimp and Removal Tools		
Tool	Glenair P/N	Military P/N
Hand Crimp Tool	809-015	M22520/2-01
Pin//Socket Large Bore Positioner	809-301	N/A
Contact Insertion/Removal Tool	809-088	N/A