



SERIES 80 Mighty Mouse Connectors



Size #8, 3 GHz Max Operating Frequency,
50 Ohm Coax Contacts

SIZE #8 COAXIAL CONTACTS FOR M17/152-00001, M17/113-RG316, M17/060-RG142, F M17/128-RG400, AND M17/28-RG58 CABLES



Pin Contact

Socket Contact

Dash Number	Cable Accommodation	"A" Hex	"B" Hex	Pin Part No.	Socket Part No.
-01	M17/152-00001 (RG316DS)	.128	-	852-031 no sealing boot	852-030 no sealing boot
-02	M17/113-RG316	.128	-		
-03	M17/060-RG142 M17/128-RG400	-	.218	852-031F with sealing boot	852-030F with sealing boot
-04	M17/28-RG58	-	.218		

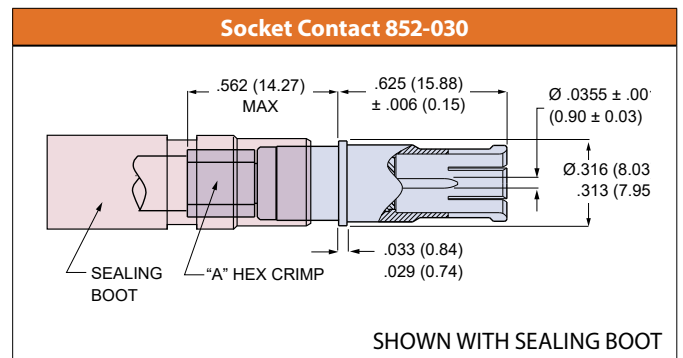
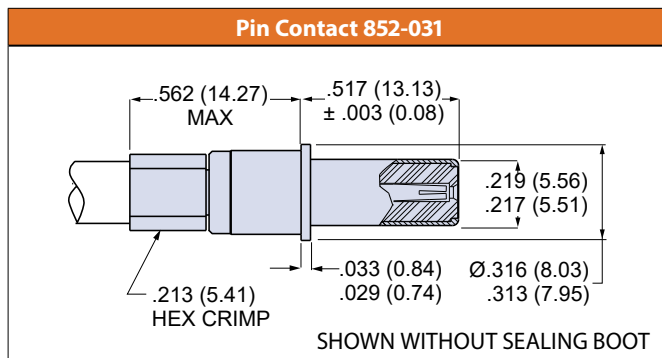

Wire Dia. (in.)	Wire Dia. (mm.)	Part Number
.090 - .130	2.3 - 3.3	859-042-01
.130 - .170	3.3 - 4.3	859-042-02
.170 - .205	4.3 - 5.2	859-042-03

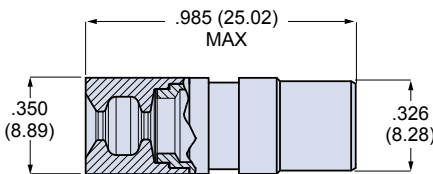

Contact Crimp and Removal Tools		
Description	Glenair P/N	Military P/N
Crimp Tool For -01, -02		
Center Contact	Solder	
Outer Shield	M22520/5-01	
Die Set	M22520/5-03	
Crimp Tool For -03		
Center Contact	Solder	
Outer Shield	M22520/5-101	
Die Set	M22520/5-45	

Sealing Boot	
Contact Part No.	Sealing Boot
852-031-01F	859-042-01
852-030-01F	859-042-01
852-031-02F	859-042-01
852-030-02F	859-042-01
852-031-03F	859-042-03
852-030-03F	859-042-03
852-031-04F	859-042-03
852-030-04F	859-042-03



SERIES 80 Mighty Mouse Connectors



Size #8, 3 GHz Max Operating Frequency, 50 Ohm Coax Contacts

SIZE #8 COAXIAL CONTACT 50 OHM CABLE

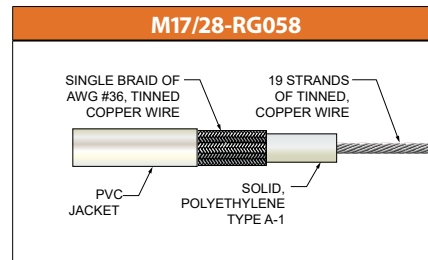
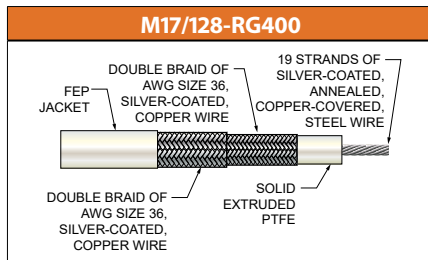
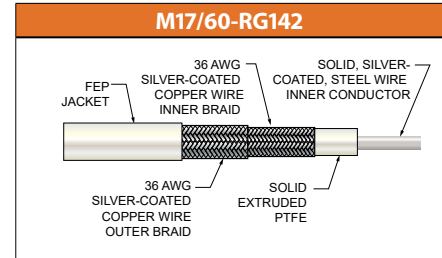
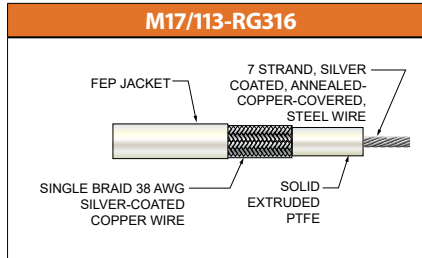
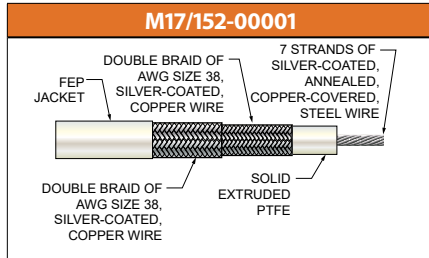

Military Part Number	M17/152-00001 (RG316DS)	M17/113-RG316	M17/060-RG142	M17/128-RG400	M17/28-RG058						
Impedance (Ohms)	50	50	50	50	50						
Velocity of Propagation %	69.5	69.5	69.5	69.5	69.5						
Capacitance (pF/ft)	32.0	32.0	29.3	32	32.2						
Conductor Wire Size	Seven Strands of Silver-Coated, Annealed Copper-Covered, Steel Wire. OD: 0.0201 ± .0010		Solid Silver-Coated, Steel Wire. OD: 0.0201 ± .0010	Solid Silver-Coated Steel Wire OD: 0.037 ± .001	19 Strands of Tinned Copper Wire OD: 0.0355 ± 0.0020						
Dielectric Core	Type F-1: Solid, Extruded PTFE	Type F-1: Solid, Extruded PTFE	Type F-1: Solid, Extruded PTFE	Type F-1: Solid, Extruded PTFE	Type A-1: Solid Polyethylene						
First Shield	38 AWG Silver-Coated Copper Wire 95.4% Nom. Coverage	38 AWG Silver-Coated Copper Wire 95.2% Nom. Coverage	36 AWG Silver-Coated Copper Wire 94.8% Nom. Coverage	36 AWG Silver-Coated Copper Wire 94.8% Nom. Coverage	Single Braid of 36 AWG Tinned Copper Wire 92.8% Nom. Coverage						
Second Shield	38 AWG Silver-Coated Copper Wire 94.6 Nom. Coverage	N/A	36 AWG Silver-Coated Copper Wire 93.1 Nom. Coverage	36 AWG Silver-Coated Copper Wire 93.6% Nom. Coverage	N/A						
Shielding Effectiveness (dB)	40 to 60 dB range acceptable for lower frequency applications										
Jacket	Type IX: FEP	Type IX: FEP	Type IX: FEP	Type IX: FEP	Type IIA: PVC						
Outer Diameter	.114 (2.90) ±.004 (.10)	.098 (2.49) ±.004 (.10)	.195 (4.95) ±.005 (0.13)	.195 (4.95) ±.005 (0.13)	.195 (4.95) ±.004 (0.10)						
Temperature Rating	-55°C to +200° C	-55°C to +200° C	-55°C to +200°C	-55°C to +200°C	-40°C to +85°C						
Weight	1.85 (lbs/100 ft.)	1.22 (lbs/ft.)	.043 (lbs/ft.)	5 (lbs/100 ft.)	.026 (lbs/ft.)						
Max. Attenuation	Freq. (MHz)		Freq. (MHz)		Freq. (MHz)		Freq. (MHz)		Freq. (MHz)		
		50	7.5	50 MHz	30	50 MHz	3.0	50 MHz	3.2	50 MHz	4.0
		500	26	100 MHz	30	100 MHz	4.4	100 MHz	4.5	100 MHz	6.5
		1,000	40	400 MHz	23	400 MHz	9.3	400 MHz	10.5	400 MHz	17.0
		3,000	75	1000 GHz	21	1000 MHz	15.3	1,000 MHz	17	1000 MHz	28.0
		10,000	170	3000 GHz	17	3000 MHz	29.3	3,000 MHz	38		
	12,400	230			8000 MHz	57.8	10,000 MHz	78			
					12400 MHz	85.4	12,400 MHz	90			

CONTACTS AND TOOLS