

Series 806

Mighty Mouse Mil-Aero Connectors

806-013 Square Flange Receptacle Connectors



Features

- Triple-start stub ACME mating thread
- High density #20HD and #22HD arrangements for reduced size and weight
- Aerospace-grade materials, construction
- Snap-in crimp contacts

Specifications

- Operating temperature:
Finishes ME, MT, Z1: -65°C to +200°C
Finishes NF, ZR: -65°C to +175°C
- Wire sizes:
#20HD contacts: 20–24 AWG
#22HD contacts: 22–28 AWG
- Dielectric withstanding voltage
#20HD layouts: 1800 Vac
#22HD layouts: 1300 Vac
- Current rating
#20HD contacts 7.5 A
#22HD contacts 5 A
- Mating durability: 500 cycles
- Mechanical shock: EIA-364-27, 300g.
- Vibration (sine): MIL-DTL-38999M, 60g.
- Vibration (random) EIA-364-28 Condition VI, Letter J, 43.92 Grms, +200°C
- High Impact shock: MIL-S-901 Grade A
- Humidity: EIA-364-31 Method 4
- Salt spray (dynamic): EIA-364-26, 500 hours (96 hours for nickel-plated versions)
- Fluid immersion: EIA-364-10
- Altitude immersion: EIA-364-03 75,000 feet altitude

Connector Construction

- Shell: aluminum or stainless steel
- Contacts: copper alloy, gold plating
- Wire grommet: blue fluorosilicone
- Dielectric inserts: high grade rigid dielectric
- Peripheral seal: blue fluorosilicone
- Contact retention clips: copper alloy
- Clinch nuts: stainless steel, passivated
- Retainer rings: stainless steel, passivated

Ultraminiature 806-013 square flange panel receptacles save size and weight compared to traditional aerospace-grade connectors. Series 806 high performance connectors are intended for use in unpressurized aircraft areas subject to vibration, moisture, and temperature extremes. Available with integral Nano Band platform or with metric accessory threads, these connectors feature snap-in, rear release contacts.

How To Order								
SAMPLE PART NUMBER →		806-013	-MT	12-26	P	B	C	A
Product	806-013 = Panel Receptacle, Square Flange, Crimp							
Shell Material and Finish	ME = Aluminum, Electroless Nickel MT = Aluminum, Ni/PTFE ZR = Aluminum, Black Zinc-Nickel NF = Aluminum, Olive Drab Cadmium Z1 = Stainless Steel, Passivated							
Arrangement Number (Shell Size - Insert Arr.)	See Table 1							
Contact Type	Connector supplied with contacts P = Pin S = Socket			Connector supplied without contacts A = Pin B = Socket				
Shell Style	M = Metric accessory threads B = Nano Band platform							
Mounting Hole Style	T = Thru holes C = Clinch nut, #4-40 (rear panel mounting)							
Polarizing Position (Table 2)	A B C D E F							

Table 1
Arrangement Number

No. of Contacts	#20HD	#22HD	Arr.	Shell Size
3	●		8-3	8
4		●	8-4	8
5	●		9-5	9
7		●	8-7	8
8	●		10-8	10
10	●		11-10	11
11		●	9-11	9
15		●	10-15	10
15	●		12-15	12
19		●	11-19	11
20	●		14-20	14
26		●	12-26	12
31	●		16-31	16
39		●	14-39	14
41	●		18-41	18
55	●		20-55	20
60		●	16-60	16
69	●		22-69	22
85		●	18-85	18
92	●		24-92	24
110		●	20-110	20
140		●	22-140	22
186		●	24-186	24

Table 2
Polarizing Positions

Position	A°	B°	C°	D°
A	105	140	215	265
B	102	170	248	305
C	80	150	230	295
D	68	140	205	275
E	64	155	234	304
F	72	120	200	298

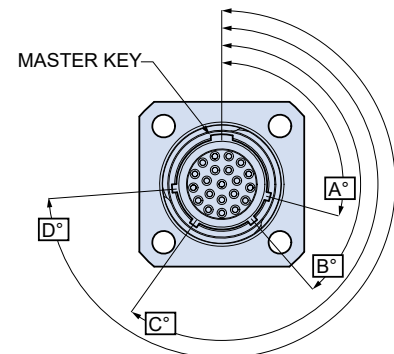

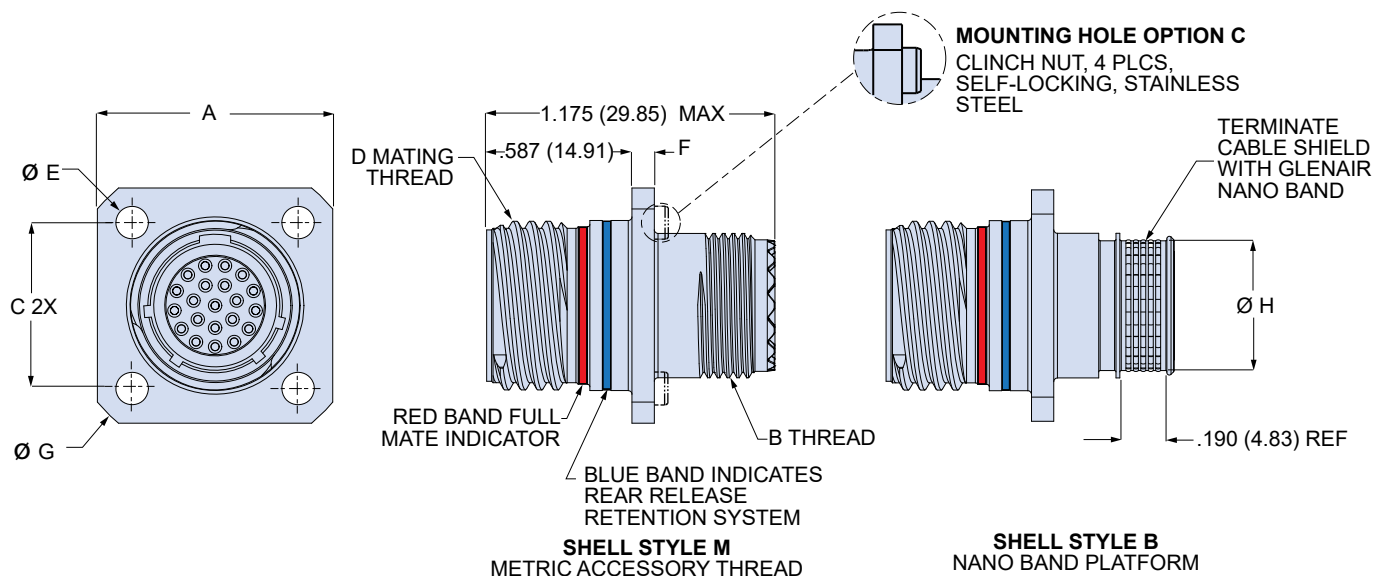

806-013 Receptacle Dimensions

Shell Size	A Max		B Thread	C		D Mating Thread		ØE		F Max		G Max		H Max	
	In.	mm.		In.	mm.	In.	mm.	In.	mm.	In.	mm.	In.	mm.	In.	mm.
8	.822	20.88	M10x1.0-6g-0.100R	.531	13.49	.5000-.067P-.2L-TS-2A	.128	3.25	.100	2.54	1.040	26.42	.330	8.38	
9	.885	22.48	M12x1.0-6g-0.100R	.594	15.09	.5625-.067P-.2L-TS-2A	.128	3.25	.100	2.54	1.130	28.70	.409	10.39	
10	.913	23.19	M14x1.0-6g-0.100R	.625	15.88	.6250-.067P-.2L-TS-2A	.128	3.25	.100	2.54	1.174	29.82	.487	12.37	
11	.944	23.98	M15x1.0-6g-0.100R	.670	17.02	.6875-.067P-.2L-TS-2A	.128	3.25	.100	2.54	1.200	30.48	.527	13.39	
12	1.040	26.42	M17x1.0-6g-0.100R	.765	19.43	.7500-.067P-.2L-TS-2A	.128	3.25	.100	2.54	1.354	34.39	.606	15.39	
14	1.133	28.78	M19x1.0-6g-0.100R	.859	21.82	.8750-.067P-.2L-TS-2A	.128	3.25	.100	2.54	1.510	38.35	.684	17.37	
16	1.227	31.17	M22x1.0-6g-0.100R	.938	23.83	1.0000-.067P-.2L-TS-2A	.128	3.25	.100	2.54	1.620	41.15	.785	19.94	
18	1.320	33.53	M25x1.0-6g-0.100R	1.016	25.81	1.1250-.067P-.2L-TS-2A	.128	3.25	.100	2.54	1.784	45.31	.899	22.83	
20	1.444	36.68	M28x1.0-6g-0.100R	1.109	28.17	1.2500-.067P-.2L-TS-2A	.154	3.91	.125	3.18	1.910	48.51	1.046	26.57	
22	1.570	39.88	M31x1.0-6g-0.100R	1.203	30.56	1.3750-.067P-.2L-TS-2A	.154	3.91	.125	3.18	2.083	52.91	1.158	29.41	
24	1.696	43.08	M34x1.0-6g-0.100R	1.312	33.32	1.5000-.067P-.2L-TS-2A	.154	3.91	.125	3.18	2.200	55.88	1.276	32.41	

806-013 Panel Cutout Dimensions

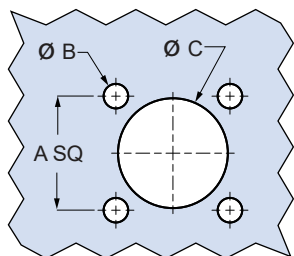

Shell Size	A		ØB with Clinch Nut		ØB without Clinch Nut		ØC	
	In.	mm.	In.	mm.	In.	mm.	In.	mm.
8	.531	13.49	.128	3.25	.128	3.25	.505	12.83
9	.594	15.09	.128	3.25	.128	3.25	.572	14.53
10	.625	15.88	.128	3.25	.128	3.25	.640	16.26
11	.670	17.02	.128	3.25	.128	3.25	.707	17.96
12	.765	19.43	.128	3.25	.128	3.25	.762	19.35
14	.859	21.82	.128	3.25	.128	3.25	.885	22.48
16	.938	23.83	.128	3.25	.128	3.25	1.010	25.65
18	1.016	25.81	.128	3.25	.128	3.25	1.120	28.45
20	1.109	28.17	.128	3.25	.154	3.91	1.270	32.26
22	1.203	30.56	.128	3.25	.154	3.91	1.395	35.43
24	1.312	33.32	.128	3.25	.154	3.91	1.520	38.61