

Recommended panel cut-outs

REFERENCE INFORMATION

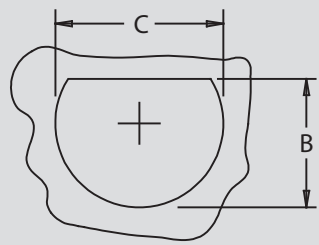
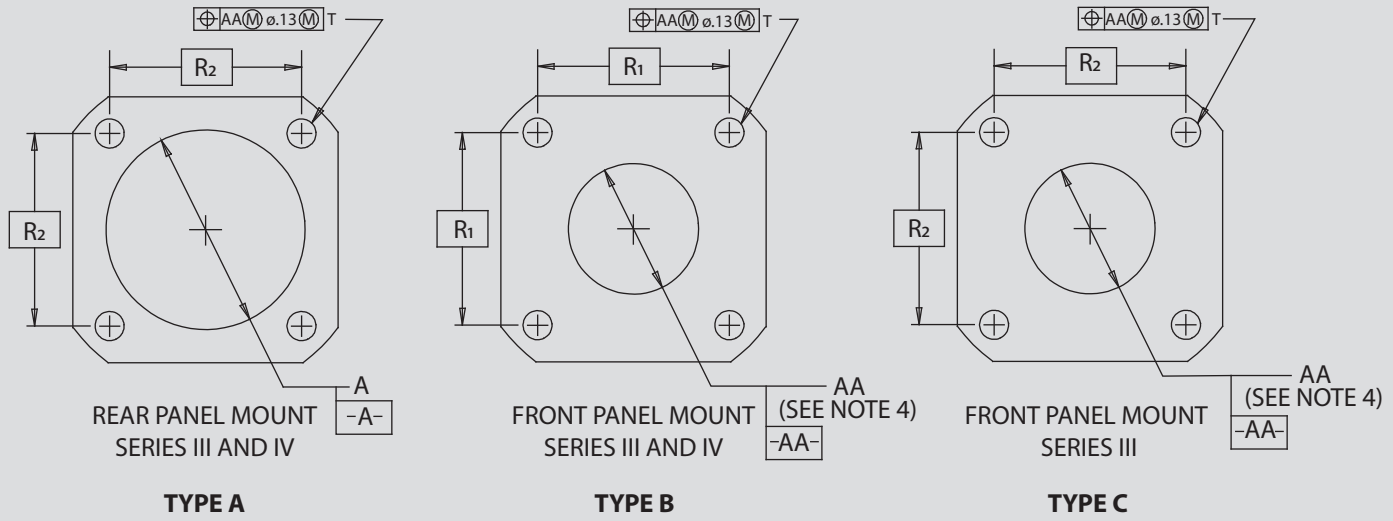

JAM NUT MOUNT, SERIES III,  
CRIMP AND HERMETIC,  
AND SERIES IV HERMETIC

**TYPE E**

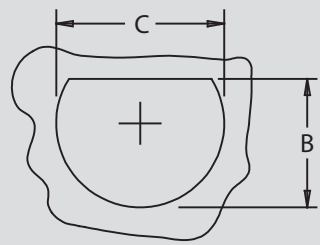

JAM NUT MOUNT,  
SERIES IV CRIMP

**TYPE F**

| Series II and IV, Recommended Panel Cut-Out Dimensions |            |               |               |                    |                   |                 |                   |                   |               |               |                  |
|--|------------|---------------|---------------|--------------------|-------------------|-----------------|-------------------|-------------------|---------------|---------------|------------------|
| Shell Size Code  | Shell Size | A Dia         | AA Dia        | B*<br>+.00<br>-.25 | C<br>+.25<br>-.00 | E<br>dia<br>min | F<br>+.00<br>-.25 | G<br>+.25<br>-.00 | R1            | R2            | T<br>dia<br>±.13 |
| A  | 8-9        | .656 (16.66)  | .516 (13.11)  | .657 (16.69)       | .693 (17.60)      | .557 (14.15)    | .830 (21.08)      | .885 (22.48)      | .719 (18.26)  | .594 (15.09)  | .128 (3.25)      |
| B  | 10-11      | .796 (20.22)  | .625 (15.88)  | .771 (19.58)       | .825 (20.96)      | .682 (17.32)    | .955 (24.26)      | 1.010 (25.65)     | .812 (20.62)  | .719 (18.26)  | .128 (3.25)      |
| C  | 12-13      | .922 (23.42)  | .750 (19.05)  | .955 (24.26)       | 1.010 (25.65)     | .854 (21.69)    | 1.085 (27.56)     | 1.135 (28.83)     | .906 (23.01)  | .812 (20.62)  | .128 (3.25)      |
| D  | 14-15      | 1.047 (26.59) | .906 (23.01)  | 1.085 (27.56)      | 1.135 (28.83)     | .979 (24.87)    | 1.210 (30.73)     | 1.260 (32.00)     | .969 (24.61)  | .906 (23.01)  | .128 (3.25)      |
| E  | 16-17      | 1.219 (30.96) | 1.016 (25.81) | 1.210 (30.73)      | 1.260 (32.00)     | 1.104 (28.04)   | 1.335 (33.91)     | 1.385 (35.18)     | 1.062 (26.97) | .969 (24.61)  | .128 (3.25)      |
| F  | 18-19      | 1.297 (32.94) | 1.141 (28.98) | 1.335 (33.91)      | 1.385 (35.18)     | 1.229 (31.22)   | 1.460 (37.08)     | 1.510 (38.35)     | 1.156 (29.36) | 1.062 (26.97) | .128 (3.25)      |
| G  | 20-21      | 1.422 (36.12) | 1.266 (32.16) | 1.460 (37.08)      | 1.510 (38.35)     | 1.354 (34.39)   | 1.585 (40.26)     | 1.635 (41.53)     | 1.250 (31.75) | 1.156 (29.36) | .128 (3.25)      |
| H  | 22-23      | 1.547 (39.29) | 1.375 (34.92) | 1.585 (40.26)      | 1.635 (41.53)     | 1.479 (37.57)   | 1.709 (43.41)     | 1.760 (44.70)     | 1.375 (34.92) | 1.250 (31.75) | .154 (3.91)      |
| J  | 24-25      | 1.672 (42.47) | 1.484 (37.69) | 1.710 (43.43)      | 1.760 (44.70)     | 1.604 (40.74)   | 1.835 (46.61)     | 1.885 (47.88)     | 1.500 (38.10) | 1.375 (34.92) | .150 (3.81)      |