

SERIES 89 NANOMINIATURE Dual-Row Rectangular Connectors

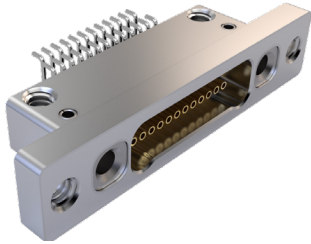

891-052 Front Panel Mount, Right-Angle Surface Mount PCB Receptacle

DUAL-ROW RECTANGULAR CONNECTORS



Front Panel Mount PCB Surface Mount Connectors offer premium performance and reliability for demanding applications. Available with female threads for board level applications.

Pre-Tinned PC Tails are coated with Sn63Pb37 or Sn60Pb40 tin-lead for excellent solderability.

Choose Aluminum, Titanium or Stainless Steel Shells in 12 layouts from 9 to 91 contacts. MIL-DTL-32139 type connectors are intermateable with any corresponding Glenair Series 891 Dual-Row metal shell nanominiature connector.

HOW TO ORDER						
Sample Part Number	891-052	-25S	A2	-BRS	T	C
Series	891-052 = Receptacle, Front Panel Mount Right-Angle PCB Surface Mount					
Insert Arrangement/ Contact Type	Sockets (891-052 Receptacle): 9S, 15S, 21S, 25S, 31S, 37S, 41S, 51S, 65S, 69S, 85S, 91S					
Shell Material and Finish	A1 = Aluminum Shell, Cadmium Plating A2 = Aluminum Shell, Electroless Nickel Plating A31 = Aluminum Shell, Zinc Nickel Plating, Black A33 = Aluminum Shell, Nickel PTFE Plating T = Titanium Shell, Unplated S = Stainless Steel Shell, Passivated					
Termination Type	BRS = Board Right-Angle Surface Mount					
Hardware	T = Female Thread (#0-80 for size 9-69, #2-56 for size 85) (Stainless Steel Inserts installed in Aluminum Shells, tapped directly into stainless steel and titanium shells)					
Mounting Hole Option	C = Thru-Hole T = Female Thread					

PANEL MOUNT CONNECTOR MOUNTING MATRIX		
Connector Holes	Panel Holes	Mounting Location
Tapped	Clearance	Rear Panel Mount
Clearance	Tapped	Front Panel Mount
Clearance	Clearance	Front or Rear Panel Mount with screw and nut

PERFORMANCE SPECIFICATIONS
Contact Spacing: .025" (0.64) contact centers
Current Rating: 1 AMP maximum tested per EIA-364-70
DWV: 250 VAC RMS sea level, 100 VAC RMS 70,000 feet per EIA-364 Procedure 20
Insulation Resistance: 5000 Megohms minimum test voltage 100 VDC, per EIA-364 Procedure 21
Operating Temperature: -55° C. to +125° C.
Contact Resistance: 71 millivolt drop maximum, 1 AMP current, any catalog supported wire type
Vibration: 20 g's, IAW EIA-364-28, Condition IV
Shock: 100 g's, IAW EIA-364-27, Condition G
Durability: 200 mating cycles per test procedure EIA-364-09
Corrosion Resistance: 48 hours salt spray IAW EIA-364-26, Condition B
Humidity: 240 hours, IAW EIA-364-31, Test Condition B
Contact Engaging/Separation Force: 5 ounce maximum, 0.4 ounce minimum
Thermal Vacuum Outgassing: Total mass loss (TML) 1.0% max., volatile condensable material (VCM) 0.1% max. IAW ASTM E595

RECEPTACLE HARDWARE	
T - Female Thread Hardware with C - Thru-Hole Mount	T - Female Thread Hardware with T - Female Thread Mount

NOTES

1. Inspect and Test IAW MIL-DTL-32139
2. Interface dimensions per MIL-DTL-32139/4
3. Panel cutout will allow for lobe up or down connector mounting.
4. Front or rear panel mounting dependent on selected mounting hole option
5. Recommended panel thickness: .100 (2.54) max

DETAIL A

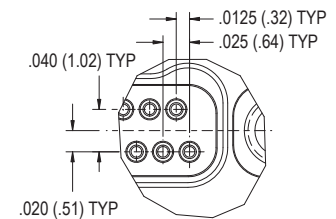

SERIES 89 NANOMINIATURE Dual-Row Rectangular Connectors



891-052 Front Panel Mount, Right-Angle Surface Mount PCB Receptacle

DIMENSIONS

891-052 Receptacle (Socket) Connectors

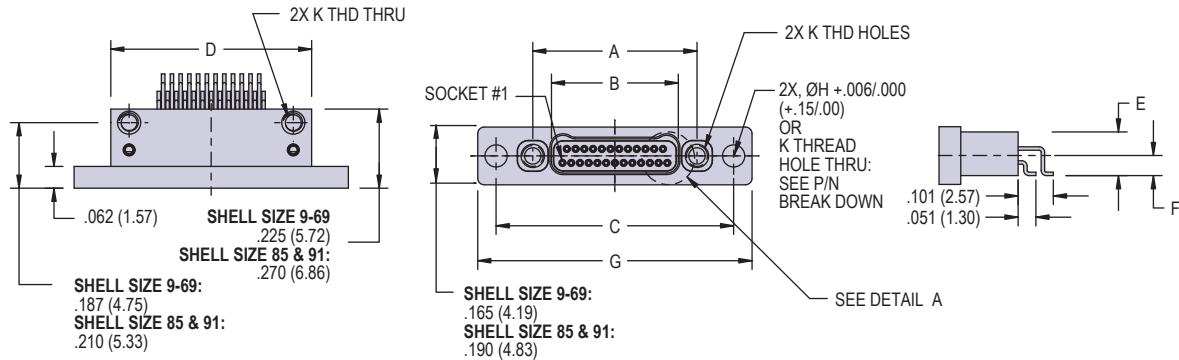

Layout	A BSC	B BSC	C BSC	D	E	F BSC	G	H	K
9S	.270 (6.86)	.163 (4.14)	.480 (12.19)	.375 (9.52)	.125 (3.18)	.0575 (1.46)	.585 (14.86)	.0635 (1.61)	#0-80 UNF-2B
15S	.345 (8.76)	.238 (6.05)	.555 (14.10)	.450 (11.43)	.125 (3.18)	.0575 (1.46)	.660 (16.76)	.0635 (1.61)	#0-80 UNF-2B
21S	.420 (10.67)	.313 (7.95)	.630 (16.00)	.525 (13.34)	.125 (3.18)	.0575 (1.46)	.735 (18.67)	.0635 (1.61)	#0-80 UNF-2B
25S	.470 (11.94)	.363 (9.22)	.680 (17.27)	.575 (14.60)	.125 (3.18)	.0575 (1.46)	.785 (19.94)	.0635 (1.61)	#0-80 UNF-2B
31S	.545 (13.84)	.438 (11.13)	.755 (19.18)	.650 (16.51)	.125 (3.18)	.0575 (1.46)	.860 (21.84)	.0635 (1.61)	#0-80 UNF-2B
37S	.620 (15.75)	.513 (13.03)	.830 (21.08)	.725 (18.42)	.125 (3.18)	.0575 (1.46)	.935 (23.75)	.0635 (1.61)	#0-80 UNF-2B
41S	.670 (17.02)	.563 (14.30)	.880 (22.35)	.775 (19.68)	.125 (3.18)	.0575 (1.46)	.985 (25.02)	.0635 (1.61)	#0-80 UNF-2B
51S	.795 (20.19)	.688 (17.48)	1.005 (25.53)	.900 (22.86)	.125 (3.18)	.0575 (1.46)	1.110 (28.19)	.0635 (1.61)	#0-80 UNF-2B
65S	.970 (24.64)	.863 (21.92)	1.180 (29.97)	1.075 (27.30)	.125 (3.18)	.0575 (1.46)	1.285 (32.64)	.0635 (1.61)	#0-80 UNF-2B
69S	1.020 (25.91)	.913 (23.19)	1.230 (31.24)	1.125 (28.58)	.125 (3.18)	.0575 (1.46)	1.335 (33.91)	.0635 (1.61)	#0-80 UNF-2B
85S	1.246 (31.65)	1.113 (28.27)	1.527 (38.79)	1.377 (34.98)	.150 (3.81)	.0700 (1.78)	1.677 (42.60)	.0890 (2.26)	#2-56 UNC-2B
91S	1.321 (33.55)	1.188 (30.18)	1.602 (40.69)	1.452 (36.88)	.150 (3.81)	.0700 (1.78)	1.752 (44.50)	.0890 (2.26)	#2-56 UNC-28

DUAL-ROW RECTANGULAR CONNECTORS

PANEL CUT-OUT DIMENSIONS

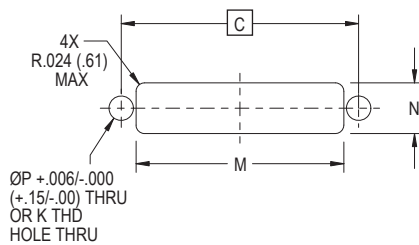

Shell Size	C	K	M	N	P
9	.480 (12.19)	#0-80 UNF-2B	.395 (10.03)	.145 (3.68)	.070 (1.78)
15	.555 (14.10)	#0-80 UNF-2B	.470 (11.94)		
21	.630 (16.00)	#0-80 UNF-2B	.545 (13.84)		
25	.680 (17.27)	#0-80 UNF-2B	.595 (15.11)		
31	.755 (19.18)	#0-80 UNF-2B	.670 (17.02)		
37	.830 (21.08)	#0-80 UNF-2B	.745 (18.92)		
41	.880 (22.35)	#0-80 UNF-2B	.795 (20.19)		
51	1.005 (25.53)	#0-80 UNF-2B	.920 (23.37)		
65	1.180 (29.97)	#0-80 UNF-2B	1.095 (27.81)		
69	1.230 (31.24)	#0-80 UNF-2B	1.145 (29.08)		
85	1.527 (38.79)	#2-56 UNC-2B	1.397 (35.48)	.170 (4.32)	.096 (2.44)
91	1.602 (40.69)	#2-56 UNC-2B	1.472 (37.39)		

SERIES 89 NANOMINIATURE Dual-Row Rectangular Connectors



891-052 Front Panel Mount, Right-Angle Surface Mount PCB Receptacle - PCB Pad Footprint

DUAL-ROW RECTANGULAR CONNECTORS

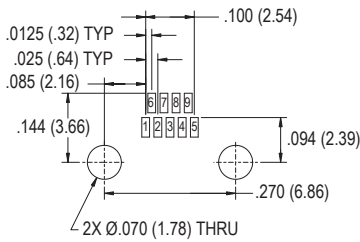
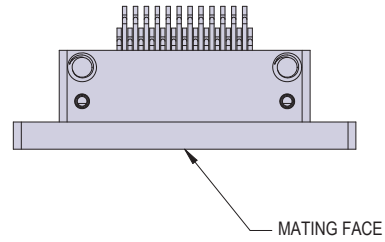
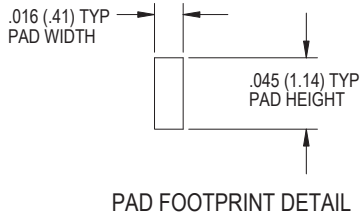

9 Contacts

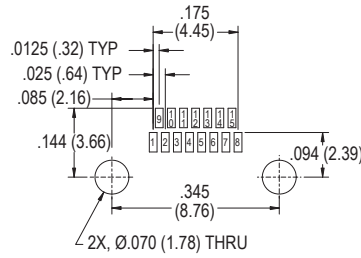

15 Contacts

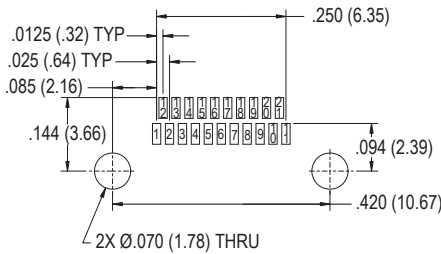

21 Contacts

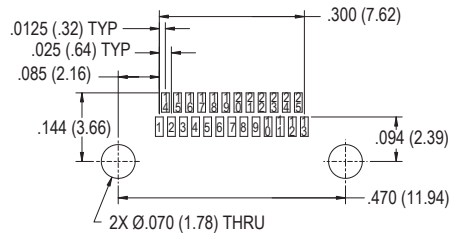

25 Contacts

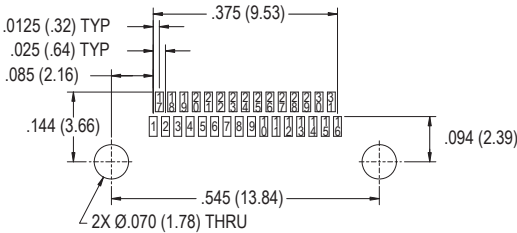

31 Contacts

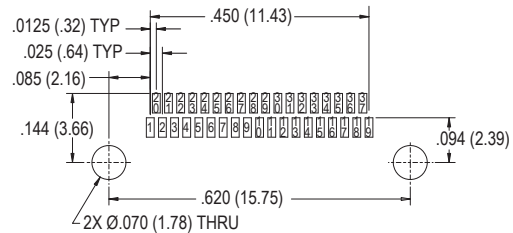

37 Contacts

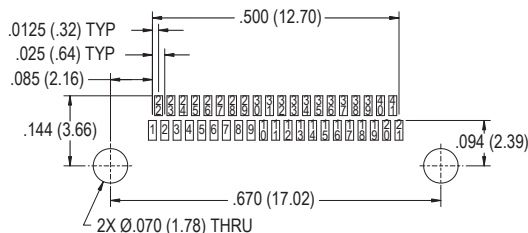

41 Contacts

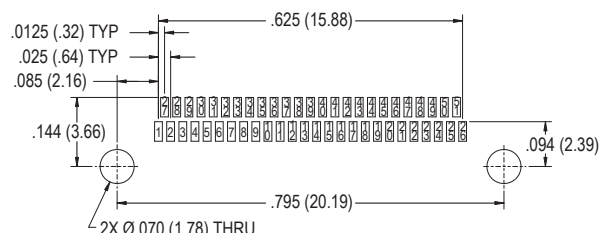

51 Contacts

Layouts shown are for connector mounting side of PC Board.

SERIES 89 NANOMINIATURE Dual-Row Rectangular Connectors



891-052 Front Panel Mount, Right-Angle Surface Mount PCB Receptacle - PCB Pad Footprint

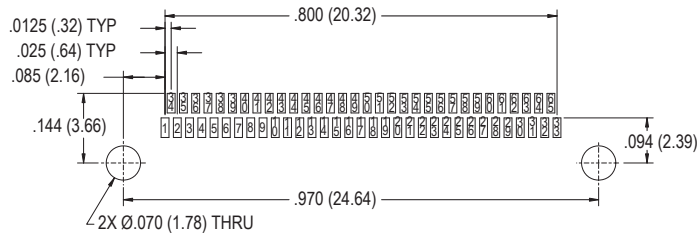
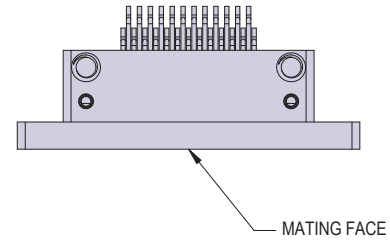
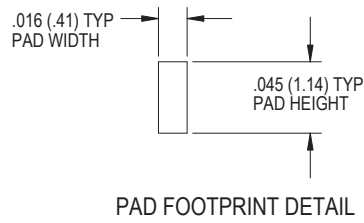

65 Contacts

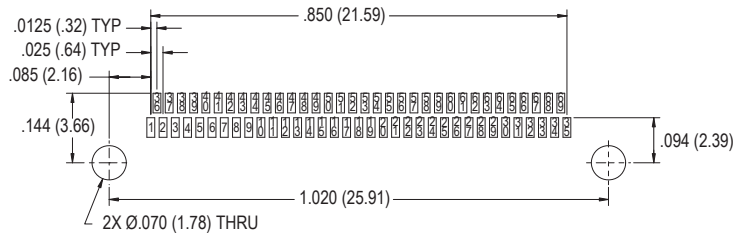

69 Contacts

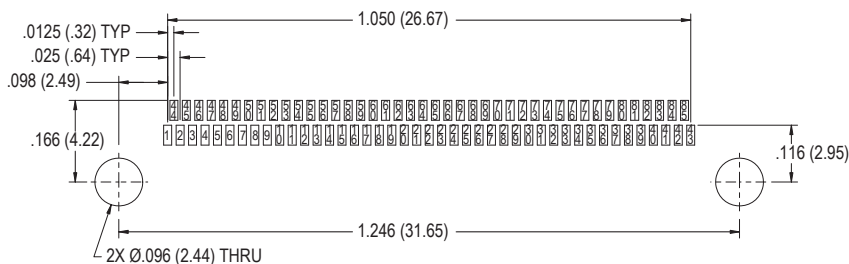

85 Contacts

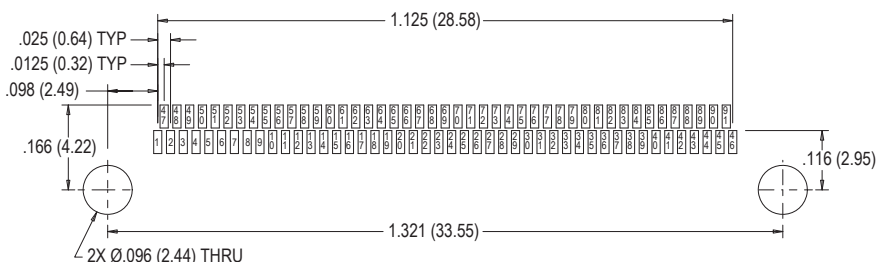

91 Contacts

Layouts shown are for connector mounting side of PC Board.