

**Rear Panel Mount Right Angle Thru Hole Connectors** feature gold alloy TwistPin contacts, offering premium performance and reliability for demanding applications. Available with female threads.

**Gasket Seals** fluorosilicone, Cho-Seal 1298 and Cho-Seal 6503 available. For replacement gaskets see 899-015.

**Choose Titanium or Stainless Steel Shells** in eleven layouts from 9 to 85 contacts. Intermateable with any MIL-DTL-32139 type connector or corresponding Glenair Series 891 Dual row metal shell nanominiature connector.

**Pre-Tinned PC Tails** are coated with Sn63Pb37 or Sn60Pb40 tin-lead for excellent solderability.

How to Order	
<b>Sample Part Number</b>	891-027 -25P S -BRT 1 T -01 M
<b>Series</b>	891-027 Rear Panel Mount Plug, Right Angle Thru Hole 891-028 Rear Panel Mount Receptacle, Right Angle Thru Hole
<b>Insert Arrangement/ Contact Type</b>	Pins (891-027 Plugs): <b>9P, 15P, 21P, 25P, 31P, 37P, 41P, 51P, 65P, 69P, 85P</b> Sockets (891-028 Receptacles): <b>9S, 15S, 21S, 25S, 31S, 37S, 41S, 51S, 65S, 69S, 85S</b>
<b>Shell Material and Finish</b>	<b>T</b> - Titanium Shell, Unplated <b>S</b> - Stainless Steel Shell, Passivated
<b>Termination Type</b>	<b>BRT</b> - Board Right Angle Thru Hole
<b>PC Tail Length</b>	<b>1</b> - .110 (2.79) <b>2</b> - .172 (4.37) <b>3</b> - .140 (3.56)
<b>Hardware Option</b>	<b>T</b> - Female Threads (#0-80 for size 9-69, #2-56 for size 85)
<b>Gasket Material</b>	<b>Omit</b> for No Gasket <b>01</b> - Fluorosilicone IAW MIL-DTL25988 Type II, Class I, Grade 70 <b>02</b> - Passivated Silver Plated Aluminum Filled Fluorosilicone IAW MIL-DTL-83528, Type D (Cho-Seal 1298 or Equivalent) <b>03</b> - Nickel Plated Aluminum Filled Fluorosilicone, (Cho-Seal 6503 or Equivalent)
<b>Mounting Thread Option</b>	<b>Omit</b> for #2-56 UNC-2B <b>M</b> - M2X0.4 6H

D

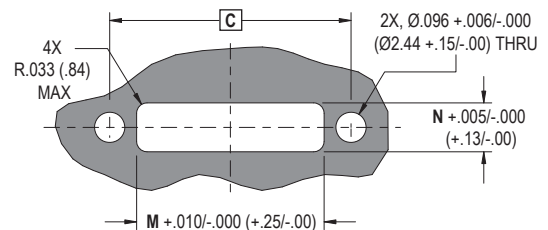
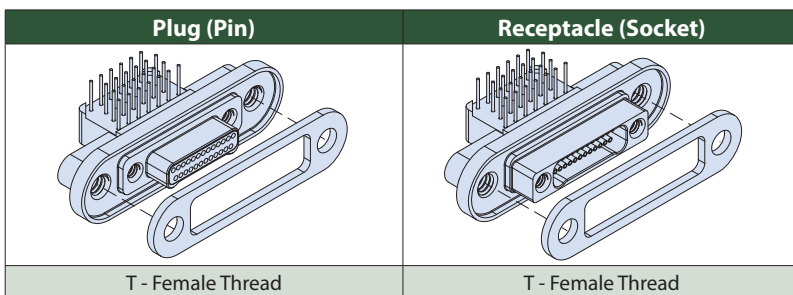

### NOTES

- Material and Finish:
  - Shell: see part number break down
  - Insulator: LCP/N/A
  - Contacts: gold alloy / unplated
  - Pre-tinned PC tails: Coated with Sn63Pb37 or Sn60Pb40 tin-lead
- Inspect and test IAW MIL-DTL-32139
- Interface dimensions per MIL-DTL-32139/3 and /4

### DETAIL A

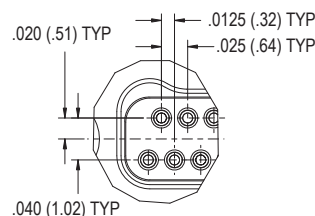

### Panel Cut-out Dimensions

Shell Size	C	M	N
9	.566 (14.38)	.395 (10.03)	.155 (3.93)
15	.641 (16.28)	.470 (11.94)	.155 (3.93)
21	.716 (18.19)	.545 (13.84)	.155 (3.93)
25	.766 (19.46)	.595 (15.11)	.155 (3.93)
31	.841 (21.36)	.670 (17.02)	.155 (3.93)
37	.916 (23.27)	.745 (18.92)	.155 (3.93)
41	.966 (24.54)	.795 (20.19)	.155 (3.93)
51	1.091 (27.71)	.920 (23.37)	.155 (3.93)
65	1.266 (32.16)	1.095 (27.81)	.155 (3.93)
69	1.316 (33.43)	1.145 (29.08)	.155 (3.93)
85	1.568 (39.83)	1.397 (34.48)	.180 (4.57)

**Dimensions**

**891-027 Plug (Pin) Connectors**

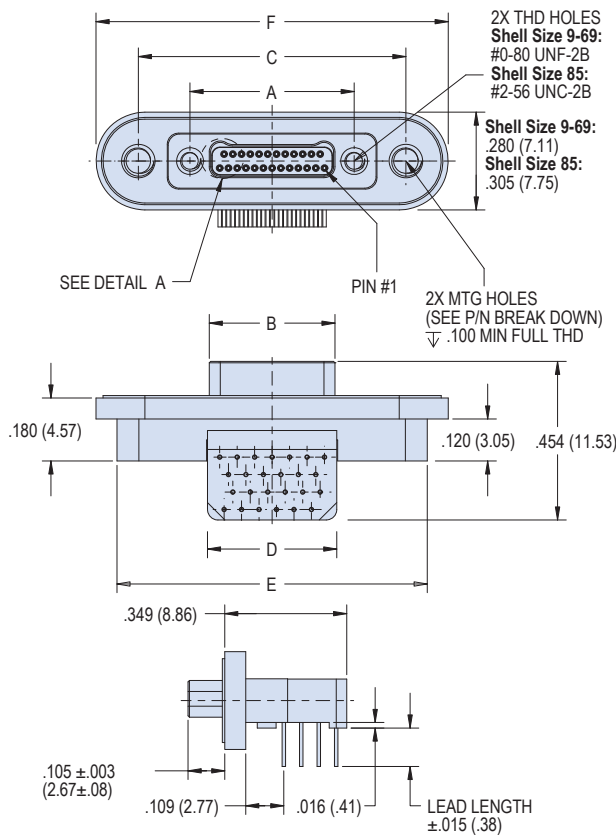

**891-028 Receptacle (Socket) Connectors**

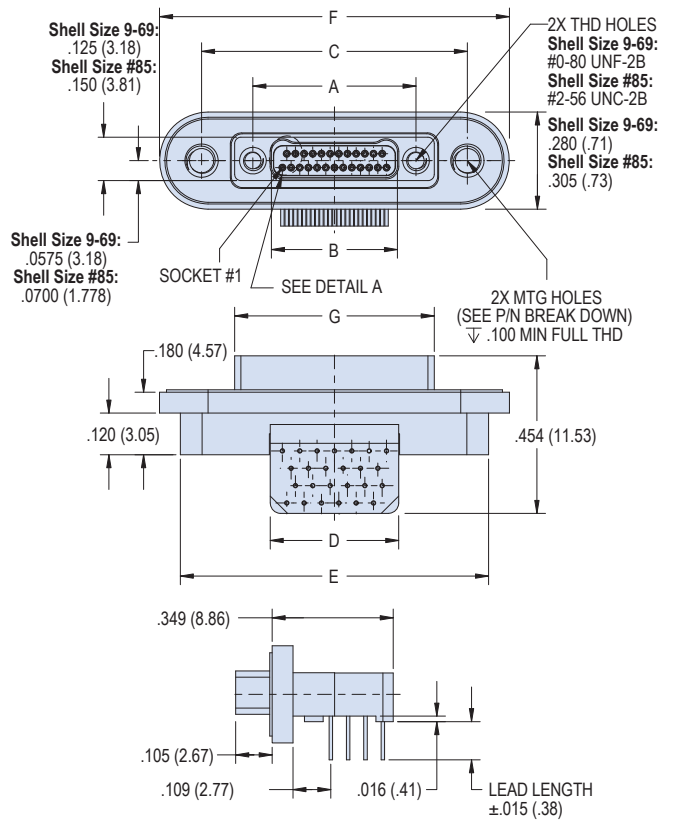

Layout	A BSC		B BSC.		C BSC.		D		E		F		G	
9P	.270	6.86	.160	4.06	.566	14.38	.170	4.32	.688	17.48	.808	20.52	--	--
9S	.270	6.86	.163	4.14	.566	14.38	.170	4.32	.688	17.48	.808	20.52	.375	9.53
15P	.345	8.76	.235	5.97	.641	16.28	.245	6.22	.763	19.38	.883	22.43	--	--
15S	.345	8.76	.238	6.05	.641	16.28	.245	6.22	.763	19.38	.883	22.43	.450	11.43
21P	.420	10.67	.310	7.87	.716	18.19	.320	8.13	.838	21.29	.958	24.33	--	--
21S	.420	10.67	.313	7.95	.716	18.19	.320	8.13	.838	21.29	.958	24.33	.525	13.34
25P	.470	11.94	.360	9.14	.766	19.46	.370	9.40	.888	22.56	1.008	25.60	--	--
25S	.470	11.94	.363	9.22	.766	19.46	.370	9.40	.888	22.56	1.008	25.60	.575	14.61
31P	.545	13.84	.435	11.05	.841	21.36	.445	11.30	.963	24.46	1.083	27.51	--	--
31S	.545	13.84	.438	11.13	.841	21.36	.445	11.30	.963	24.46	1.083	27.51	.650	16.51
37P	.620	15.75	.510	12.95	.916	23.27	.520	13.21	1.038	26.37	1.158	29.41	--	--
37S	.620	15.75	.513	13.03	.916	23.27	.520	13.21	1.038	26.37	1.158	29.41	.725	18.42
41P	.670	17.02	.560	14.22	.966	24.54	.570	14.48	1.088	27.64	1.208	30.68	--	--
41S	.670	17.02	.563	14.30	.966	24.54	.570	14.48	1.088	27.64	1.208	30.68	.775	19.69
51P	.795	20.19	.685	17.40	1.091	27.71	.695	17.65	1.213	30.81	1.333	33.86	--	--
51S	.795	20.19	.688	17.48	1.091	27.71	.695	17.65	1.213	30.81	1.333	33.86	.900	22.86
65P	.970	24.64	.860	21.84	1.266	32.16	.870	22.10	1.388	35.26	1.508	38.30	--	--
65S	.970	24.64	.863	21.92	1.266	32.16	.870	22.10	1.388	35.26	1.508	38.30	1.075	27.31
69P	1.020	25.91	.910	23.11	1.316	33.43	.920	23.37	1.438	36.53	1.558	39.57	--	--
69S	1.020	25.91	.913	23.19	1.316	33.43	.920	23.37	1.438	36.53	1.558	39.57	1.125	28.58
85P	1.246	31.65	1.110	28.19	1.568	39.83	1.120	28.45	1.690	42.93	1.810	45.97	--	--
85S	1.246	31.65	1.113	28.27	1.568	39.83	1.120	28.45	1.690	42.93	1.810	45.97	1.377	34.98



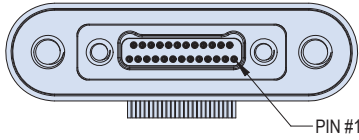

Right angle plug (pin) connector layout patterns shown are for the connector mounting side of PC board

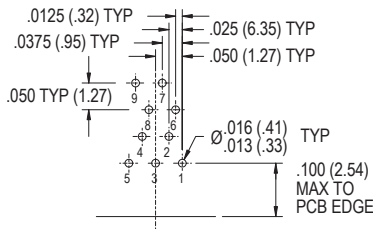
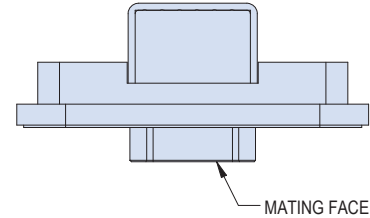

**9 Contacts**

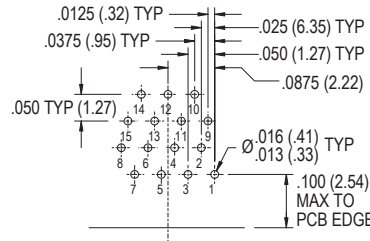

**15 Contacts**

D

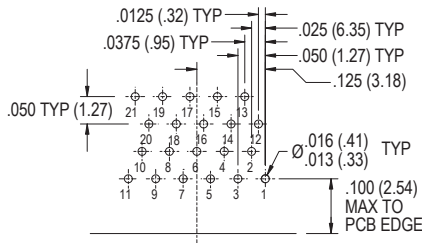

**21 Contacts**

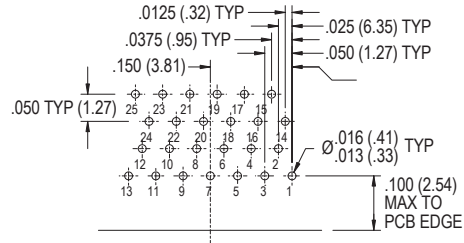

**25 Contacts**

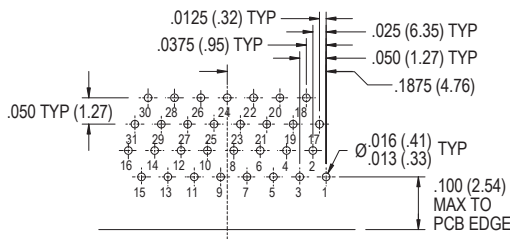

**31 Contacts**

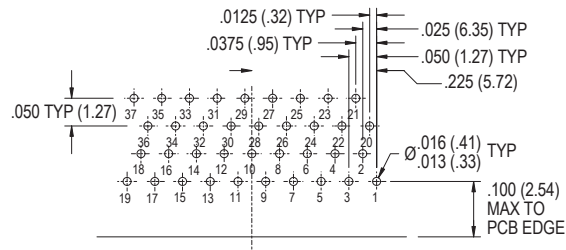

**37 Contacts**

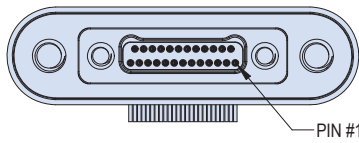

Right angle plug (pin) connector layout patterns shown are for the connector mounting side of PC board

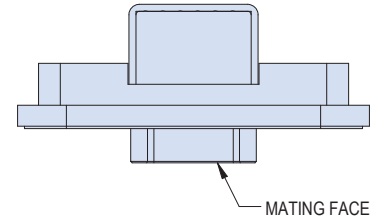

MATING FACE

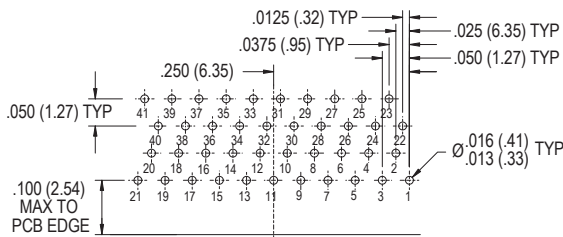

**41 Contacts**

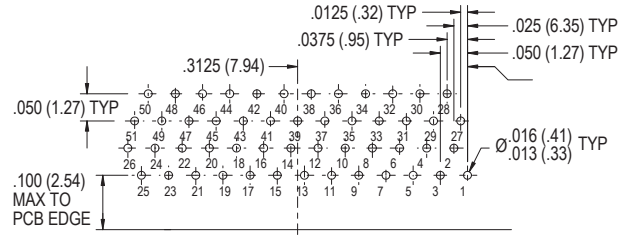

**51 Contacts**

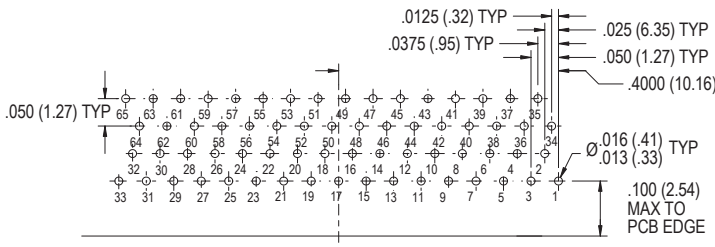

**65 Contacts**

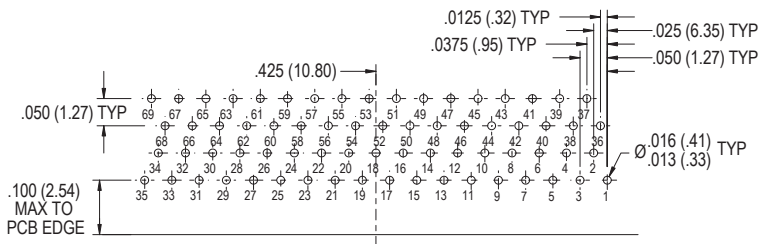

**69 Contacts**

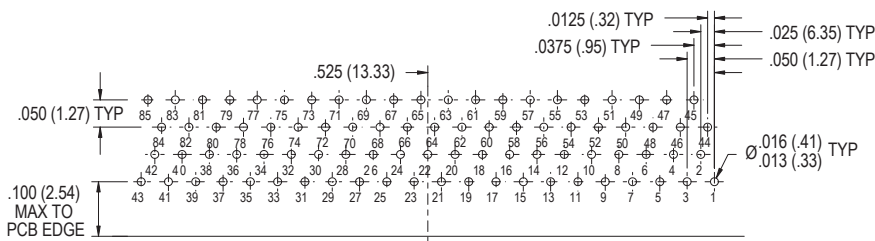

**85 Contacts**



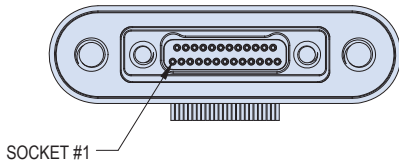

Right angle receptacle (socket)  
connector layout patterns shown are  
for the connector mounting side of PC  
board

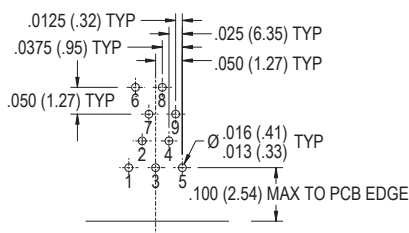
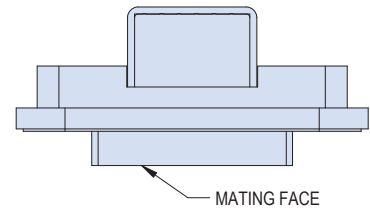

**9 Contacts**

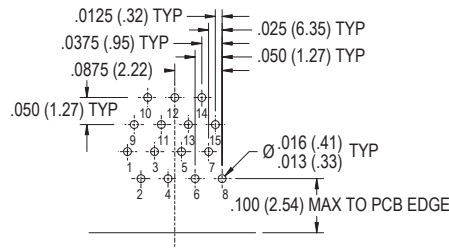

**15 Contacts**

**D**

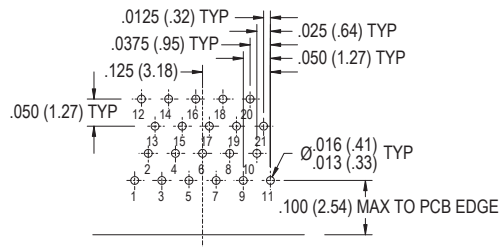

**21 Contacts**

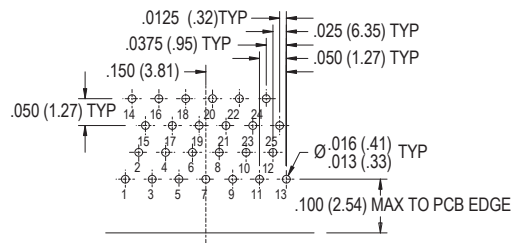

**25 Contacts**

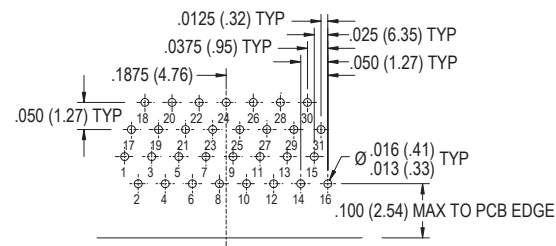

**31 Contacts**

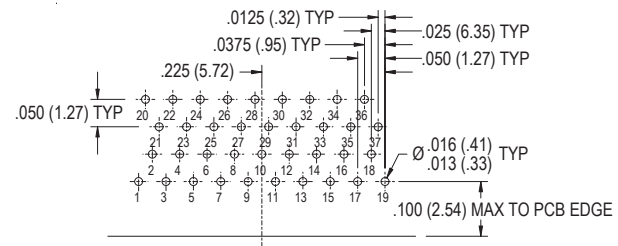

**37 Contacts**

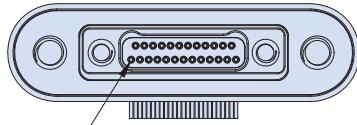

SOCKET #1

Right angle receptacle (socket)  
connector layout patterns shown are  
for the connector mounting side of PC  
board

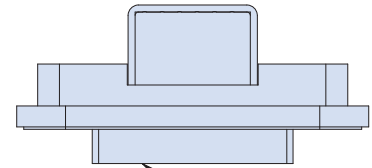

MATING FACE

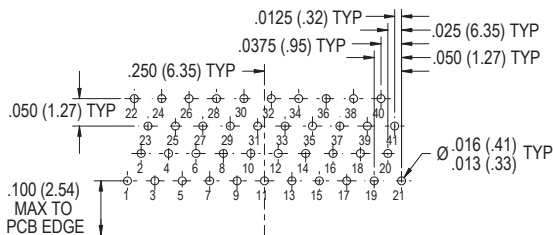

**41 Contacts**

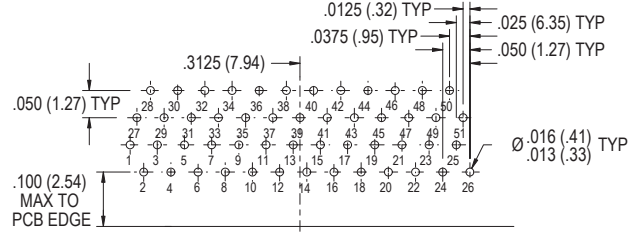

**51 Contacts**

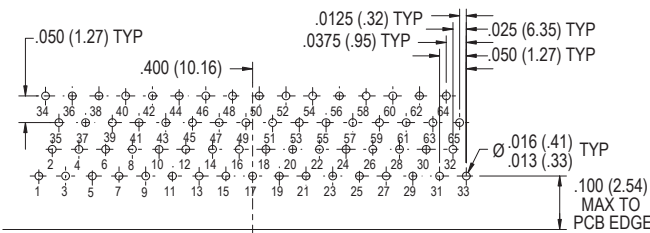

**65 Contacts**

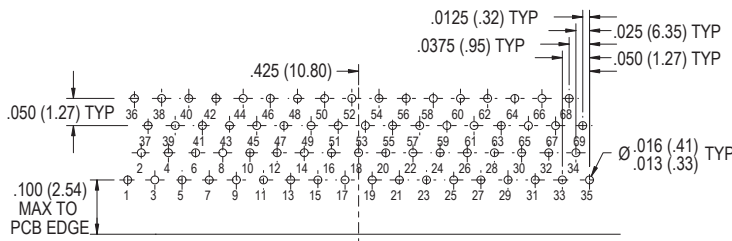

**69 Contacts**

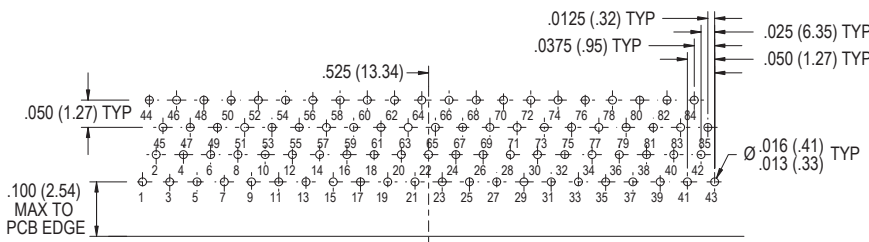

**85 Contacts**

