

Rear Panel Mount, Straddle Mount Connector and Gasket Seal - How to Order

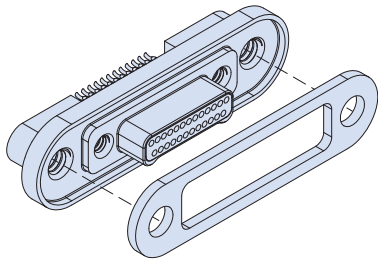

Rear Panel Mount, Straddle Mount PCB Connectors feature gold alloy TwistPin contacts, offering premium performance and reliability for demanding applications. Available with female threads for use with flexible circuits.

Pre-Tinned PC Tails are coated with Sn63Pb37 or Sn60Pb40 tin-lead for excellent solderability.

Choose Titanium or Stainless Steel Shells in eleven layouts from 9 to 85 contacts. MIL-DTL-32139 type connectors are intermateable with any corresponding Glenair Series 891 Dual row metal shell nanominiature connector.

Gasket Seals fluorosilicone, Cho-Seal 1298 and Cho-Seal 6503 available. For replacement gaskets see 899-015.

How to Order	
Sample Part Number	891-035 -25P S -STM T -01 M
Series	891-035 Plug, Straddle Mount Connector 891-036 Receptacle, Straddle Mount Connector
Insert Arrangement/Contact Type	Pins (891-035 Plug): 9P, 15P, 21P, 25P, 31P, 37P, 41P, 51P, 65P, 69P, 85P Sockets (891-036 Receptacle): 9S, 15S, 21S, 25S, 31S, 37S, 41S, 51S, 65S, 69S, 85S
Shell Material and Finish	T - Titanium Shell, Unplated S - Stainless Steel Shell, Passivated
Termination Type	STM - Straddle Mount
Hardware	T - Female Thread (#0-80 for size 9-69, #2-56 for size 85)
Gasket Material	Omit for No Gasket 01 - Fluorosilicone IAW MIL-DTL25988 Type II, Class I, Grade 70 02 - Passivated Silver Plated Aluminum Filled Fluorosilicone IAW MIL-DTL-83528 03 - Nickel Plated Aluminum Filled Fluorosilicone, (Cho-Seal 6503 or Equivalent)
Mounting Thread Option	Omit for #2-56 UNC-2B M - M2X0.4 6H

D

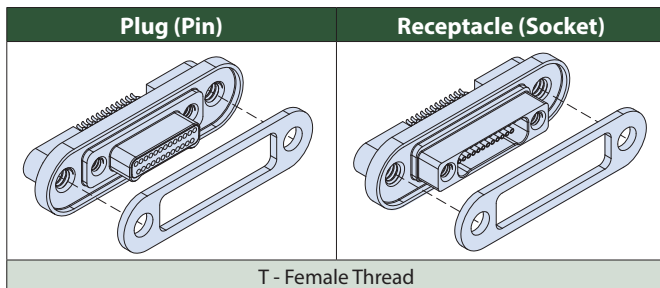

Panel Cut-out Dimensions			
Shell Size	C	M	N
9	.566 (14.38)	.395 (10.03)	.155 (3.93)
15	.641 (16.28)	.470 (11.94)	.155 (3.93)
21	.716 (18.19)	.545 (13.84)	.155 (3.93)
25	.766 (19.46)	.595 (15.11)	.155 (3.93)
31	.841 (21.36)	.670 (17.02)	.155 (3.93)
37	.916 (23.27)	.745 (18.92)	.155 (3.93)
41	.966 (24.54)	.795 (20.19)	.155 (3.93)
51	1.091 (27.71)	.920 (23.37)	.155 (3.93)
65	1.266 (32.16)	1.095 (27.81)	.155 (3.93)
69	1.316 (33.43)	1.145 (29.08)	.155 (3.93)
85	1.568 (39.83)	1.397 (34.48)	.180 (4.57)

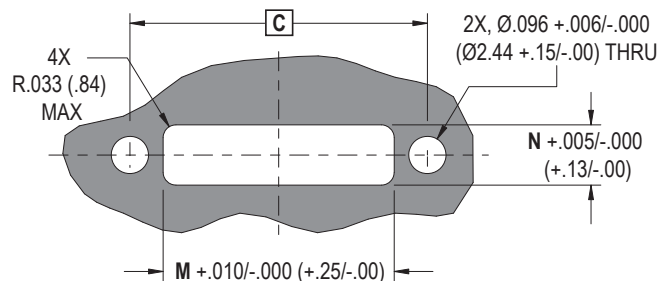

DETAIL A

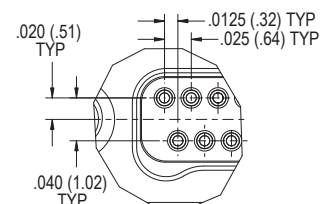

- Panel cutout is sized to allow connector mounting with either lobe up or down orientation.
- Recommended panel thickness .100 (2.54)

Dimensions

891-035 Plug (Pin) Connectors

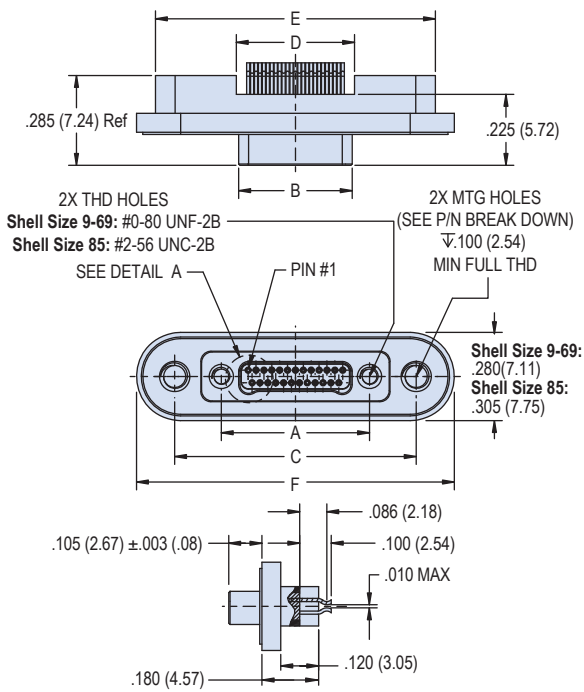

891-036 Receptacle (Socket) Connectors

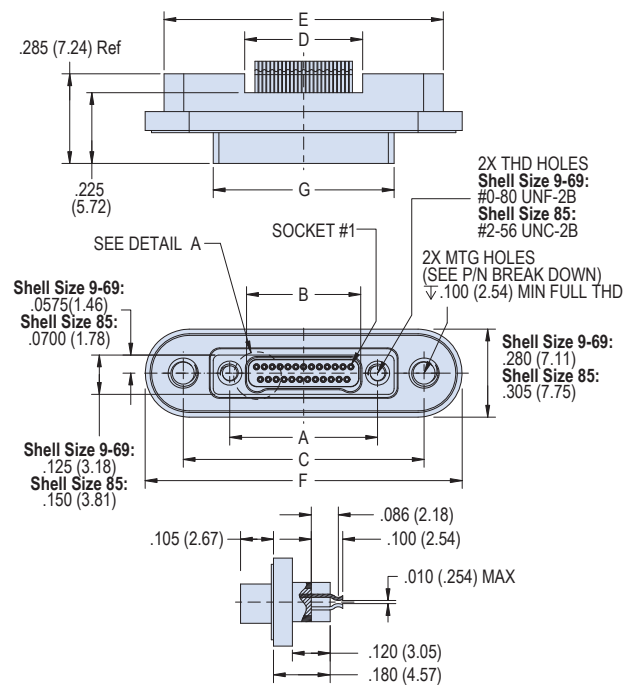

Layout	A BSC.		B BSC.		C BSC.		D		E		F		G	
	In	mm	In	mm	In	mm	In	mm	In	mm	In	mm	In	mm
9P	.270	6.86	.160	4.06	.566	14.38	.175	4.45	.688	17.48	.808	20.52	--	--
9S	.270	6.86	.163	4.14	.566	14.38	.175	4.45	.688	17.48	.808	20.52	.375	9.53
15P	.345	8.76	.235	5.97	.641	16.28	.250	6.35	.763	19.38	.883	22.43	--	--
15S	.345	8.76	.238	6.05	.641	16.28	.250	6.35	.763	19.38	.883	22.43	.450	11.43
21P	.420	10.67	.310	7.87	.716	18.19	.325	8.26	.838	21.29	.958	24.33	--	--
21S	.420	10.67	.313	7.95	.716	18.19	.325	8.26	.838	21.29	.958	24.33	.525	13.34
25P	.470	11.94	.360	9.14	.766	19.46	.375	9.53	.888	22.56	1.008	25.60	--	--
25S	.470	11.94	.363	9.22	.766	19.46	.375	9.53	.888	22.56	1.008	25.60	.575	14.61
31P	.545	13.84	.435	11.05	.841	21.36	.450	11.43	.963	24.46	1.083	27.51	--	--
31S	.545	13.84	.438	11.13	.841	21.36	.450	11.43	.963	24.46	1.083	27.51	.650	16.51
37P	.620	15.75	.510	12.95	.916	23.27	.525	13.34	1.038	26.37	1.158	29.41	--	--
37S	.620	15.75	.513	13.03	.916	23.27	.525	13.34	1.038	26.37	1.158	29.41	.725	18.42
41P	.670	17.02	.560	14.22	.966	24.54	.575	14.61	1.088	27.64	1.208	30.68	--	--
41S	.670	17.02	.563	14.30	.966	24.54	.575	14.61	1.088	27.64	1.208	30.68	.775	19.69
51P	.795	20.19	.685	17.40	1.091	27.71	.700	17.78	1.213	30.81	1.333	33.86	--	--
51S	.795	20.19	.688	17.48	1.091	27.71	.700	17.78	1.213	30.81	1.333	33.86	.900	22.86
65P	.970	24.64	.860	21.84	1.266	32.16	.875	22.23	1.388	35.26	1.508	38.30	--	--
65S	.970	24.64	.863	21.92	1.266	32.16	.875	22.23	1.388	35.26	1.508	38.30	1.075	27.31
69P	1.020	25.91	.910	23.11	1.316	33.43	.925	23.50	1.438	36.53	1.558	39.57	--	--
69S	1.020	25.91	.913	23.19	1.316	33.43	.925	23.50	1.438	36.53	1.558	39.57	1.125	28.58
85P	1.246	31.65	1.110	28.19	1.568	39.83	1.125	28.58	1.690	42.93	1.810	45.97	--	--
85S	1.246	31.65	1.113	28.27	1.568	39.83	1.125	28.58	1.690	42.93	1.810	45.97	1.377	34.98

D

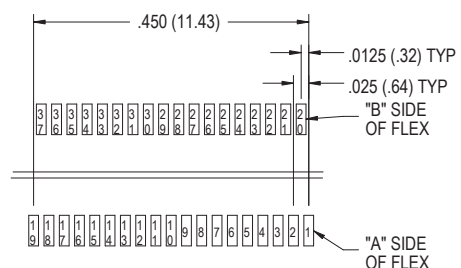
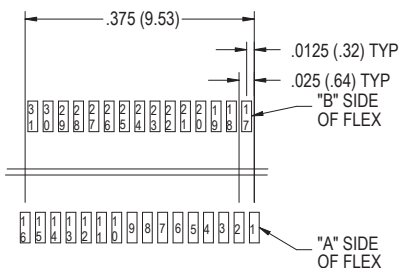
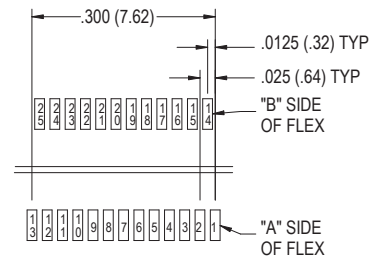
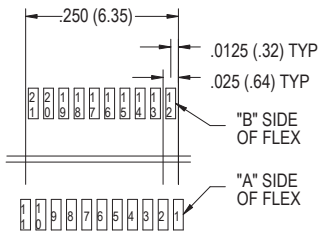
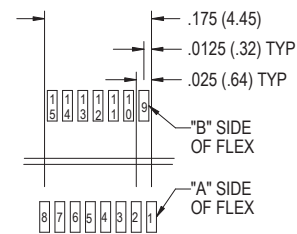
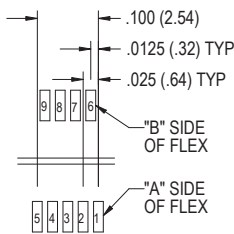
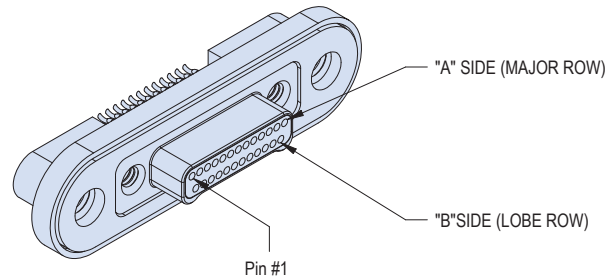
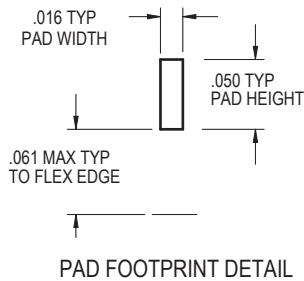

D

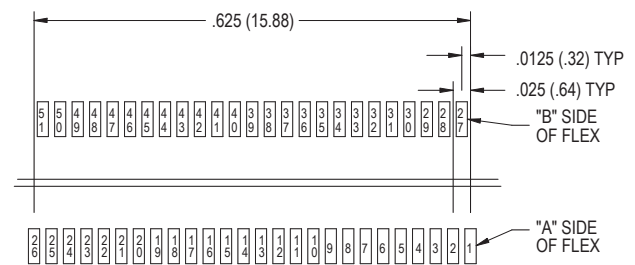
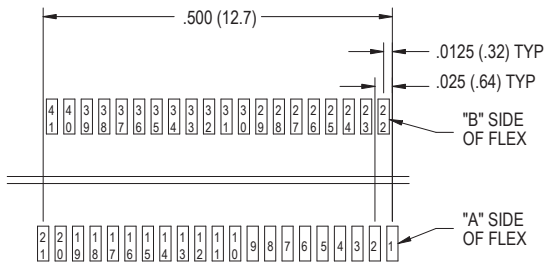
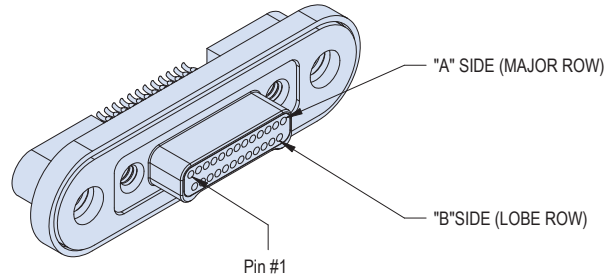
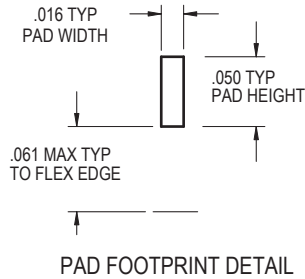

41 Contacts

51 Contacts

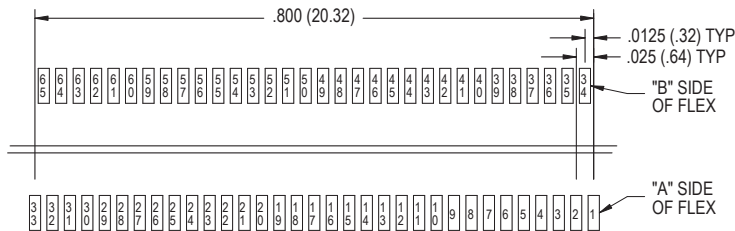

65 Contacts

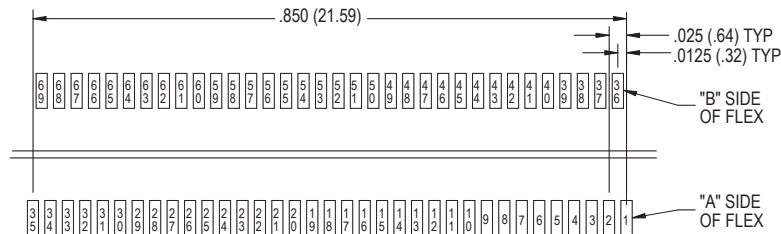

69 Contacts

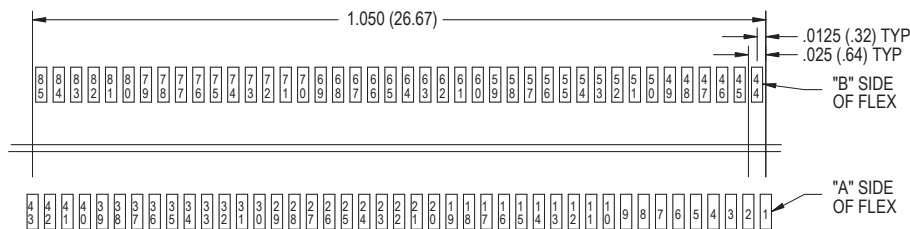

85 Contacts



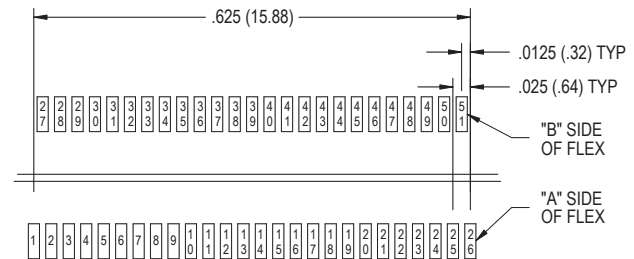
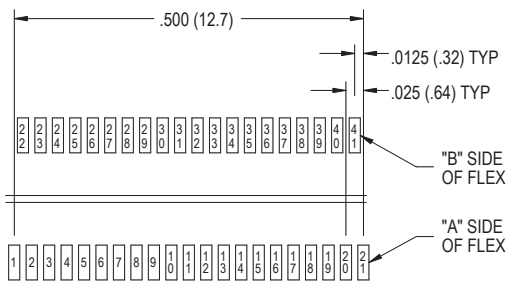
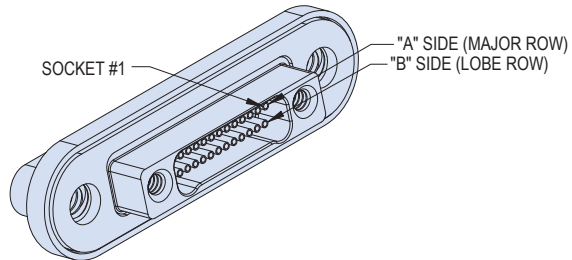
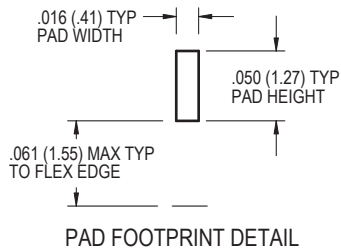

41 Contacts

51 Contacts

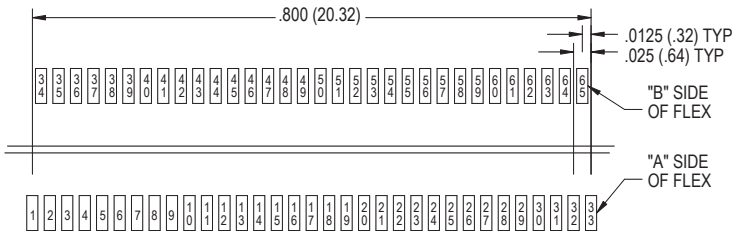

65 Contacts

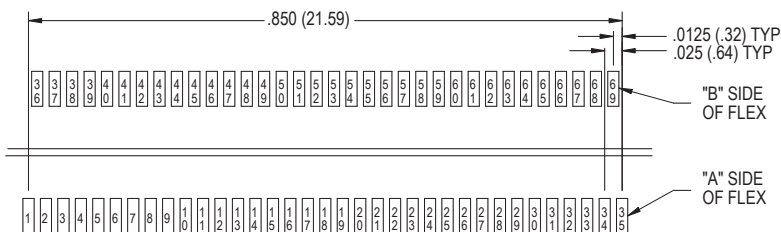

69 Contacts

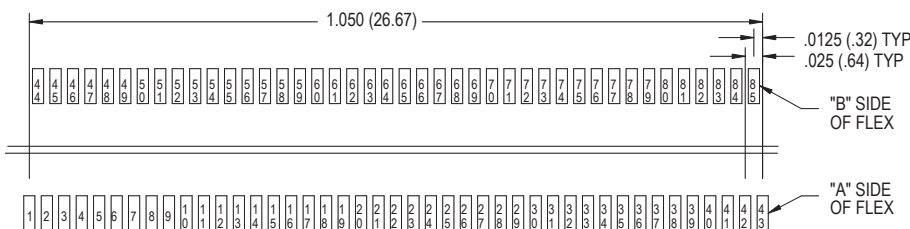

85 Contacts

