



Backshells and Accessories

440P*069 Banding Backshell

Self-Locking



440P*069 banding backshell fits Glenair Series 970 PowerTrip connectors. Anti-decoupling mechanism provides audible detented coupling and prevents backoff under high vibration. Terminate braid shield with optional band strap. Shrink boot provides environmental protection and strain relief. Aluminum version has thermoplastic detent spring, stainless steel version has stainless steel detent spring.

- EMI Banding adapter for Series 970 PowerTrip® connectors
- Self-locking coupling nut
- Groove for lipped shrink boot
- For shielded wire bundles

TABLE 1 ENTRY SIZE

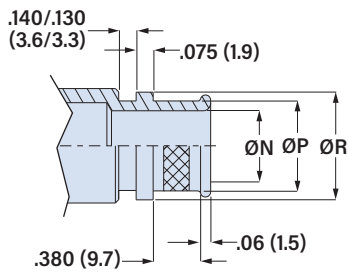

Entry Size	Shell Sizes*	ØN		ØP		Ø	
		in	mm	in	mm	in	mm
01	18-40	.125	3.2	.250	6.4	.312	7.9
31	18-40	.188	4.8	.312	7.9	.375	9.5
02	18-40	.250	6.4	.375	9.5	.438	11.1
32	18-40	.312	7.9	.438	11.1	.500	12.7
03	18-40	.375	9.5	.500	12.7	.562	14.3
33	18-40	.438	11.1	.562	14.3	.625	15.9
04	18-40	.500	12.7	.625	15.9	.687	17.4
34	18-40	.562	14.3	.688	17.5	.750	19.1
05	18-40	.625	15.9	.750	19.1	.812	20.6
35	18-40	.688	17.5	.812	20.6	.875	22.2
06	20-40	.750	19.1	.875	22.2	.938	23.8
36	20-40	.812	20.6	.938	23.8	1.000	25.4
07	24-40	.875	22.2	1.000	25.4	1.062	27.0
37	24-40	.938	23.8	1.062	27.0	1.125	28.6
08	24-40	1.000	25.4	1.125	28.6	1.188	30.2
38	28-40	1.062	27.0	1.188	30.2	1.250	31.8
09	28-40	1.125	28.6	1.250	31.8	1.312	33.3
10	28-40	1.250	31.8	1.375	34.9	1.438	36.5
11	32-40	1.375	34.9	1.500	38.1	1.562	39.7
12	32-40	1.500	38.1	1.625	41.3	1.688	42.9
13	32-40	1.625	41.3	1.750	44.5	1.812	46.0
14	36-40	1.750	44.5	1.875	47.6	1.938	49.2
15	40	1.875	47.6	2.000	50.8	2.062	52.4
16	40	2.000	50.8	2.125	54.0	2.188	55.6
17*	-	2.125	54.0	2.250	57.2	2.313	58.8
18*	-	2.250	57.2	2.375	60.3	2.438	61.9
19*	-	2.375	60.3	2.500	63.5	2.563	65.1
20*	-	2.500	63.5	2.625	66.7	2.688	68.3

* If selected entry size exceeds shell size range, a Style 2 transition adapter will be included. See Maximum Entry Size for details.

HOW TO ORDER

Sample Part Number →		440PS069	NF	20	05	-8	K	P	T
Base P/N	Base Part No.	440PS069	S						
	Profile	S	Straight						
		M	45°						
		N	90°						
Material/Finish	ME	Aluminum / Electroless Nickel							
	MT	Aluminum / Nickel PTFE							
	NF	Aluminum / Olive Drab Cadmium							
	TZ	Aluminum / Tin-Zinc							
	ZR	Aluminum / Black Zinc-Nickel							
ZI	Stainless Steel / Passivated								
Shell Size		18	20	24	28	32	36	40	
Entry Size		See Table 1							
Length	4	= 2 inches							
	6	= 3 inches							
	8	= 4 inches							
	10	= 5 inches							
12	= 6 inches								
		<i>Applies to Profile S only. If selected Entry Size is greater than Maximum Entry Size (see next page), then 3 inch minimum applies.</i>							
Band	Omit	= Not required							
	K	= Pre-Coiled Band included with backshell							
Polysulfide	Omit	= Not required. <i>Applies to Plating Codes NF, ZR, TZ only.</i>							
	P	= Nickel Plated Shield Termination Area with Polysulfide Barrier							
Shrink Boot	Omit	= Not required							
	T	= Standard Shrink Boot							
	S	= Zero Halogen Shrink Boot							

SHIELD BAND

Use banding strap to terminate cable braid. Stainless steel band strap provides fast, cost-effective and highly reliable termination of braided metallic shielding. The Band-Master AT® Advanced Cable Shield Termination System is the overwhelming favorite throughout the military aerospace and defense industries, providing excellent static loading and corrosion resistance in electrical wire interconnect systems.



Band Strap

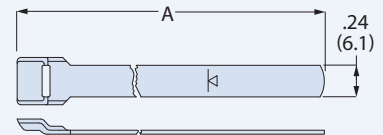

Banding Tool
601-100

A Length	Fits up to Dia.		Part Number Pre-coiled
	in	mm	
14	355	1.80	601-041
18	457	2.50	601-050

BACKSHELLS AND ACCESSORIES

Backshells and Accessories

440P*069 Banding Backshell

BACKSHELLS AND ACCESSORIES

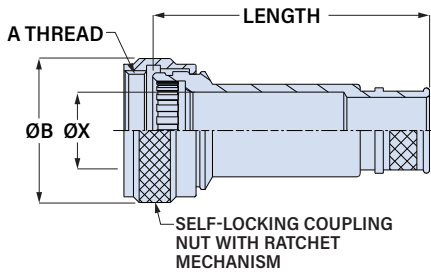

Profile **S** Straight

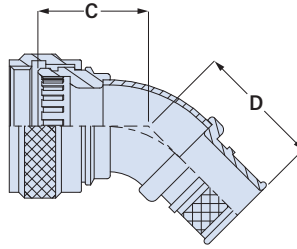

Profile **M** 45°

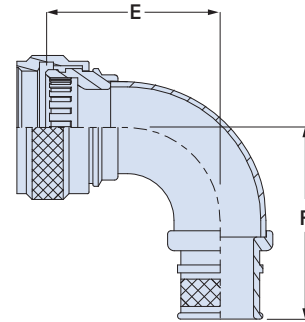

Profile **N** 90°

MAXIMUM ENTRY SIZE

If the selected entry size exceeds the maximum size in this table, the backshell will have a front adapter. This is called a [Style 2](#) backshell.

Shell Size	Maximum Entry Size
18	35
20	36
24	08
28	10
32	13
36	14
40	16

STYLE 2 STRAIGHT BACKSHELL

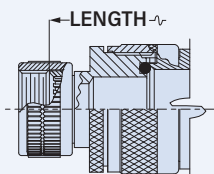

Style 2 profile **S** straight backshell minimum length code is 6 (3 inches).

STYLE 2 45° AND 90° BACKSHELLS

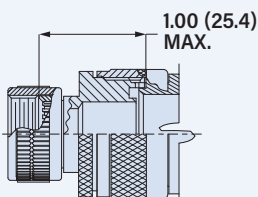

For Profile **M** and **N** 45° and 90° backshells, the front adapter adds 1 inch.

DIMENSIONS

Shell Size	A Thread -2B	Ø B Max.		C Max.		D Max.		E Max.		F Max.		X Min.		Max. Entry Size
		in	mm	in	mm	in	mm	in	mm	in	mm	in	mm	
18	1.125-18 UNEF	1.39	35.3	1.250	31.8	2.468	62.7	1.906	48.4	1.812	46.0	.724	18.4	35
20	1.250-18 UNEF	1.53	38.9	1.312	33.3	2.657	67.5	2.031	51.6	1.938	49.2	.858	21.8	36
24	1.4375-18 UNEF	1.72	43.7	1.406	35.7	3.063	77.8	2.281	57.9	2.188	55.6	1.043	26.5	08
28	1.8125-16 UN	2.13	54.1	1.500	38.1	3.656	92.9	2.531	64.3	2.625	66.7	1.353	34.4	10
32	2.0625-16 UNS	2.35	59.7	1.675	42.5	3.845	97.7	2.625	66.7	2.895	73.5	1.620	41.2	13
36	2.250-16 UN	2.59	65.8	1.799	45.7	4.230	107.4	2.875	73.0	3.145	79.9	1.823	46.3	14
40	2.500-16 UN	2.87	70.6	1.861	47.3	4.459	113.3	3.025	76.8	3.295	83.7	2.050	52.1	16

SHRINK BOOT

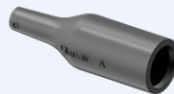

Optional heatshrink boot provides cable strain relief and environmental protection.

Standard Type 1 high-performance semi-rigid elastomer resists fuels and oils. Operating temperature range -75 to +150 °C.

Zero Halogen Type 2 high-performance semi-flexible polyolefin meets low smoke and toxicity requirements. Operating temperature range -40 to +130 °C.

Entry Sizes	Shrink Boot Part Number	
	Standard	Zero Halogen
01-31	770-003S111	770-003S211
02-32	770-003S112	770-003S212
03	770-001S103	770-001S203
33-35	770-001S104	770-001S204
06-37	770-001S105	770-001S205
08-38	770-001S106	770-001S206
09-12	770-001S107	770-001S207
13-14	770-001S108	770-001S208
15-16	770-001S109	770-001S209
17-20	770-001S110	770-001S210

POLYSULFIDE BARRIER

Optional selective electroless nickel plating on shield termination area and polysulfide dielectric barrier prevents galvanic mismatch between nickel-coated braid shield and backshell.

⚠ Plating codes *NF, ZR and TZ* only

