

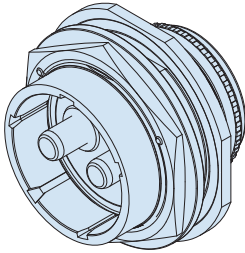

Jam Nut Receptacles

970-039 Blind Mate with Crimp Rear Release



970-039 blind mate jam nut receptacle with crimp rear release has pin contacts on one side and socket contacts on the other side. PowerTrip connectors feature low resistance LouverBand contacts and are designed to withstand extreme environments.

- Quick-disconnect, high shock, high vibration, self-locking connector
- 2000 VAC (DWV)
- -65° to +200 °C
- Plug has EMI ground spring
- Crimp, rear-release contacts
- Advanced IP68+ sealing

JAM NUT RECEPTACLES

INSERT ARRANGEMENTS						
Insert Arr.	Contact Size and Quantity					
	#16	#12	#8	#4	#1/0	#2/0
18-2			2			
18-4		2	2			
20-3			3			
20-4			4			
20-5		2	3			
20-7	4		3			
24-1					1	
24-2				2		
24-3				3		
24-5			5			
24-6		4		2		
24-A1						1
24-A6		3		3		
28-12	6		6			
28-15	15					
28-4				4		
28-8		1	7			
28-9	5			4		
32-12	2		10			
32-2					2	
32-20	1	19				
32-3					3	
32-4				2	2	
32-5				5		
32-6		3			3	
32-7				7		
32-A22		22				
36-16	3		13			
36-2						2
36-4					4	
36-9	14	14	2	1		
36-A8				8		
36-B8	4				4	
40-10	16		9	4		
40-21			21			
40-5					5	

HOW TO ORDER						
Sample Part Number →	970-039	MT	32-2	P	1	-1
Basic Part Number	970-039 Blind Mate Jam Nut Receptacle with Crimp Rear Release					
Material/Finish	ME = Aluminum / Electroless Nickel MT = Aluminum / Nickel PTFE NF = Aluminum / Olive Drab Cadmium ZR = Aluminum / Black Zinc-Nickel Z1 = Stainless Steel / Passivated ZMT = Stainless Steel / Nickel PTFE					
Shell Size-Insert Arr.	See "Insert Arrangements" Table					
Contact Designator	P = Pin Contact S = Socket Contact A = Pin Connector, Less Contacts B = Socket Connector, Less Contacts					
Contact Plating	1 = Silver - Size 8, 4, 0, and 2/0 Only 2 = Gold					
Keyway Position	-1, -2, -3, -4, -5, or -6					

RATINGS
Voltage (DWV): 2000 Volts AC
Current: Size 16 contact 13 amps Size 12 contact 23 amps Size 8 contact 60 amps Size 4 contact 100 amps Size 1/0 contact 175 amps Size 2/0 contact 205 amps
Operating temperature: Matl/Finish Codes ME, Z1: -65° to +200°C Codes MT, NF, ZR: -65 to +175 °C
Durability: 500 mating cycles
EMI shielding effectiveness: 65 dB min. 100 MHz to 10 GHz
Shock: 50 g
Vibration: per MIL-DTL-38999 Series III MIL-S-901 high impact shock: Grade A
Altitude immersion: 75,000 feet
Ingress protection: IP67
Water pressure: 6 feet, 48 hours

CONSTRUCTION
Contacts: Copper alloy, see How to Order.
Shell, jam nut: Aluminum or stainless steel, see How to Order
Insulator: High grade rigid dielectric
Seals: Fluorosilicone
O-ring: Fluorosilicone
Washer: PTFE

Jam Nut Receptacles

970-039 Blind Mate with Crimp Rear Release

JAM NUT RECEPTACLES

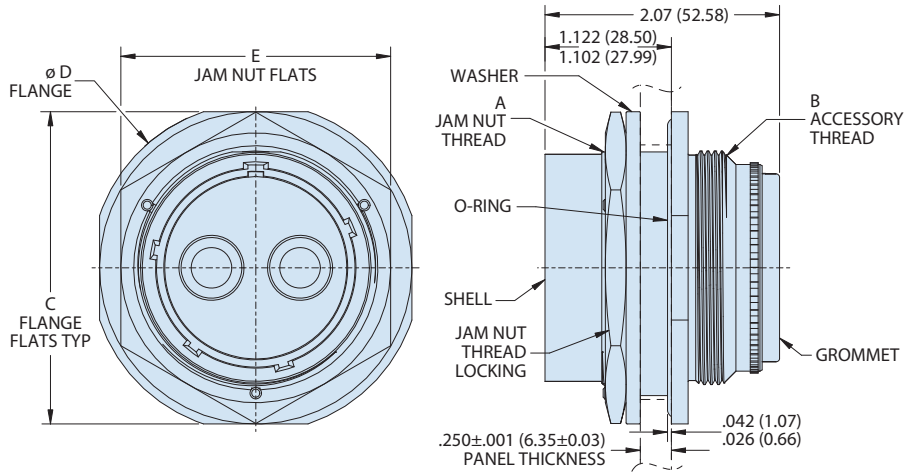

DIMENSIONS								
Shell Size	A Jam Nut Thread	B Accessory Thread	C In.	C mm.	ϕD In.	ϕD mm.	E In.	E mm.
18	1.250-18UNEF-2A	1.125-18UNEF-2A	1.875	47.63	2.025	51.43	1.438	36.53
20	1.4375-18UNEF-2A	1.250-18UNEF-2A	2.125	53.97	2.275	57.79	1.625	41.28
24	1.625-18UNEF-2A	1.4375-18UNEF-2A	2.250	57.15	2.400	60.96	1.822	46.28
28	1.9375-16UN-2A	1.8125-16UN-2A	2.625	66.68	2.775	70.49	2.188	55.58
32	2.125-16UN-2A	2.0625-16UN5-2A	2.750	69.85	2.900	73.66	2.375	60.33
36	2.375-16UN-2A	2.250-16UN-2A	3.000	76.20	3.150	80.01	2.625	66.68
40	2.625-16UN-2A	2.500-16UN-2A	3.250	82.55	3.400	86.36	2.875	73.02

PANEL OPENING		
	ϕF	G FLAT
Shell Size	ϕF +.010 -.000	G +.010 -.000
18	1.425 (36.20)	1.325 (33.65)
20	1.613 (40.97)	1.513 (38.43)
24	1.800 (45.72)	1.700 (43.18)
28	2.113 (53.67)	2.013 (51.13)
32	2.300 (58.42)	2.200 (55.88)
36	2.550 (64.77)	2.450 (62.23)
40	2.800 (71.12)	2.700 (68.58)

KEY POSITIONS				
	A	B	C	D
Position	A°	B°	C°	D°
1	80	142	196	293
2	135	170	200	310
3	49	169	200	244
4	66	140	200	257
5	62	145	180	280
6	79	153	197	272