

D-Subminiature

550-005

Shrouded Backshell, Braid Trap

- Split EMI Backshell
- Braid Trap Shield Termination
- Saddle Clamp Strain Relief



550-005

This accessory fits D-Subminiature M24308 connectors.
Not compatible with Series 28 HiPer-D

Braid trap shield termination. 550-005 diecast aluminum backshell fits M24308 D-Subminiature connectors. EMI protected. Tapered candelabra thread captivates shield braid. Backshell has groove for heatshrink boot (P/N 770-007). Backshell fully shrouds the connector. Eleven shroud lengths. Choose shroud length based on mating connector mounting style. Optional metalastic EMI panel gasket installs onto mating connector. When fully mated, the backshell shroud seats onto the gasket for low-resistance grounding and EMI protection. Aluminum alloy, stainless steel hardware.

TABLE 1 SCREWLOCK OPTIONS

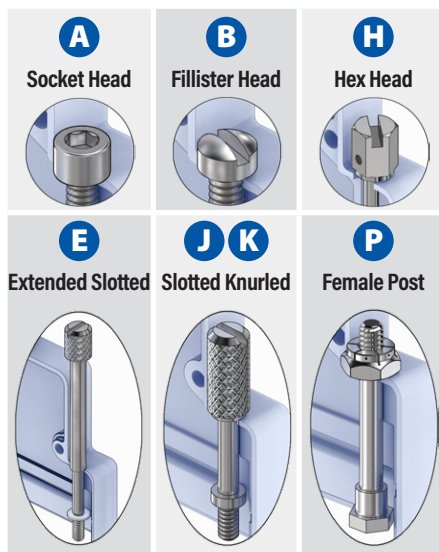

PART NUMBER

Sample PN → **550T005 M 3 R3 A 0 F 04**

Base P/N	550T005 T Top Entry 550E005 E End Entry 550S005 S Side Entry																																			
Finish	TZ Tin-Zinc MN MegaNickel JF Cadmium, Yel. Chromate M Electroless Nickel NF Olive Drab Cadmium MT Nickel-PTFE ZR Black Zinc-Nickel																																			
Shell Size	1 2 3 4 5 6																																			
Shroud Length	Mating Connector Rear Panel Mounting																																			
	<table border="1"> <thead> <tr> <th>Code</th> <th>Panel Thickness</th> <th>E</th> </tr> </thead> <tbody> <tr><td>R1</td><td>.031 (0.8)</td><td>.247 (6.3)</td></tr> <tr><td>R2</td><td>.047 (1.2)</td><td>.231 (5.9)</td></tr> <tr><td>R3</td><td>.062 (1.6)</td><td>.216 (5.5)</td></tr> <tr><td>R4</td><td>.093 (2.4)</td><td>.185 (4.7)</td></tr> <tr><td>R5</td><td>.104 (2.6)</td><td>.174 (4.4)</td></tr> <tr><td>R6</td><td>.125 (3.2)</td><td>.153 (3.9)</td></tr> <tr><td>R7</td><td>.156 (4.0)</td><td>.125 (3.2)</td></tr> <tr><td>R8</td><td>.135 (3.4)</td><td>.140 (3.6)</td></tr> <tr><td>R9</td><td>.188 (4.8)</td><td>.094 (2.4)</td></tr> <tr><td>CC</td><td>Cable-to-Cable</td><td>.174 (4.4)</td></tr> <tr><td>F0</td><td>Front Panel Mount</td><td>.343 (8.7)</td></tr> </tbody> </table>	Code	Panel Thickness	E	R1	.031 (0.8)	.247 (6.3)	R2	.047 (1.2)	.231 (5.9)	R3	.062 (1.6)	.216 (5.5)	R4	.093 (2.4)	.185 (4.7)	R5	.104 (2.6)	.174 (4.4)	R6	.125 (3.2)	.153 (3.9)	R7	.156 (4.0)	.125 (3.2)	R8	.135 (3.4)	.140 (3.6)	R9	.188 (4.8)	.094 (2.4)	CC	Cable-to-Cable	.174 (4.4)	F0	Front Panel Mount
Code	Panel Thickness	E																																		
R1	.031 (0.8)	.247 (6.3)																																		
R2	.047 (1.2)	.231 (5.9)																																		
R3	.062 (1.6)	.216 (5.5)																																		
R4	.093 (2.4)	.185 (4.7)																																		
R5	.104 (2.6)	.174 (4.4)																																		
R6	.125 (3.2)	.153 (3.9)																																		
R7	.156 (4.0)	.125 (3.2)																																		
R8	.135 (3.4)	.140 (3.6)																																		
R9	.188 (4.8)	.094 (2.4)																																		
CC	Cable-to-Cable	.174 (4.4)																																		
F0	Front Panel Mount	.343 (8.7)																																		
Screwlocks <i>(Table 1)</i>	<table border="1"> <thead> <tr> <th>Code</th> <th>Type</th> <th>Profiles</th> </tr> </thead> <tbody> <tr><td>A</td><td>Male, Socket Head</td><td>S T</td></tr> <tr><td>B</td><td>Male, Fillister Head</td><td>S T</td></tr> <tr><td>E</td><td>Male, Extended Slotted</td><td>S T</td></tr> <tr><td>H</td><td>Male, Hex Head, Drilled</td><td>S T</td></tr> <tr><td>J</td><td>Male, Slotted, Knurled</td><td>E</td></tr> <tr><td>K</td><td>Male, Slotted, Knurled</td><td>S T</td></tr> <tr><td>P</td><td>Female Hex Post, Fixed</td><td>S T</td></tr> </tbody> </table>	Code	Type	Profiles	A	Male, Socket Head	S T	B	Male, Fillister Head	S T	E	Male, Extended Slotted	S T	H	Male, Hex Head, Drilled	S T	J	Male, Slotted, Knurled	E	K	Male, Slotted, Knurled	S T	P	Female Hex Post, Fixed	S T											
	Code	Type	Profiles																																	
	A	Male, Socket Head	S T																																	
	B	Male, Fillister Head	S T																																	
	E	Male, Extended Slotted	S T																																	
	H	Male, Hex Head, Drilled	S T																																	
	J	Male, Slotted, Knurled	E																																	
K	Male, Slotted, Knurled	S T																																		
P	Female Hex Post, Fixed	S T																																		
EMI Panel Gasket	0 No Gasket 1 Gasket Included <i>(install on mating connector)</i>																																			
Strain Relief	F Saddle Clamp G Gland Nut																																			
Entry Size	<table border="1"> <thead> <tr> <th>Entry Size</th> <th>Cable Range Min</th> <th>Cable Range Max</th> <th>Shell Size</th> </tr> </thead> <tbody> <tr><td>02</td><td>.125 (3.2)</td><td>.250 (6.4)</td><td>1-6</td></tr> <tr><td>03</td><td>.250 (6.4)</td><td>.375 (9.5)</td><td>1-6</td></tr> <tr><td>04</td><td>.312 (7.9)</td><td>.500 (12.7)</td><td>1-6</td></tr> <tr><td>05</td><td>.437 (11.1)</td><td>.625 (15.9)</td><td>1-6</td></tr> <tr><td>06</td><td>.562 (14.3)</td><td>.750 (19.1)</td><td>1-6</td></tr> <tr><td>07</td><td>.687 (17.4)</td><td>.875 (22.2)</td><td>6</td></tr> <tr><td>08</td><td>.812 (20.6)</td><td>1.000 (25.4)</td><td>6</td></tr> </tbody> </table>	Entry Size	Cable Range Min	Cable Range Max	Shell Size	02	.125 (3.2)	.250 (6.4)	1-6	03	.250 (6.4)	.375 (9.5)	1-6	04	.312 (7.9)	.500 (12.7)	1-6	05	.437 (11.1)	.625 (15.9)	1-6	06	.562 (14.3)	.750 (19.1)	1-6	07	.687 (17.4)	.875 (22.2)	6	08	.812 (20.6)	1.000 (25.4)	6			
	Entry Size	Cable Range Min	Cable Range Max	Shell Size																																
	02	.125 (3.2)	.250 (6.4)	1-6																																
	03	.250 (6.4)	.375 (9.5)	1-6																																
	04	.312 (7.9)	.500 (12.7)	1-6																																
	05	.437 (11.1)	.625 (15.9)	1-6																																
	06	.562 (14.3)	.750 (19.1)	1-6																																
07	.687 (17.4)	.875 (22.2)	6																																	
08	.812 (20.6)	1.000 (25.4)	6																																	

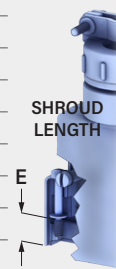

D-SUBMINIATURE ACCESSORIES

D-Subminiature

550-005

Shrouded Backshell, Braid Trap

- Split EMI Backshell
- Braid Trap Shield Termination
- Saddle Clamp Strain Relief

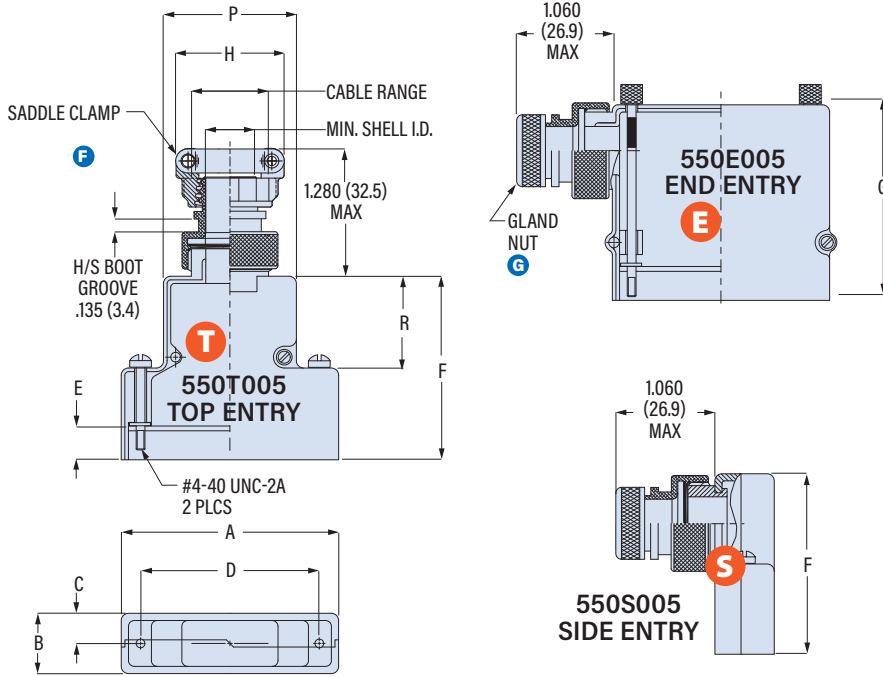

BRAID TRAP

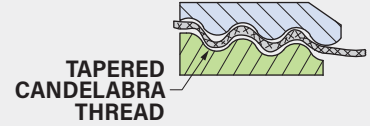

EMI PANEL GASKET

Install gasket on front side of mating connector panel. When backshell is fastened to panel connector, the front edge of the shroud seats onto gasket for aperture-free EMI protection.

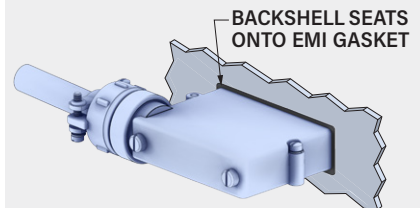
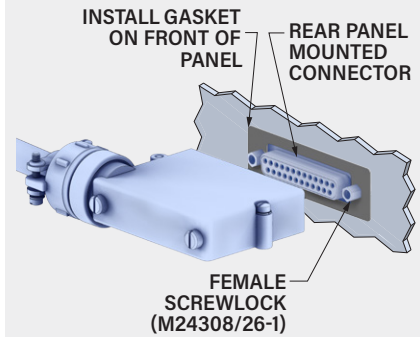

EMI PANEL GASKET
.020 (0.5) THICK
MATL: ALUMINUM
MESH EMBEDDED IN
SILICONE

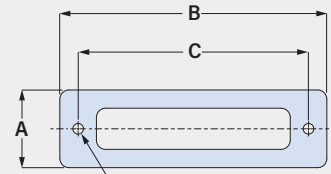

Shell Size	A Max		B Max		C	D		P	R		Max Entry Size		
	in	mm	in	mm		± .005 (0.13)	in		mm	in		mm	
1	1.393	35.4	.624	15.8	.312	7.9	.984	25.0	.730	18.5	.719	18.3	06
2	1.706	43.3	.624	15.8	.312	7.9	1.312	33.3	1.050	26.7	.719	18.3	06
3	2.265	57.5	.624	15.8	.312	7.9	1.852	47.0	1.594	40.5	.938	23.8	06
4	2.900	73.7	.624	15.8	.312	7.9	2.500	63.5	2.240	56.9	.938	23.8	06
5	2.800	71.1	.750	19.1	.375	9.5	2.406	61.1	2.140	54.4	.938	23.8	06
6	2.900	73.7	.844	21.4	.422	10.7	2.500	63.5	2.240	56.9	1.094	27.8	08

Shroud Length	Mating Connector Panel Thickness		E Shroud Length		F				G					
	in	mm	in	mm	Size 1, 2		± .031 (0.8) Size 3, 4, 5		Size 6		± .031 (0.8) Size 1, 2		Size 3-6	
	in	mm	in	mm	in	mm	in	mm	in	mm	in	mm	in	mm
CC	N/A	N/A	.174	4.4	1.451	36.9	1.671	42.4	1.820	46.2	1.583	40.2	1.831	46.5
FO	N/A	N/A	.343	8.7	1.625	41.3	1.844	46.8	2.000	50.8	1.750	44.5	2.000	50.8
R1	.031	0.8	.247	6.3	1.525	38.7	1.745	44.3	1.890	48.0	1.656	42.1	1.904	48.4
R2	.047	1.2	.231	5.9	1.509	38.3	1.728	43.9	1.875	47.6	1.640	41.7	1.888	48.0
R3	.062	1.6	.216	5.5	1.500	38.1	1.720	43.7	1.860	47.2	1.625	41.3	1.873	47.6
R4	.093	2.4	.185	4.7	1.470	37.3	1.690	42.9	1.829	46.5	1.594	40.5	1.842	46.8
R5	.104	2.6	.174	4.4	1.451	36.9	1.671	42.4	1.820	46.2	1.583	40.2	1.831	46.5
R6	.125	3.2	.153	3.9	1.430	36.3	1.650	41.9	1.798	45.7	1.563	39.7	1.811	46.0
R7	.156	4.0	.125	3.2	1.400	35.6	1.620	41.1	1.767	44.9	1.531	38.9	1.781	45.2
R8	.135	3.4	.140	3.6	1.417	36.0	1.637	41.6	1.805	45.8	1.550	39.4	1.798	45.7
R9	.188	4.8	.094	2.4	1.368	34.7	1.590	40.4	1.740	44.2	1.500	38.1	1.750	44.5

Entry Size	H Max	Cable Range			Shell I.D. Min.	
		in	mm	in	mm	in
02	.968	24.6	.125	3.2	.250	6.4
03	1.046	26.6	.250	6.4	.375	9.5
04	1.156	29.4	.312	7.9	.500	12.7
05	1.218	30.9	.437	11.1	.625	15.9
06	1.343	34.1	.562	14.3	.750	19.1
07	1.468	37.3	.687	17.4	.875	22.2
08	1.593	40.5	.812	20.6	1.000	25.4

Shell Size	Top Entry		End Entry	
	in	mm	in	mm
1	.250	6.4	.375	9.5
2	.375	9.5	.375	9.5
3	.475	12.1	.475	12.1
4	.475	12.1	.475	12.1
5	.575	14.6	.575	14.6
6	1.000	25.4		

Shell Size	Gasket Part No.	A		B		C	
		in	mm	in	mm	in	mm
1	559-002-1	.740	18.8	1.500	38.1	.980	24.9
2	559-002-2	.740	18.8	1.810	46.0	1.312	33.3
3	559-002-3	.740	18.8	2.380	60.5	1.852	47.0
4	559-002-4	.740	18.8	3.010	76.5	2.500	63.5
5	559-002-5	.850	21.6	2.920	74.2	2.406	61.1
6	559-002-6	.925	23.5	3.010	76.4	2.500	63.5

D-SUBMINIATURE ACCESSORIES