

# D-Subminiature

## 557-186

### Shrouded Backshell, Composite Banding

- Split EMI Backshell
- Banding Shield Termination
- Composite Thermoplastic



#### 557-186

This accessory fits D-Subminiature M24308 connectors.  
Not compatible with Series 28 HiPer-D

**Corrosion-free lightweight composite.**  
557-186 composite thermoplastic backshell fits M24308 D-Subminiature connectors. EMI protected. Cable shield attaches to backshell with optional band strap. Install optional EMI gasket on mating connector panel. Connector is captivated between backshell halves. Eleven shroud lengths to accommodate mating connector mounting dimensions. #4-40 screwlocks are included. Thermoplastic with stainless steel screws and washers.

**TABLE 1**  
SCREWLOCK OPTIONS

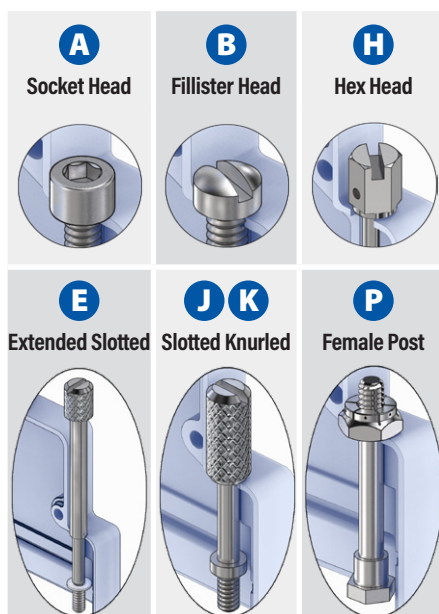

#### PART NUMBER

Sample PN → **557T186 XM 3 R3 A 0 -04 S K**

Base P/N	<b>557T186</b> <b>T</b> Top Entry
	<b>557E186</b> <b>E</b> End Entry
	<b>557S186</b> <b>S</b> Side Entry
Finish	<b>XM</b> Electroless Nickel
	<b>XW</b> Olive Drab Cadmium
	<b>XMT</b> Nickel-PTFE
Shell Size	<b>1 2 3 4 5 6</b>
Shroud Length	<b>Mating Connector Rear Panel Mounting</b>
	Code Panel Thickness E
	<b>R1</b> .031 (0.8) .247 (6.3)
	<b>R2</b> .047 (1.2) .231 (5.9)
	<b>R3</b> .062 (1.6) .216 (5.5)
	<b>R4</b> .093 (2.4) .185 (4.7)
	<b>R5</b> .104 (2.6) .174 (4.4)
	<b>R6</b> .125 (3.2) .153 (3.9)
	<b>R7</b> .156 (4.0) .125 (3.2)
	<b>R8</b> .135 (3.4) .140 (3.6)
	<b>R9</b> .188 (4.8) .094 (2.4)
<b>CC</b> Cable-to-Cable .174 (4.4)	
<b>F0</b> Front Panel Mtng. .343 (8.7)	
Screwlocks (Table 1)	<b>Profiles</b>
	<b>A</b> Male, Socket Head <b>S T</b>
	<b>B</b> Male, Fillister Head <b>S T</b>
	<b>E</b> Male, Extended Slotted <b>S T</b>
	<b>H</b> Male, Hex Head, Drilled <b>S T</b>
	<b>J</b> Male, Slotted, Knurled <b>E</b>
	<b>K</b> Male, Slotted, Knurled <b>S T</b>
<b>P</b> Female Hex Post, Fixed <b>S T</b>	
EMI Panel Gasket	<b>0</b> No Gasket
	<b>1</b> Gasket Included (install on mating connector)
Entry Size	Shell Size
	Entry Size ø H S T E
	<b>-01</b> .125 (3.2) 1-5 1-6 1-6
	<b>-02</b> .250 (6.4) 1-5 1-6 1-6
	<b>-03</b> .312 (7.9) 1-5 1-6 1-6
	<b>-04</b> .395 (10.0) 1-5 1-6 1-6
	<b>-05</b> .438 (11.1) 2-5 1-6 1-6
	<b>-06</b> .500 (12.7) 5-5 5-6 5-6
	<b>-07</b> .562 (14.3) 5 5-6 5-6
	<b>-08</b> .625 (15.9) - 6 6
	<b>-09</b> .750 (19.1) - 6 6
<b>-10</b> .875 (22.2) - 6 6	
<b>-11</b> 1.000 (25.4) - 6 6	
Slot	<b>Omit</b> No Slot
	<b>S</b> Slot (in banding area)
Band	<b>Omit</b> No Band
	<b>B</b> Standard Band Included
	<b>J</b> Slim Standard Band Included

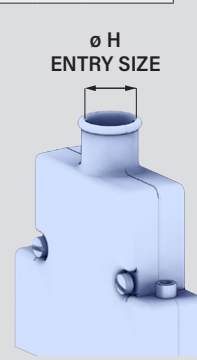
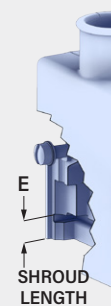

# D-Subminiature

## 557-186

### Shrouded Backshell, Composite Banding

- Split EMI Backshell
- Banding Shield Termination
- Composite Thermoplastic

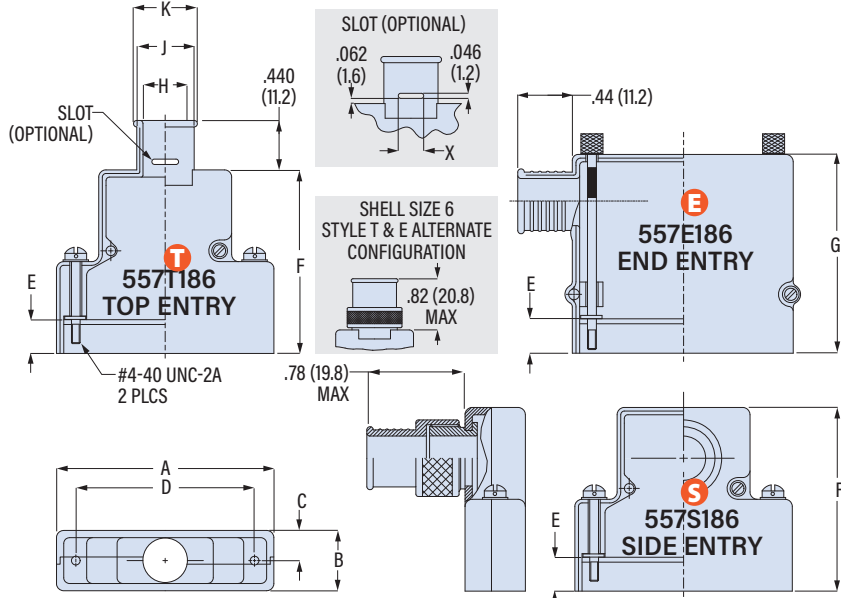

### EMI PANEL GASKET

Install gasket on front side of mating connector panel. Gasket material: metalastic (aluminum mesh and silicone). When backshell is fastened to panel connector, the front edge of the shroud seats onto gasket for aperture-free EMI protection.

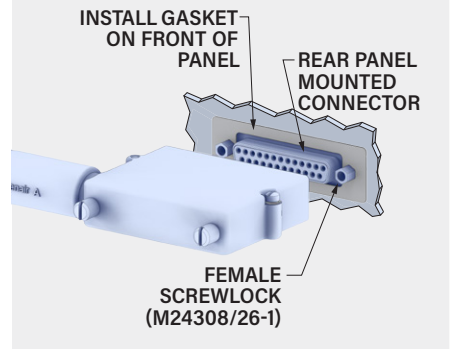

Shell Size	A Max		B Max		C	D ±.005 (0.13)		Max Entry Size			
	in	mm	in	mm		in	mm	S	T	E	
1	1.393	35.4	.624	15.8	.312	7.9	.984	25.0	04	05	05
2	1.706	43.3	.624	15.8	.312	7.9	1.312	33.3	05	05	05
3	2.265	57.5	.624	15.8	.312	7.9	1.852	47.0	05	05	05
4	2.900	73.7	.624	15.8	.312	7.9	2.500	63.5	05	05	05
5	2.800	71.1	.750	19.1	.375	9.5	2.406	61.1	07	07	07
6	2.900	73.7	.844	21.4	.422	10.7	2.500	63.5	-	11	11

Shroud Length	Mating Connector Panel Thickness		E* Shroud Length		F* ±.031 (0.8)			G* ±.031 (0.8)						
	in	mm	in	mm	Size 1, 2	Size 3, 4, 5	Size 6	Size 1, 2	Size 3-6	Size 3-6				
CC	N/A	N/A	.185	4.7	1.455	37.3	1.673	42.8	1.829	46.8	1.592	40.4	1.842	46.8
F0	N/A	N/A	.343	8.7	1.625	41.3	1.844	46.8	2.000	50.8	1.750	44.5	2.000	50.8
R1	.031	0.8	.247	6.3	1.525	38.7	1.745	44.3	1.904	48.4	1.656	42.1	1.904	48.4
R2	.047	1.2	.231	5.9	1.509	38.3	1.728	43.9	1.888	48.0	1.640	41.7	1.888	48.0
R3	.062	1.6	.216	5.5	1.500	38.1	1.720	43.7	1.873	47.6	1.625	41.3	1.873	47.6
R4	.093	2.4	.185	4.7	1.470	37.3	1.690	42.9	1.842	46.8	1.594	40.5	1.842	46.8
R5	.104	2.6	.174	4.4	1.451	36.9	1.671	42.4	1.831	46.5	1.585	40.3	1.833	46.6
R6	.125	3.2	.153	3.9	1.430	36.3	1.650	41.9	1.811	46.0	1.563	39.7	1.811	46.0
R7	.156	4.0	.125	3.2	1.400	35.6	1.620	41.1	1.781	45.2	1.532	38.9	1.780	45.2
R8	.135	3.4	.140	3.6	1.422	36.1	1.641	41.7	1.797	45.7	1.547	39.3	1.797	45.7
R9	.188	4.8	.094	2.4	1.376	34.9	1.595	40.5	1.751	44.5	1.501	38.1	1.751	44.5

\*+.030/- .000 for CC only

Entry Size	ø H		ø J		ø K		X	
	in	mm	in	mm	in	mm	in	mm
01	.125	3.2	.250	6.4	.312	7.9	N/A	N/A
02	.250	6.4	.375	9.5	.438	11.1	.062	1.6
03	.312	7.9	.438	11.1	.500	12.7	.094	2.4
04	.395	10.0	.500	12.7	.562	14.3	.156	4.0
05	.438	11.1	.562	14.3	.625	15.9	.188	4.8
06	.500	12.7	.625	15.9	.688	17.5	.219	5.6
07	.562	14.3	.688	17.5	.750	19.1	.250	6.4
08	.625	15.9	.750	19.1	.812	20.6	.250	6.4
09	.750	19.1	.875	22.2	.937	23.8	.312	7.9
10	.875	22.2	1.000	25.4	1.062	27.0	.375	9.5
11	1.000	25.4	1.125	28.6	1.188	30.2	.375	9.5

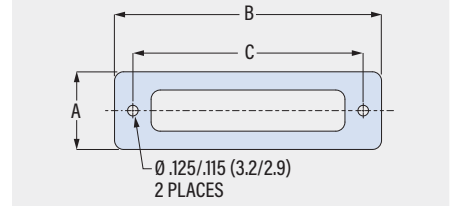

Shell Size	Gasket Part No.	A in	A mm	B in	B mm	C in	C mm
1	559-002-1	.740	18.8	1.500	38.1	.980	24.9
2	559-002-2	.740	18.8	1.810	46.0	1.310	33.3
3	559-002-3	.740	18.8	2.380	60.5	1.850	47.0
4	559-002-4	.740	18.8	3.010	76.5	2.500	63.5
5	559-002-5	.850	21.6	2.920	74.2	2.410	61.2
6	559-002-6	.925	23.5	3.010	76.5	2.500	63.5

### BAND OPTIONS

Terminate cable braid to backshell with optional band strap and banding tool. Pre-coiled bands are passivated stainless steel. Slim Standard bands have reduced thickness for weight reduction.



Band Type and Width	Hand Tool	Pneumatic Tool
Standard: .24 (6.1)	601-100	601-106
Slim Standard: .24 (6.1)	601-109	601-110

D-SUBMINIATURE ACCESSORIES