

Micro-D

500-010

EMI Banding Backshell

- Solid Backshell
- Band-Master ATS® Shield Termination
- Top, Side and 45° Entry



T Top Entry



S Side Entry



E 45° Entry



D Dual 45°

500-010

This accessory fits MWDM and M83513 Class M metal shell Micro-D connectors.

EMI, banding. 500-010 backshell fits MIL-DTL-83513 Class M and Glenair MWDM Micro-D connectors. Terminate cable shield to backshell with BandMaster ATS band strap. Available with screwlocks or jackscrews; screwlocks allow connectors to be fully mated prior to fastening screws, jackscrews must be tightened in order to mate connectors. Aluminum or stainless steel with passivated stainless steel screws and retainer clips.

TABLE 1
SCREWLOCK OPTIONS

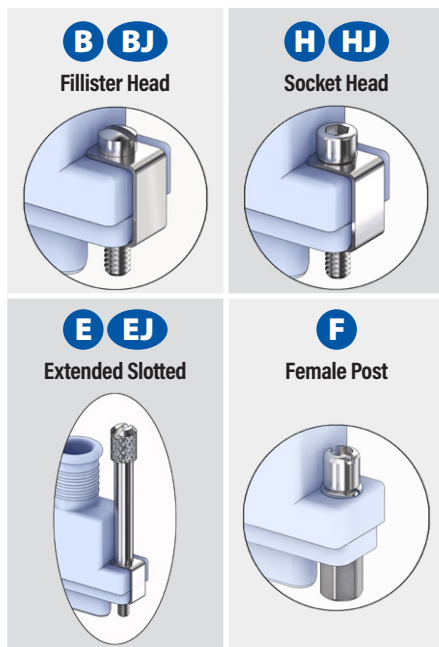

PART NUMBER

Sample PN → **500T010 M 37 H 07 S L**

Base P/N	500T010 T Top Entry 500S010 S Side Entry 500E010 E 45° Entry 500D010 D Dual 45° Entry																																																																
Material / Finish	TZ Tin-Zinc JF Alum / Cadmium w/ Yel. Chromate M Alum / Electroless Nickel MT Alum / Nickel-PTFE ZR Alum / Black Zinc-Nickel Z1 SST / Passivated Z2 Alum / Gold																																																																
Shell Size	09 15 21 25 31 37 51 51-2 67 69 75 100 130																																																																
Screwlocks (Table 1)	<table border="1"> <tr> <th>Male Screwlocks</th> <th>Jackscrews</th> </tr> <tr> <td>B Fillister Head</td> <td>BJ Fillister Head</td> </tr> <tr> <td>H Socket Head</td> <td>HJ Socket Head</td> </tr> <tr> <td>E* Extended Slotted*</td> <td>EJ* Extended Slotted*</td> </tr> <tr> <td colspan="2">Female Post</td> </tr> <tr> <td>F Female Jackpost</td> <td>* E and EJ options available on Profiles S T only</td> </tr> </table>	Male Screwlocks	Jackscrews	B Fillister Head	BJ Fillister Head	H Socket Head	HJ Socket Head	E* Extended Slotted*	EJ* Extended Slotted*	Female Post		F Female Jackpost	* E and EJ options available on Profiles S T only																																																				
Male Screwlocks	Jackscrews																																																																
B Fillister Head	BJ Fillister Head																																																																
H Socket Head	HJ Socket Head																																																																
E* Extended Slotted*	EJ* Extended Slotted*																																																																
Female Post																																																																	
F Female Jackpost	* E and EJ options available on Profiles S T only																																																																
Entry Size	<table border="1"> <thead> <tr> <th rowspan="2">Entry Size</th> <th rowspan="2">P Diameter</th> <th colspan="4">Shell Size</th> </tr> <tr> <th>T</th> <th>S</th> <th>E</th> <th>D</th> </tr> </thead> <tbody> <tr> <td>04</td> <td>.125 (3.2)</td> <td>All</td> <td>All</td> <td>All</td> <td>All</td> </tr> <tr> <td>05</td> <td>.156 (4.0)</td> <td>All</td> <td>All</td> <td>All</td> <td>All</td> </tr> <tr> <td>06</td> <td>.188 (4.8)</td> <td>All</td> <td>All</td> <td>All</td> <td>All</td> </tr> <tr> <td>07</td> <td>.219 (5.6)</td> <td>All</td> <td>All</td> <td>All</td> <td>15-up</td> </tr> <tr> <td>08</td> <td>.250 (6.4)</td> <td>All</td> <td>All</td> <td>All</td> <td>15-up</td> </tr> <tr> <td>09</td> <td>.281 (7.1)</td> <td>All</td> <td>All</td> <td>31-up</td> <td>31-up</td> </tr> <tr> <td>10</td> <td>.312 (7.9)</td> <td>15-up</td> <td>15-up</td> <td>51, 69-up</td> <td>51, 69-up</td> </tr> <tr> <td>11</td> <td>.344 (8.7)</td> <td>100-up</td> <td>15-up</td> <td>100-up</td> <td>100-up</td> </tr> <tr> <td>12</td> <td>.375 (9.5)</td> <td>100-up</td> <td>15-up</td> <td>100-up</td> <td>100-up</td> </tr> </tbody> </table>	Entry Size	P Diameter	Shell Size				T	S	E	D	04	.125 (3.2)	All	All	All	All	05	.156 (4.0)	All	All	All	All	06	.188 (4.8)	All	All	All	All	07	.219 (5.6)	All	All	All	15-up	08	.250 (6.4)	All	All	All	15-up	09	.281 (7.1)	All	All	31-up	31-up	10	.312 (7.9)	15-up	15-up	51, 69-up	51, 69-up	11	.344 (8.7)	100-up	15-up	100-up	100-up	12	.375 (9.5)	100-up	15-up	100-up	100-up
Entry Size	P Diameter			Shell Size																																																													
		T	S	E	D																																																												
04	.125 (3.2)	All	All	All	All																																																												
05	.156 (4.0)	All	All	All	All																																																												
06	.188 (4.8)	All	All	All	All																																																												
07	.219 (5.6)	All	All	All	15-up																																																												
08	.250 (6.4)	All	All	All	15-up																																																												
09	.281 (7.1)	All	All	31-up	31-up																																																												
10	.312 (7.9)	15-up	15-up	51, 69-up	51, 69-up																																																												
11	.344 (8.7)	100-up	15-up	100-up	100-up																																																												
12	.375 (9.5)	100-up	15-up	100-up	100-up																																																												
Qwik-Ty	Omit No Qwik-Ty Strain Relief Arm S Qwik-Ty Arm Included																																																																
Band	Omit No Band K Standard Band Included P Slim Standard Band Included L Micro Band Included J Micro Slim Band Included N Micro-Max Band Included																																																																

Micro-D

500-010

EMI Banding Backshell

- Solid Backshell
- Band-Master ATS® Shield Termination
- Top, Side and 45° Entry

MICRO-D ACCESSORIES

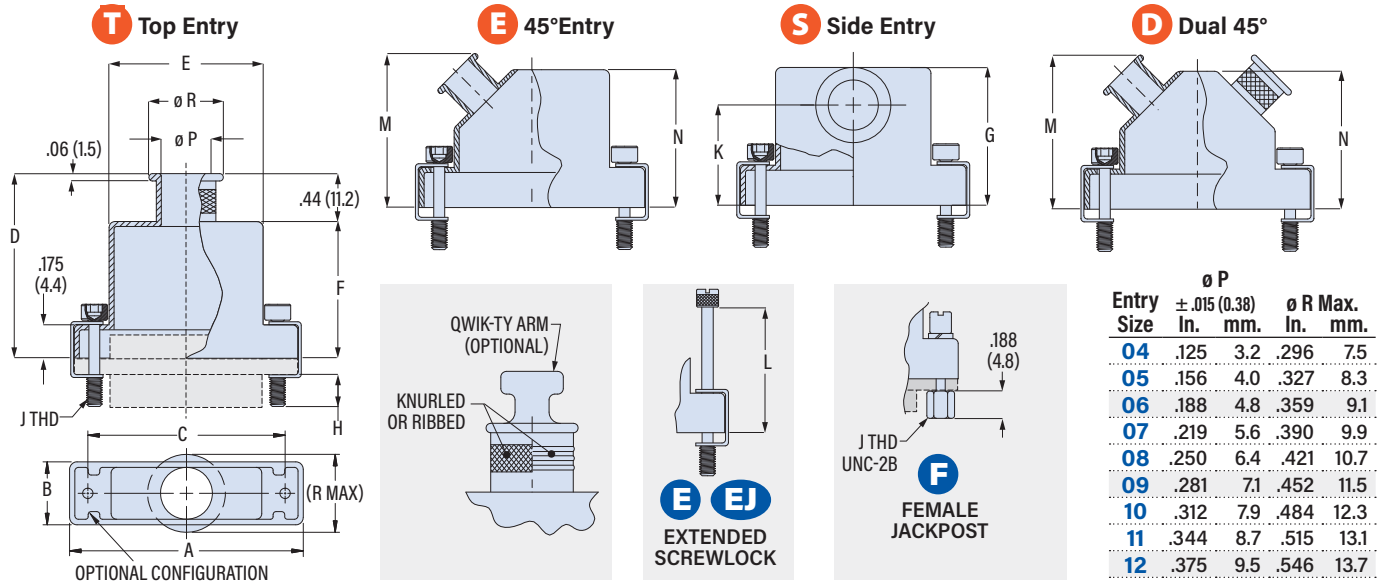

Entry Size	$\pm .015$ (0.38)	θR Max.
	In. mm.	In. mm.
04	.125 3.2	.296 7.5
05	.156 4.0	.327 8.3
06	.188 4.8	.359 9.1
07	.219 5.6	.390 9.9
08	.250 6.4	.421 10.7
09	.281 7.1	.452 11.5
10	.312 7.9	.484 12.3
11	.344 8.7	.515 13.1
12	.375 9.5	.546 13.7

Size	A Max.		B Max.		C		D Max.		E Max.		F Max.		G Max.		H Ref.		J Thd	K		L Max.		M Max.		N Max.	
	in	mm	in	mm	in	mm	in	mm	in	mm	in	mm	in	mm	in	mm	UNC-2A	in	mm	in	mm	in	mm	in	mm
09	.850	21.6	.370	9.4	.565	14.4	.780	19.8	.410	10.4	.350	8.9	.637	16.2	.154	3.9	2-56	.435	11.0	1.040	26.4	1.288	32.7	.968	24.6
15	1.000	25.4	.370	9.4	.715	18.2	.910	23.1	.580	14.7	.470	11.9	.673	17.1	.154	3.9	2-56	.440	11.2	1.170	29.7	1.288	32.7	.968	24.6
21	1.150	29.2	.370	9.4	.865	22.0	1.030	26.2	.740	18.8	.590	15.0	.707	18.0	.154	3.9	2-56	.458	11.6	1.290	32.8	1.288	32.7	.968	24.6
25	1.250	31.8	.370	9.4	.965	24.5	1.090	27.7	.850	21.6	.650	16.5	.748	19.0	.154	3.9	2-56	.483	12.3	1.350	34.3	1.090	27.7	.830	21.1
31	1.400	35.6	.370	9.4	1.115	28.3	1.150	29.2	.980	24.9	.710	18.0	.756	19.2	.154	3.9	2-56	.476	12.1	1.420	36.1	1.130	28.7	.890	22.6
37	1.550	39.4	.370	9.4	1.265	32.1	1.190	30.2	1.130	28.7	.750	19.1	.774	19.7	.154	3.9	2-56	.478	12.1	1.450	36.8	1.230	31.2	.955	24.3
51	1.500	38.1	.410	10.4	1.215	30.9	1.220	31.0	1.080	27.4	.780	19.8	.859	21.8	.154	3.9	2-56	.548	13.9	1.480	37.6	1.250	31.8	1.005	25.5
51-2	1.910	48.5	.370	9.4	1.615	41.0	1.220	31.0	1.510	38.4	.780	19.8	.859	21.8	.154	3.9	2-56	.548	13.9	1.480	37.6	1.250	31.8	1.005	25.5
67	2.310	58.7	.370	9.4	2.015	51.2	1.220	31.0	1.880	47.8	.780	19.8	.859	21.8	.154	3.9	2-56	.548	13.9	1.480	37.6	1.250	31.8	1.005	25.5
69	1.810	46.0	.410	10.4	1.515	38.5	1.220	31.0	1.380	35.1	.780	19.8	.859	21.8	.154	3.9	2-56	.548	13.9	1.480	37.6	1.250	31.8	1.005	25.5
75	2.140	54.4	.410	10.4	1.705	43.3	1.220	31.0	1.470	37.3	.780	19.8	.859	21.8	.184	4.7	4-40	.548	13.9	1.480	37.6	1.250	31.8	1.005	25.5
100	2.235	56.8	.460	11.7	1.800	45.7	1.280	32.5	1.470	37.3	.840	21.3	1.014	25.8	.184	4.7	4-40	.687	17.4	1.580	40.1	1.320	33.5	1.080	27.4
130	2.595	65.9	.460	11.7	2.160	54.6	1.280	32.5	1.830	46.5	.840	21.3	1.014	25.8	.184	4.7	4-40	.687	17.4	1.580	40.1	1.320	33.5	1.080	27.4

MAXIMUM ENTRY SIZE

Shell Size	Top T	Side S	45° E	Dual 45° D
09	09	09	08	06
15	10	12	08	08
21	10	12	08	08
25	10	12	08	08
31	10	12	09	09
37	10	12	09	09
51	10	12	10	10
51-2	10	12	09	09
67	10	12	09	09
69	10	12	10	10
75	10	12	10	10
100	12	12	12	12
130	12	12	12	12

SCREWLOCKS AND JACKSCREWS

CLIP
CLIP HAS CIRCULAR HOLE AND SQUARE HOLE.

SCREWLOCK
SQUARE HOLE IS ON THE TOP. SCREW IS FLOATING. MATE CONNECTORS FIRST, THEN FASTEN SCREWLOCKS.

JACKSCREW
SQUARE HOLE IS ON THE BOTTOM. SCREW IS CAPTIVE. TURN SCREWS TO JACK CONNECTORS TOGETHER.

BAND OPTIONS

Terminate cable braid to backshell with optional band strap and banding tool. Pre-coiled bands are passivated stainless steel. Slim Standard bands have reduced thickness for weight reduction. Micro Slim bands have reduced thickness for weight reduction. Micro-Max bands are high-tension for lower-resistivity termination.

Band Type and Width	Hand Tool	Pneumatic
Standard: .24 (6.1)	601-100	601-106
Slim Standard: .24 (6.1)	601-109	601-110
Micro: .12 (3.0)	601-101	601-107
Micro Slim: .12 (3.0)	601-122	601-123
Micro-Max: .12 (3.0)	601-129	601-118