

SPACE-GRADE MICRO-D BACKSHELLS Environmental Protective Cover with Lanyard Attachment Options



500-107



How To Order	
Sample Part Number	500-107 M 25 P B N 6 -01
Series	500-107 Protective Cover
Shell Finish	M – Electroless Nickel Z2 – Gold
Size / Layout Code	See Table I
Style	P – Plug cover R – Receptacle cover
Hardware Option	B – No hardware P – Female Jackpost M – Hexhead Jackscrew S – Slotted jackcrew M1 – Extended hexhead Jackscrew S1 – Extended slotted Jackscrew L – Hexhead non-removable Jackscrew K – Extended non-removable Jackscrew
Lanyard Attachment	F – Wire rope, Nylon jacket H – Wire rope, Teflon jacket R – Wire rope, PVC jacket T – Wire rope, no jacket G – Flexible Nylon rope N – no attachment NB – No lanyard or attachment boss Attachment to withstand 25 lb. min. pull test
Attachment Length	in inches
Attachment Ring Diameter	See Table II

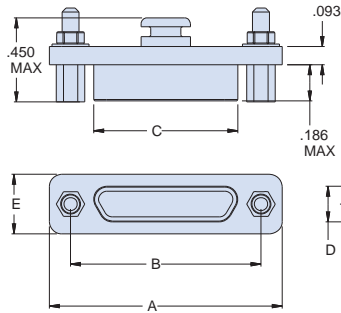

STYLE R
DUST COVER FOR RECEPTACLE

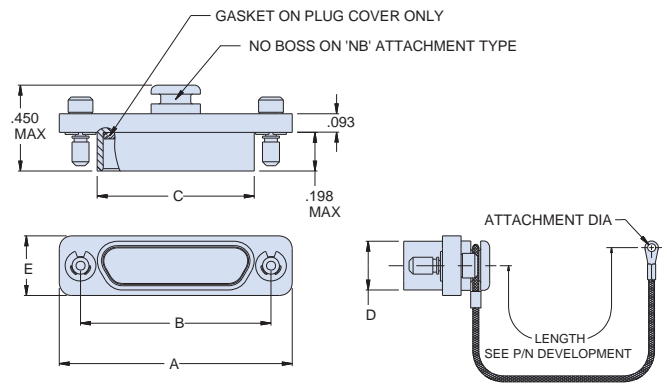

STYLE P
DUST COVER FOR PLUG

Dash No.	Attachment Dia. ±.005 (.13)
01	.145 (3.68)
02	.182 (4.62)
03	.191 (4.85)
04	.197 (5.00)
05	.167 (4.24)
06	.125 (3.18)

MATERIALS

Backshell: Aluminum alloy
Hardware: CRES / passivated
Gasket: Silicone

SPACE-GRADE MICRO-D BACKSHELLS Environmental Protective Cover with Lanyard Attachment Options

500-107



MICRO-D

Table I Layout and Dimensions					
Layout	A Max	B ±.003 (.08)	C Max	D Max	E Max
9R	.785 (19.94)	.565 (14.35)	.333 (8.46)	.184 (4.67)	.308 (7.82)
9P	.785 (19.94)	.565 (14.35)	.400 (10.16)	.250 (6.35)	.308 (7.82)
15R	.935 (23.75)	.715 (18.16)	.483 (12.27)	.184 (4.67)	.308 (7.82)
15P	.935 (23.75)	.715 (18.16)	.551 (14.00)	.250 (6.35)	.308 (7.82)
21R	1.085 (27.56)	.865 (21.97)	.633 (16.08)	.184 (4.67)	.308 (7.82)
21P	1.085 (27.56)	.865 (21.97)	.701 (17.81)	.250 (6.35)	.308 (7.82)
25R	1.185 (30.10)	.965 (24.51)	.733 (18.62)	.184 (4.67)	.308 (7.82)
25P	1.185 (30.10)	.965 (24.51)	.801 (20.35)	.250 (6.35)	.308 (7.82)
31R	1.335 (33.91)	1.115 (28.32)	.883 (22.43)	.184 (4.67)	.308 (7.82)
31P	1.335 (33.91)	1.115 (28.32)	.951 (24.16)	.250 (6.35)	.308 (7.82)
37R	1.485 (37.72)	1.265 (32.13)	1.033 (26.24)	.184 (4.67)	.308 (7.82)
37P	1.485 (37.72)	1.265 (32.13)	1.101 (27.97)	.250 (6.35)	.308 (7.82)
51R	1.435 (36.45)	1.215 (30.86)	.983 (24.97)	.228 (5.79)	.351 (8.92)
51P	1.435 (36.45)	1.215 (30.86)	1.051 (26.70)	.296 (7.52)	.351 (8.92)
51-2R*	1.835 (46.61)	1.615 (41.02)	1.384 (35.15)	.184 (4.67)	.308 (7.82)
51-2P*	1.835 (46.61)	1.615 (41.02)	1.450 (36.83)	.250 (6.35)	.308 (7.82)
67R*	2.235 (56.77)	2.015 (51.18)	1.784 (45.31)	.184 (4.67)	.310 (7.87)
67P*	2.235 (56.77)	2.015 (51.18)	1.850 (46.99)	.250 (6.35)	.310 (7.87)
69R**	1.735 (44.07)	1.515 (38.48)	1.284 (32.61)	.228 (5.79)	.351 (8.92)
69P**	1.735 (44.07)	1.515 (38.48)	1.350 (34.29)	.296 (7.52)	.351 (8.92)
75R	2.080 (52.83)	1.705 (43.31)	1.384 (35.15)	.228 (5.79)	.351 (8.92)
75P	2.080 (52.83)	1.705 (43.31)	1.450 (36.83)	.296 (7.52)	.351 (8.92)
100R	2.170 (55.12)	1.800 (45.72)	1.383 (35.13)	.270 (6.86)	.394 (10.01)
100P	2.170 (55.12)	1.800 (45.72)	1.451 (36.86)	.333 (8.46)	.394 (10.01)
130R	2.520 (64.01)	2.160 (54.86)	1.735 (44.07)	.270 (6.86)	.394 (10.01)
130P	2.520 (64.01)	2.160 (54.86)	1.795 (45.59)	.333 (8.46)	.394 (10.01)

*51-2 and 67 Layouts are for a special 2-row Micro-D connector
**69 Layouts are for a special 3-row Micro-D connector