

# BACKSHELLS AND ACCESSORIES FOR AS81703 SERIES 3 TYPE CONNECTORS

## 90° Strain Relief

### AS85049/120



<b>Product Series and Basic Part Number</b>	<b>Dash No.</b> <i>Table I</i>	<b>Finish</b> <i>Table II</i>
<b>M85049/120</b>	<b>S</b> <b>08</b>	<b>W</b>

**S** = Detented Self-Locking  
**N** = Non-Detented Self-Locking  
 Use Dash (-) for Non-Self-Locking

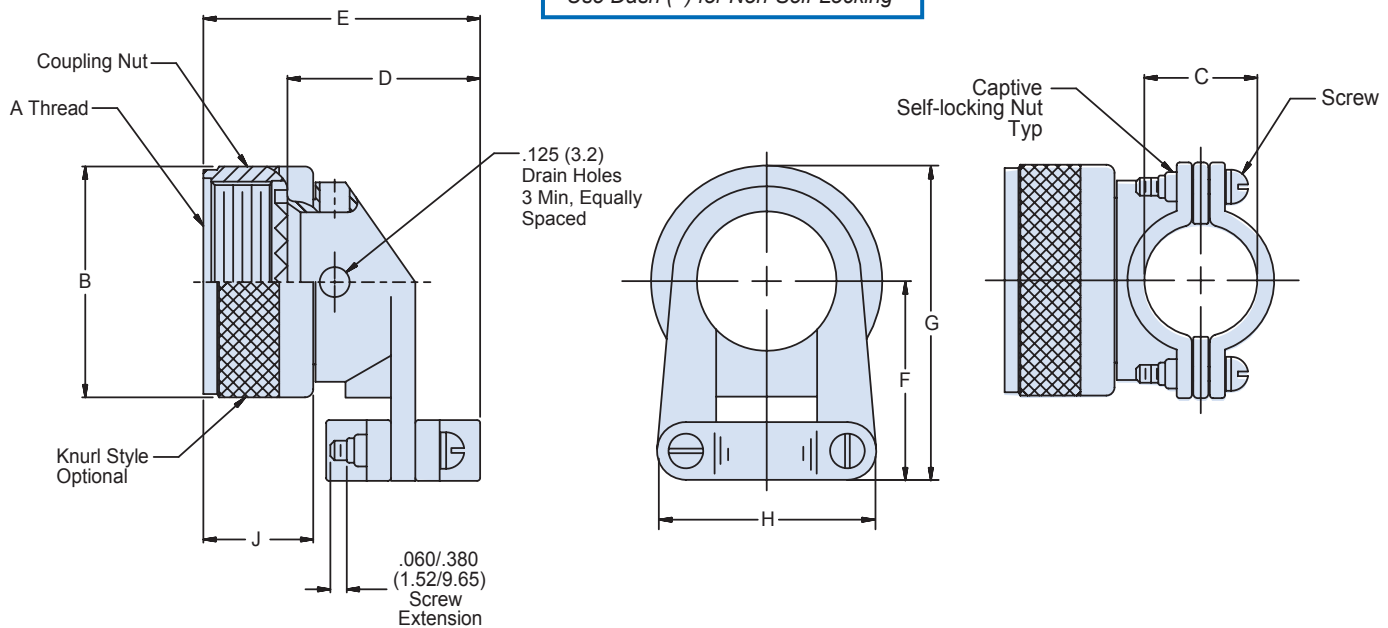

Dash No.	Screw Size	Shell Size	A Thread Class 2B	B Dia Max	C Dim ± .031 (0.8)	D Max	E Max Length	F Dim Max	G Dim Max	H Dim Max	J Dim Max
03	4-40	3	9/16-24 UNEF	.95 (24.1)	.219 (5.6)	.93 (23.6)	1.29 (32.8)	.84 (21.3)	1.32 (33.5)	.88 (22.4)	.710 (18.0)
12	4-40	7	3/4-20 UNEF	1.14 (29.0)	.344 (8.7)	1.21 (30.7)	1.57 (39.9)	.93 (23.6)	1.50 (38.1)	1.12 (28.4)	.710 (18.0)
14	4-40	12	7/8-20 UNEF	1.26 (32.0)	.460 (11.7)	1.27 (32.3)	1.63 (41.4)	1.00 (25.4)	1.62 (41.4)	1.19 (30.2)	.710 (18.0)
16	4-40	19	1-20 UNEF	1.39 (35.3)	.545 (13.8)	1.42 (36.1)	1.78 (45.2)	1.06 (26.9)	1.75 (44.5)	1.44 (36.6)	.710 (18.0)
18	6-32	27	1 1/16-18 UNEF	1.51 (38.4)	.615 (15.6)	1.53 (38.9)	1.89 (48.0)	1.23 (31.2)	1.99 (50.5)	1.56 (39.6)	.710 (18.0)
20	6-32	37	1 3/16-18 UNEF	1.64 (41.7)	.698 (17.7)	1.65 (41.9)	2.01 (51.1)	1.30 (33.0)	2.07 (52.6)	1.69 (42.9)	.710 (18.0)
61	8-32	61	1 1/2-18 UNEF	1.95 (49.5)	.850 (21.6)	1.90 (48.3)	2.26 (57.4)	1.45 (36.8)	2.43 (61.7)	1.88 (47.8)	.710 (18.0)

Sym.	Material	Finish
A	Aluminum Alloy	Black Anodize
N		Electroless Nickel
W		Cadmium, Olive Drab
X		Nickel Fluorocarbon Polymer
Z		Zinc Nickel

#### NOTES

- Glenair Series 600 Backshell Assembly Tools are recommended for assembly and installation.
- Cable entry is measured with saddle bars closed and bottomed on clamp ears.
- Material/Finish:  
 Clamp body, coupling nut, saddles - Al alloy or 300 Series SST/See Table II.  
 Clamp screws and lock nuts - CRES/Passivated, Silver plate optional.  
 Anti-rotation device - Corrosion resistant material

