



# STAR-PAN™ X BASE STATION



## Ten-port power/data hub with MISSION MANAGER

Optimized for vehicle, helicopter, or vessel mounting, STAR-PAN X Base Station enhances soldier situational awareness with real-time TAK Server access to Battlefield Management System data, while at the same time charging soldier system batteries. STAR-PAN X Base Station incorporates an embedded MISSION MANAGER with upgraded processing power. STAR-PAN X Base Station uses the same NATO standard interconnect interface as soldier-worn STAR-PAN systems.

### SPECIFICATIONS

#### KEY FEATURES/BENEFITS

- Provide Battery Power and VBUS power to up to 10 USB peripheral devices simultaneously
- Heat-efficient electronics packaging for optimal efficiency and extended battery life
- Auxiliary power ports for long-length missions or hot swappable BB2590 batteries
- SMBUS, USB2.0 (Full and High Speed), USB1.1 compatible interface, USB 3.0 Super Speed, Gigabit Ethernet, HDMI output, 5Gb/s support
- Standard Personal Area Network (PAN) pin configuration, smart battery interface, Direct Current Power Source (DCPS)
- Overvoltage, overcurrent, short circuit protection and SMBus capability
- SPOC compatible
- Environmentally sealed

- PAN ports for up to ten devices
- HDMI and Ethernet ports
- Integrated MISSION MANAGER functionality
- Two USB 3.0 ports
- 5Gb/s data transmission
- Two battery and one auxiliary power source inputs
- Glenair power port management
- Smart battery charging from auxiliary power
- Up to 5A battery power per port, 20A system total
- Up to 2A 5 Volt VBUS power per port, 10A across all ports
- Precision-machined construction, integrated connectors

# BATTLE-TESTED STAR-PAN™ X Base Station



## Hubs and Accessories

### TS8-462 10-Port Smart Power and Data Base Station Hub

## HUBS AND ACCESSORIES

#### HOW TO ORDER

##### Part Number:

**TS8-462**

##### Connectorized Hub

STAR-PAN X Base Station 10-port power/data hub

#### PERFORMANCE SPECIFICATIONS

Operating Conditions	
Operating Temperature	-40°C to +60°C
Storage Temperature	-40°C to +80°C
Operation Altitude	40,000 ft.
Pan 1-10	
Battery Voltage	10.0V to 20.0V
Battery Supply Current	5A Maximum per individual port
Total VBATT Output Current	20A
Auxiliary Power Supply Port	
Auxiliary Voltage Source	10V to 36V
Auxiliary Input Current	20A maximum
Battery Port	
Battery Input Voltage	20V to 36V, 28V typical
Battery Input Current	10A maximum
Battery Charge Current	5A maximum

#### BASE STATION X CABLE PART NUMBERS

BB2590 Charging Adapter for STAR-PAN X	<b>TS8-554</b>
BB2590* Battery Cable Adapter	<b>TS8-496</b>
BB2590 Battery Cable Adapter With Enclosed EMI Box	<b>TS8-496-1</b>
AC Pwr Supply Cable Adapter	<b>TS8-497</b>
USB 3.0 Cable Assembly	<b>TS1-039</b>
Cat 5e Ethernet Cable	<b>TS1-040</b>
HDMI Type A Cable Assembly	<b>TS1-041</b>
USB Flash drive	<b>TS3-001</b>
General-Purpose Extension Cable	<b>808-047</b>
BATT Port Adapter Cable	<b>TS1-100</b>
Plug-to-AUX Port Adapter Cable	<b>TS1-090</b>
Plug-to-BATT Port Adapter Cable	<b>TS1-092</b>
TS2-030 to STAR-PAN X Cable Assembly	<b>TS1-121</b>

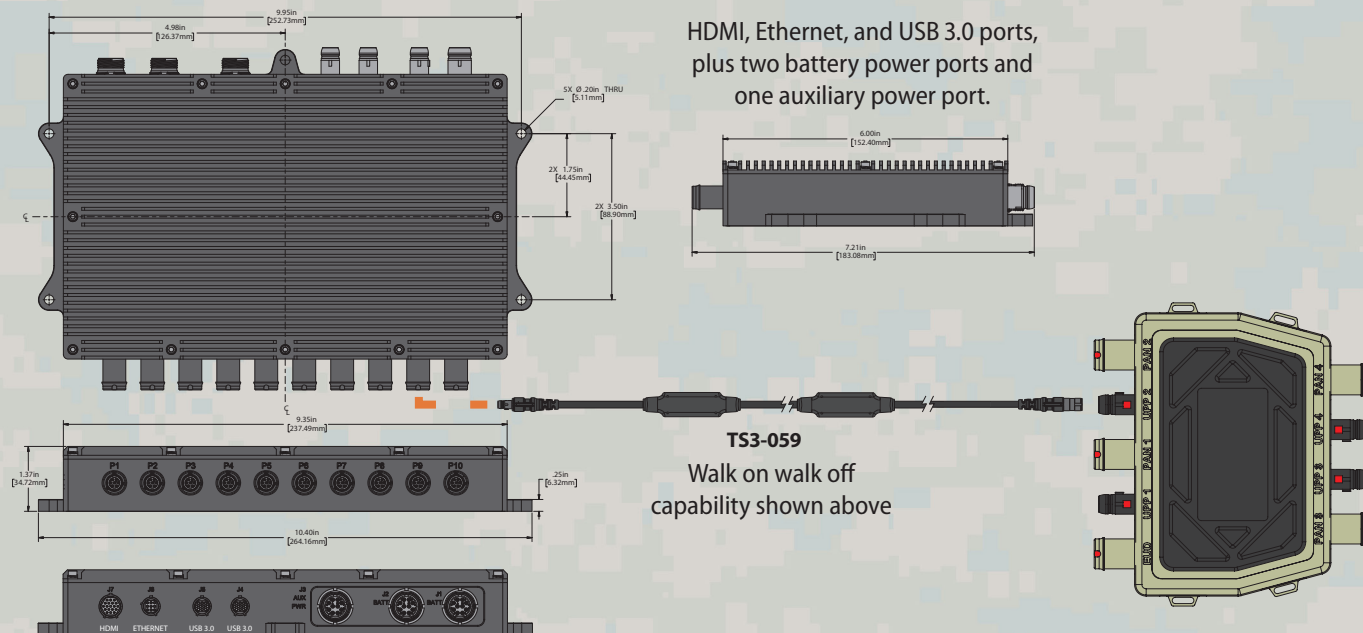



BATTLE-TESTED

# STAR-PAN™ X Base Station



## Hubs and Accessories

### TS8-462 10-Port Smart Power and Data Base Station Hub

#### HUBS AND ACCESSORIES

#### OVERVIEW

STAR-PAN X 10-Port Base Station is a multi-port data and power hub for platform-based CSISR integration. STAR-PAN X 10-port Base Station provides the same NATO standard interconnect interface as soldier-worn STAR-PAN systems, making it completely interoperable with the existing portfolio of cables and adapters, and allowing easy soldier interconnection to the platform's data and power network. The unit incorporates an embedded MISSION MANAGER with upgraded processing power. STAR-PAN X has various industry standard interfaces and the ability to run on external battery power. This gives it an ad hoc Walk on/Walk off integration capability without the need to dramatically impact or change the platform's data or power architecture. Dismounted soldiers can connect to the vehicle power and data accessing on-board radios and sensors via a single cable connection.

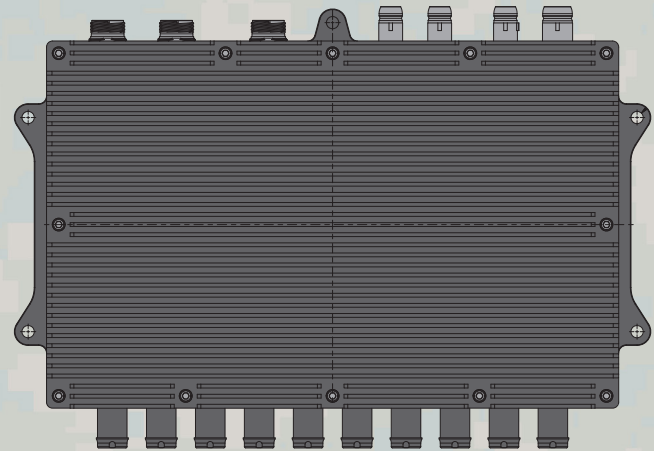

TS1-009

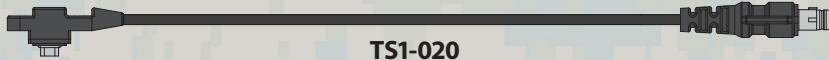

TS1-020



TS8-482

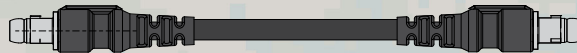

808-080

TS1-062



TS3-045



808-088

# BATTLE-TESTED STAR-PAN™ X Base Station



## Hubs and Accessories TS8-462 10-Port Smart Power and Data Base Station Hub

Power — — —  
Data — — —  
Data + Power — — —

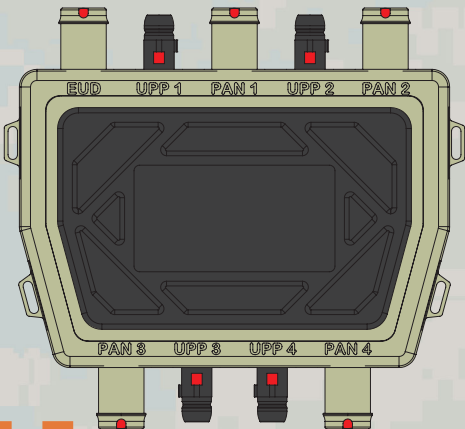

### STAR-PAN NG TECHNOLOGY ILLUSTRATED IN THIS CAPABILITY DIAGRAM

STAR-PAN NG Component Description	Part Number
AN/PRC-163 Radio Adapter with Red/Black Switch	TS8-480
Cable Assembly, 7 Pin Back-to-back Radio-Battery Adapter	TS1-062
NG Universal Radio Power Booster	TS3-045
USB-C to Mighty Mouse Plug, Juggernaut OPRTR Case	TS1-020
AN/PRC-117G PAN Port Radio Cable	808-088
AN/PRC-161 Radio Side Connector	TS8-482
Radio Adapter Cable	808-080
USB-C Charge Adapter	TS1-009

HUBS AND ACCESSORIES

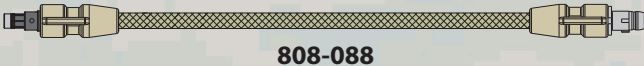
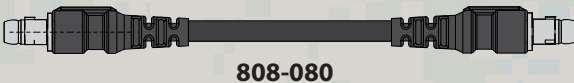

### TS8-462 APPLICATIONS



Aircraft



Vehicle



Watercraft