

MIL-DTL-38999 Series I Type
 600-117 Jam nut wrench for connectors

BACKSHELLS AND ACCESSORIES



600-117

HOW TO ORDER		
Sample Part Number	600-117	02
Basic Part Number	Jam Nut Wrench for Connectors	
Dash No.	See Table I	

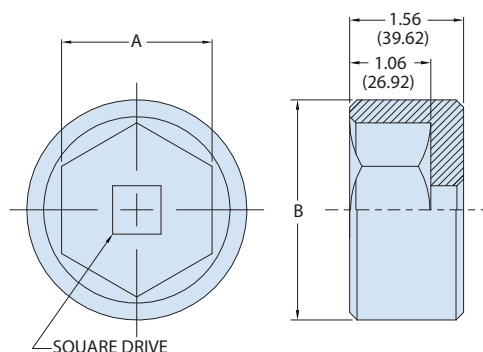

CONNECTOR FEATURES

- Material/Finish:
Jam Nut Wrench - Steel/Nickel Plate

TABLE I					
Dash No.	A Dim Fits Jam Nut Size: Inches	A Dim Fits Jam Nut Size: Millimeters	B DIA Ref	Square Drive	For Connector Shell Size (REF) MIL-DTL -38999 Series I
1	.693 to .717	17.60 to 18.21	1.04	1/4"	
2	.765 to .791	19.43 to 20.09	1.13	1/4"	
3	.818 to .845	20.77 to 21.46	1.19	1/4"	
4	.873 to .902	22.17 to 22.91	1.26	1/4"	9
5	.933 to .964	23.69 to 24.48	1.33	3/8"	
6	.996 to 1.030	25.29 to 26.16	1.41	3/8"	11
7	1.064 to 1.100	27.02 to 27.94	1.51	3/8"	
8	1.137 to 1.175	28.87 to 29.84	1.59	3/8"	
9	1.175 to 1.214	29.84 to 30.83	1.63	3/8"	13
10	1.297 to 1.340	32.94 to 34.03	1.78	3/8"	15
11	1.385 to 1.432	35.17 to 36.37	1.89	3/8"	
12	1.432 to 1.480	36.37 to 37.59	1.95	3/8"	17
13	1.529 to 1.580	38.83 to 40.13	2.06	3/8"	19
14	1.580 to 1.633	40.13 to 41.47	2.12	3/8"	
15	1.633 to 1.688	41.47 to 42.87	2.19	3/8"	
16	1.688 to 1.745	42.87 to 44.32	2.25	3/8"	21
17	1.803 to 1.864	45.79 to 47.34	2.39	3/8"	23
18	1.926 to 1.991	48.92 to 50.57	2.54	3/8"	
19	1.991 to 2.057	50.57 to 52.24	2.61	3/8"	25
20	2.126 to 2.197	54.00 to 55.80	2.78	3/8"	
21	2.197 to 2.271	55.80 to 57.68	2.87	3/8"	
22	2.347 to 2.426	59.61 to 61.62	3.04	3/8"	
23	2.507 to 2.591	63.67 to 65.81	3.24	3/8"	
24	2.678 to 2.769	68.02 to 70.33	3.44	3/8"	
25	2.956 to 3.055	75.08 to 77.59	3.77	3/8"	
26	3.180 to 3.280	80.77 to 83.31	4.04	3/8"	