

MIL-DTL-38999 Series III Type Environmental Connectors
Shielded PC tail contacts - PCB footprints

HIGH-SPEED CONNECTORS

SIZE 8 COAX CONTACT

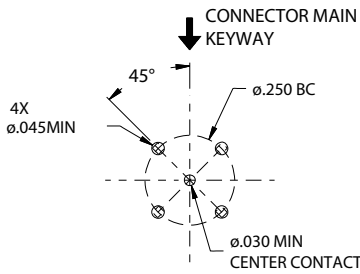

RECOMMENDED CO-AX PCB LAYOUT

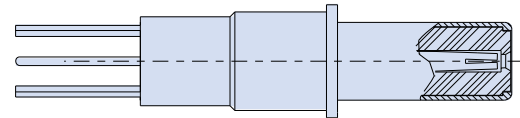
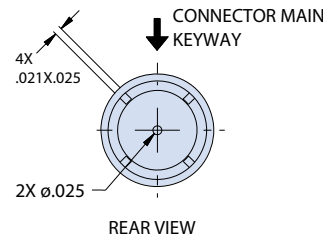

SIZE #8 CO-AX PIN, PC TAIL DETAIL
 C = INTERFACE PER M39029/60 (50 OHM)
 C1 = INTERFACE PER 852-056 (75 OHM)

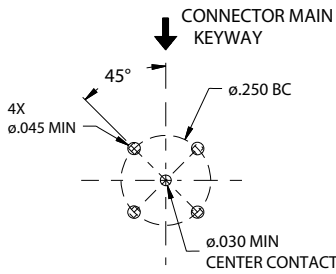

RECOMMENDED CO-AX PCB LAYOUT

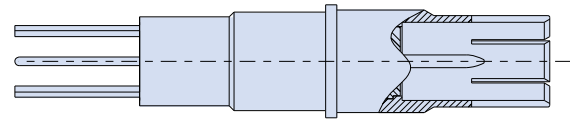
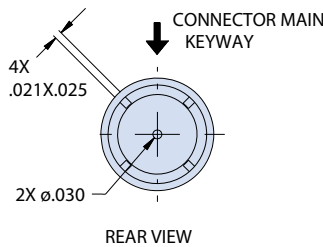

SIZE #8 CO-AX SOCKET, PC TAIL DETAIL
 C = INTERFACE PER M39029/59 (50 OHM)
 C1 = INTERFACE PER 852-057 (75 OHM)

SIZE 12 COAX CONTACT

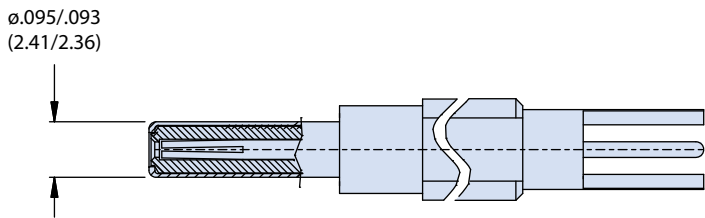

SIZE #12 COAX CONTACT PIN, PC TAIL DETAIL
 INTERFACE PER M39029/102

CONNECTOR MAIN KEYWAY

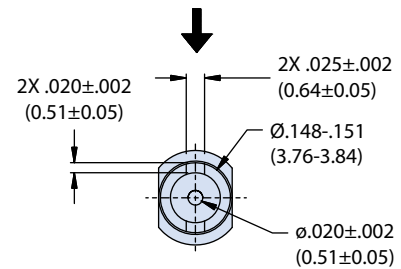

CONTACT REAR VIEW AND INTERFACE REQUIREMENTS

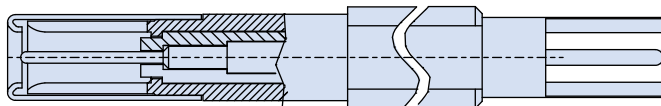

SIZE #12 COAX CONTACT SOCKET, PC TAIL DETAIL
 INTERFACE PER M39029/103

CONNECTOR MAIN KEYWAY

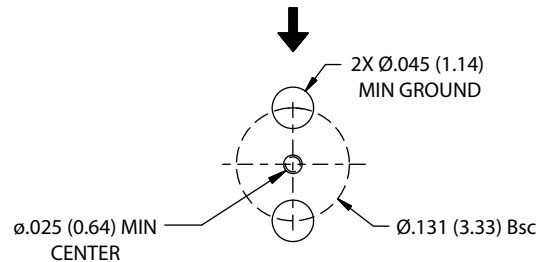

RECOMMENDED PCB FOOTPRINT

MIL-DTL-38999 Series III Type Environmental Connectors
Shielded PC tail contacts - PCB footprints

HIGH-SPEED CONNECTORS

DIFFERENTIAL TWINAX

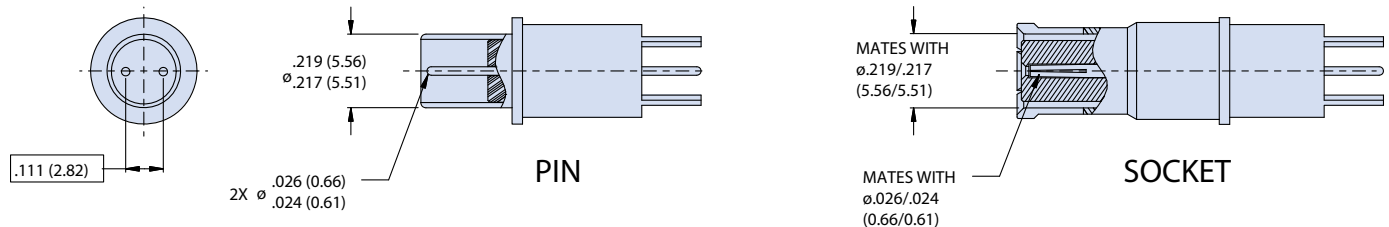

TWINAX CONTACT DETAILS

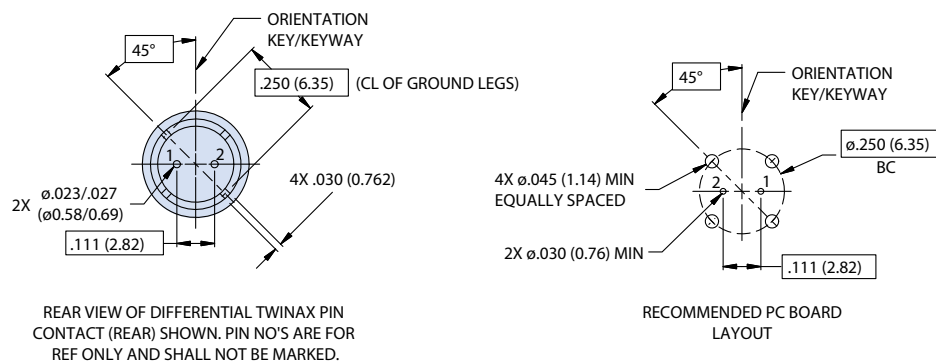

REAR VIEW OF DIFFERENTIAL TWINAX PIN CONTACT (REAR SHOWN. PIN NO'S ARE FOR REF ONLY AND SHALL NOT BE MARKED.)

RECOMMENDED PC BOARD LAYOUT

QUADRAX

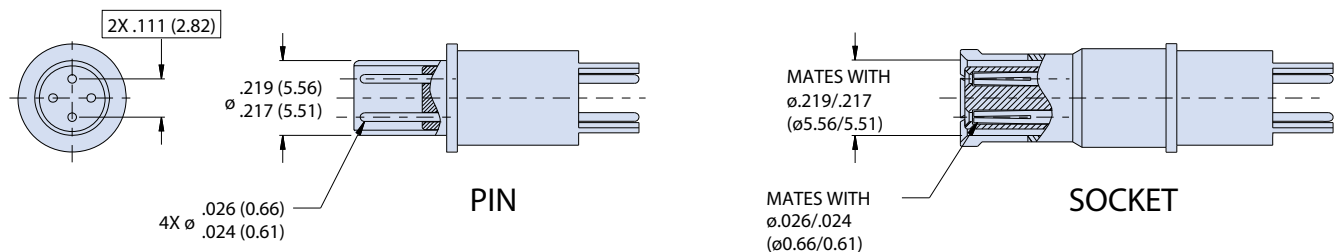

QUADRAX CONTACT DETAILS

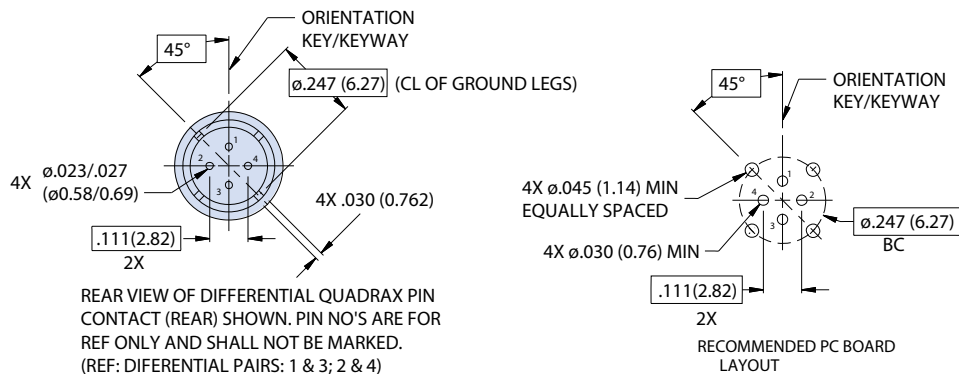

REAR VIEW OF DIFFERENTIAL QUADRAX PIN CONTACT (REAR SHOWN. PIN NO'S ARE FOR REF ONLY AND SHALL NOT BE MARKED. (REF: DIFFERENTIAL PAIRS: 1 & 3; 2 & 4)

RECOMMENDED PC BOARD LAYOUT

MIL-DTL-38999 Series III Type Environmental Connectors
Shielded PC tail contacts - dimensions and footprints

HIGH-SPEED CONNECTORS

CONCENTRIC TWINAX

CONCENTRIC TWINAX PIN

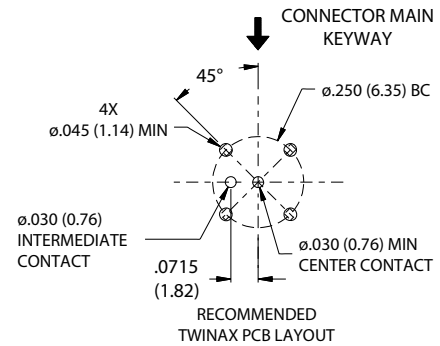
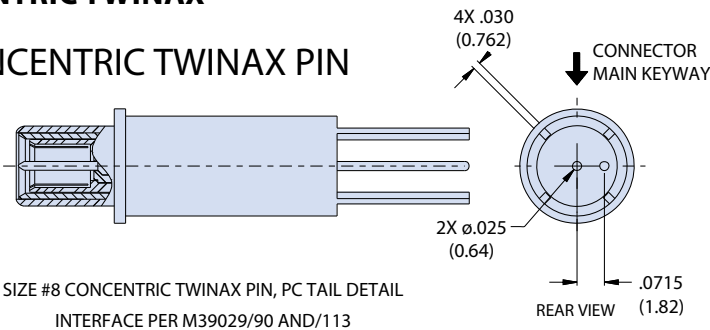

CONCENTRIC TWINAX SOCKET

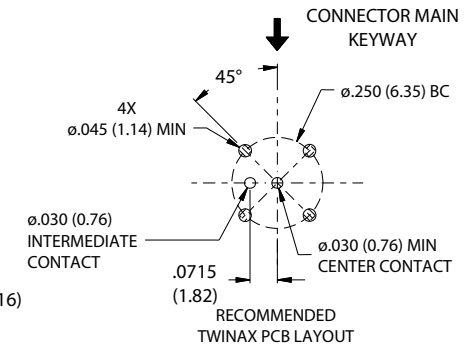
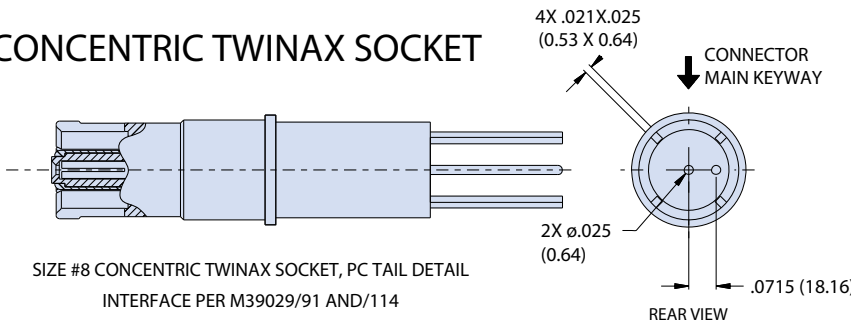

EL OCHITO®

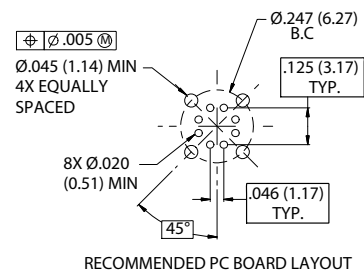
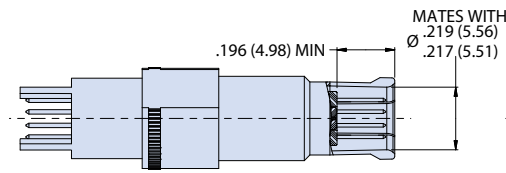
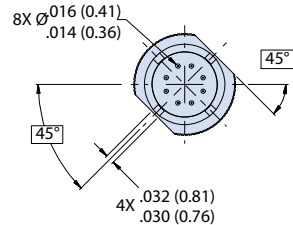
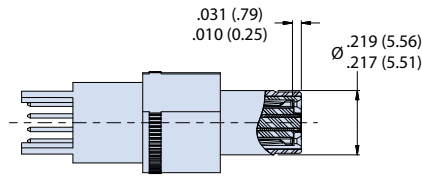
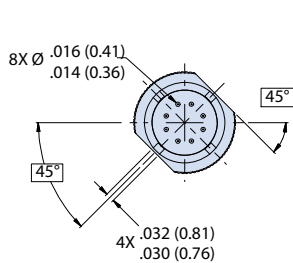

For optimal performance, see Glenair Application Note AN0002.