

MIL-DTL-38999 Series III Type Space-Grade Connectors

253-044 Fixed mount plug with roll off nose an crimp contacts

HIGH-SPEED SPACE-GRADE CONNECTORS

Part Number Development										
Sample Part Number	253-044 - 07 ME 25 - 8 A N -909CP									
Series / Basic Part No.	253-044 = Blind-mate Plug (fixed mount)									
Accessory Style	B = Integral Backshell - (Dash) = Accessory Thread									
Connector Style	L7 = Jam nut (locating pin) 00 = Wall mount rcpt; slotted holes 07 = Jam nut mount D0 = Wall mount rcpt; through holes									
Material/Finish	ME = Al, electroless nickel ZL = CRES, electrodeposited nickel MT = Al, nickel PTFE Z1 = CRES, passivated									
Shell Size	9 11 13 17 19 21 23 25									
Ground Option	G = Common ground - (dash) = None									
Insert Arrangement	Per MIL-STD-1560 plus custom layouts; symmetrical layouts only, consult factory for complete details									
Insert Designator	A = Pin insert, less contacts B = Socket insert, less contacts									
Alternate Polarization	A, B, C, D, E, N = Normal (Polarization for intermateability with 253-014 is per MIL-DTL-38999 Series I)									
Optional Mod Code	909** = See Mod Code specifications below									

*Refer to section A for complete details. Refer to Space-Grade Guidelines material (IAW NASA EEE INST-002) for outgassing and screening modification codes, on pages 80 and 81. Modification codes may be added directly to the end of any valid part number

Modification code 909xx is used to supply D38999 Series III Type connectors featuring crimp removable type contacts with high-speed contact kits. Kits include spares, tools, and sealing plugs. See example below.

253-044-07ME25-8AN -909 C P

- Basic Connector Part Number: 253-044-07ME25-8AN
- Basic Modification Code: 909
- Contact Type Symbol (See Contact Type Table): C, D, E*, Q, P, T
- Contact Gender (Optional): P = Pin, S = Skt

*For El Ochito see Contact Configuration Table on following page for appropriate code and dash number symbol.

FIGURE 2: REFERENCE ORIENTATION OF INNER PINS RELATIVE TO CONNECTOR MAIN KEY/KEYWAY

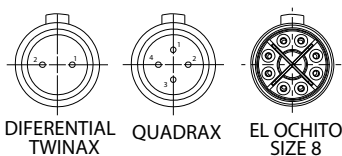

Contact Type					
Sym	Description	Glenair P/N	Wire Type	Grommet Follower	Application Notes
C	Size 16, contact for coax cable, per M39029/76 & /77;	Pin: 852-008-16-424 Skt: 852-009-16-428	RG174, RG316, RG179	N/A	Analog radio frequency or microwave applications
	Size 12, contact for coax cable, per M39029/102 & /103	Pin: 852-004-12-558 Skt: 852-005-12-559	RG174, RG316, RG179	N/A	
	Size 8, contact for coax cable, per M39029/59 & /60	Pin: 852-007-08-367 Skt: 852-006-08-366	M17 /95-RG180	859-042-02	
C1	Size 8, contact for 75 ohm coax cable	Pin: 852-056-01 Skt: 852-057-01	V73263, V75268, V76261	859-042-01	aerospace-grade digital video
D	Size 8, diff. twinax contact for 24 AWG twinax cable	Pin: 853-014-05 Skt: 853-013-05	M17 /176-00002	859-042-01	1553 databus / differential signal
E*	Size 8, El Ochito® contact for 26 AWG	White Pin: 858-003-02 Skt: 858-004-02	963-003-26 963-033-26	687-643-8-2	1G/10G Base-T Ethernet (white)
	Size 8, El Ochito® contact for 24/26-30 AWG Cable	Blue Pin: 858-028-02 Skt: 858-029-02	963-110 & 963-118	687-643-8-2	USB 3.0 (Blue)
	Size 8, El Ochito® contact for 26-30 AWG Cable	Red Pin: 858-030-02 Skt: 858-031-02	963-033-26	687-643-8-2	SATA 3.0 General High Speed (red)
Q	Size 8, contact for 24 AWG Quadrax	Pin: 854-001-02 Skt: 854-002-02	963-020	859-042-02	10/100Base-T ethernet
P	Size 8, power contact for 8 AWG	Pin: 850-014 Skt: 850-013	M22759/11 or equivalent	859-042-03	Power
T	Size 8, triax/ concentric twinax for twinax cable	Pin: 853-003-08-625 Skt: 853-004-08-628	M17 /176-00002	859-042-01	1553 Databus

* See Table II for Contact Positions. See Figure 2 for orientation of inner pins relative to connector main key/keyway.

MIL-DTL-38999 Series III Type Space-Grade Connectors

253-044 Fixed mount plug with roll off nose an crimp contacts

HIGH-SPEED SPACE-GRADE CONNECTORS

El Ochito Protocols		
WHITE	BLUE	RED
10GBASE-T	USB 3.0	Multi Gigabit 100 ohm protocols HDMI, SATA, DisplayPort



Example Code E7



Example Code E5

PANEL TO PANEL DIMENSIONS

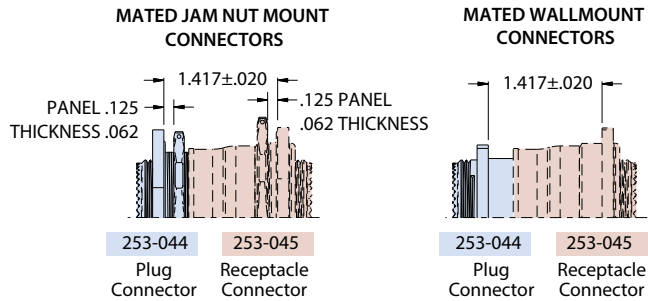

NOTES:

- Glenair 253-044 is designed to mate with 253-045 with same insert arrangement and polarization
- Stainless steel locating pin to be shipped with L7 jam-nut connector
- Misalignment capabilities are possible with 253-044, when mated to 253-045.
- See page 80 for outgassing options
- 253-044 connectors are rear panel mount only. Panel to panel dimensions the same for all configurations. Tolerance as shown
- See page 80 for outgassing options
- Material/finish
 - Shell, jam-nut: see P/N development, finish
 - Insulator: high grade rigid dielectric/N.A.
 - Seals: fluorosilicone blend/N.A.
 - Contacts: copper alloy/gold plated

El Ochito Contact Configuration								
SYM	CAVITY A	CAVITY B	CAVITY C	CAVITY D	CAVITY E	CAVITY F	CAVITY G	CAVITY H
E	W	W	W	W	W	W	W	W
E2	B	W	W	W	W	W	W	W
E3	R	W	W	W	W	W	W	W
E4	B	B	W	W	W	W	W	W
E5	R	B	W	W	W	W	W	W
E6	R	R	W	W	W	W	W	W
E7	B	B	B	W	W	W	W	W
E8	R	B	B	W	W	W	W	W
E9	R	R	B	W	W	W	W	W
E10	R	R	R	W	W	W	W	W
E11	B	B	B	B	W	W	W	W
E12	R	B	B	B	W	W	W	W
E13	R	R	B	B	W	W	W	W
E14	R	R	R	B	W	W	W	W
E15	R	R	R	R	W	W	W	W
E16	B	B	B	B	B	W	W	W
E17	R	B	B	B	B	W	W	W
E18	R	R	B	B	B	W	W	W
E19	R	R	R	B	B	W	W	W
E20	R	R	R	R	B	W	W	W
E21	R	R	R	R	R	W	W	W
E22	B	B	B	B	B	B	W	W
E23	R	B	B	B	B	B	W	W
E24	R	R	B	B	B	B	W	W
E25	R	R	R	B	B	B	W	W
E26	R	R	R	R	B	B	W	W
E27	R	R	R	R	R	B	W	W
E28	R	R	R	R	R	R	W	W
E29	B	B	B	B	B	B	B	W
E30	R	B	B	B	B	B	B	W
E31	R	R	B	B	B	B	B	W
E32	R	R	R	B	B	B	B	W
E33	R	R	R	R	B	B	B	W
E34	R	R	R	R	R	B	B	W
E35	R	R	R	R	R	R	B	W
E36	R	R	R	R	R	R	R	W
E37	B	B	B	B	B	B	B	B
E38	R	B	B	B	B	B	B	B
E39	R	R	B	B	B	B	B	B
E40	R	R	R	B	B	B	B	B
E41	R	R	R	R	B	B	B	B
E42	R	R	R	R	R	B	B	B
E43	R	R	R	R	R	R	B	B
E44	R	R	R	R	R	R	R	B
E45	R	R	R	R	R	R	R	R

253-044-L7 JAM-NUT MOUNT PLUG WITH LOCATING PIN, ROLL-ON/ROLL-OFF NOSE, ACCESSORY THREADS AND SIZE 8 HIGH-SPEED CONTACTS

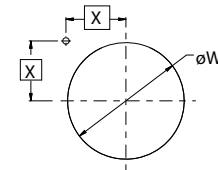
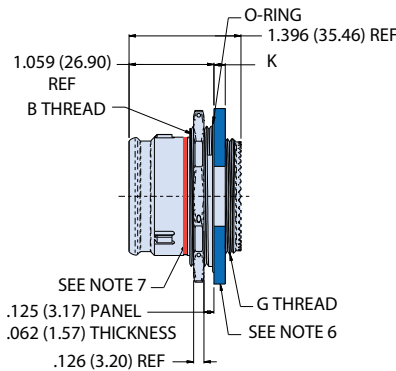
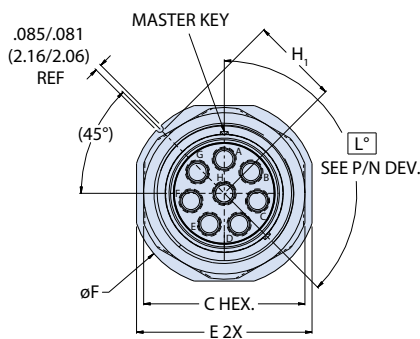

RECOMMENDED PANEL CUT OUT FOR JAM NUT PLUG, LOCATING PIN

253-044-07 JAM-NUT MOUNT PLUG WITH ROLL-ON/ROLL-OFF NOSE, ACCESSORY THREADS AND SIZE 8 HIGH-SPEED CONTACTS

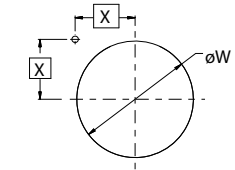
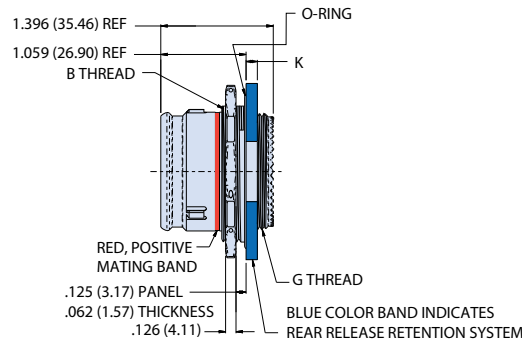
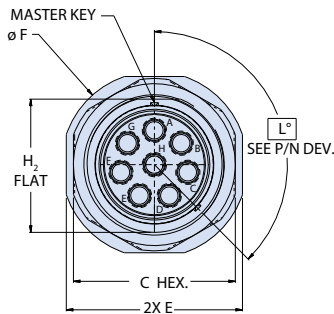

RECOMMENDED PANEL CUT OUT FOR JAM NUT PLUG, LOCATING PIN

Plug, Jam Nut Mount L7 (Locating Pin) and 07 (Standard)

Shell Size	B Thread Class 2A	C ±.015	E ±.015	ø F	H ₁ +.000/-0.008	H ₂ Flat +.000/-0.006	G Thread UNEF Class 2A	K Flange Thickness	Panel Cut-out	
									øW +.010/0.000	X
11	.8125-20 UNEF	1.010 (25.65)	1.250 (31.75)	1.386 (35.20)	0.604 (15.34)	0.754 (19.15)	.5625-24	0.109 (2.77)	0.823 (20.90)	0.460 (11.68)
13	1.0000-20 UNEF	1.175 (29.85)	1.375 (34.92)	1.511 (38.38)	0.666 (16.92)	0.936 (23.77)	.6875-24	0.109 (2.77)	1.010 (25.65)	0.504 (12.80)
15	1.1250-18 UNEF	1.294 (32.87)	1.500 (38.10)	1.636 (41.55)	0.729 (18.52)	1.066 (27.08)	.8125-20	0.109 (2.77)	1.135 (28.83)	0.549 (13.94)
17	1.2500-18 UNEF	1.451 (36.86)	1.625 (41.28)	1.761 (44.73)	0.791 (20.09)	1.191 (30.25)	.9375-20	0.109 (2.77)	1.260 (32.00)	0.593 (15.06)
19	1.3750-18 UNEF	1.569 (39.85)	1.812 (46.02)	1.949 (49.50)	0.893 (22.68)	1.316 (33.43)	1.0625-18	0.140 (3.56)	1.385 (35.18)	0.665 (16.89)
21	1.5000-18 UNEF	1.687 (42.85)	1.938 (49.23)	2.073 (52.65)	0.955 (24.26)	1.441 (36.60)	1.1875-18	0.140 (3.56)	1.510 (38.35)	0.709 (18.01)
23	1.6250-18 UNEF	1.875 (47.63)	2.062 (52.37)	2.200 (55.88)	1.017 (25.83)	1.566 (39.78)	1.3125-18	0.140 (3.56)	1.635 (41.53)	0.753 (19.13)
25	1.7500-18 UNS	2.010 (51.05)	2.187 (55.55)	2.323 (59.00)	1.096 (27.84)	1.691 (42.95)	1.4375-18	0.140 (3.56)	1.760 (44.70)	0.806 (20.47)

MIL-DTL-38999 Series III Type Space-Grade Connectors

253-044 Fixed mount plug with roll off nose an crimp contacts

HIGH-SPEED SPACE-GRADE CONNECTORS

253-044-00 WALL MOUNT MOUNT PLUG WITH SLOTTED HOLLS, ROLL-ON/ROLL-OFF NOSE, ACCESSORY THREADS AND SIZE 8 HIGH-SPEED CONTACTS

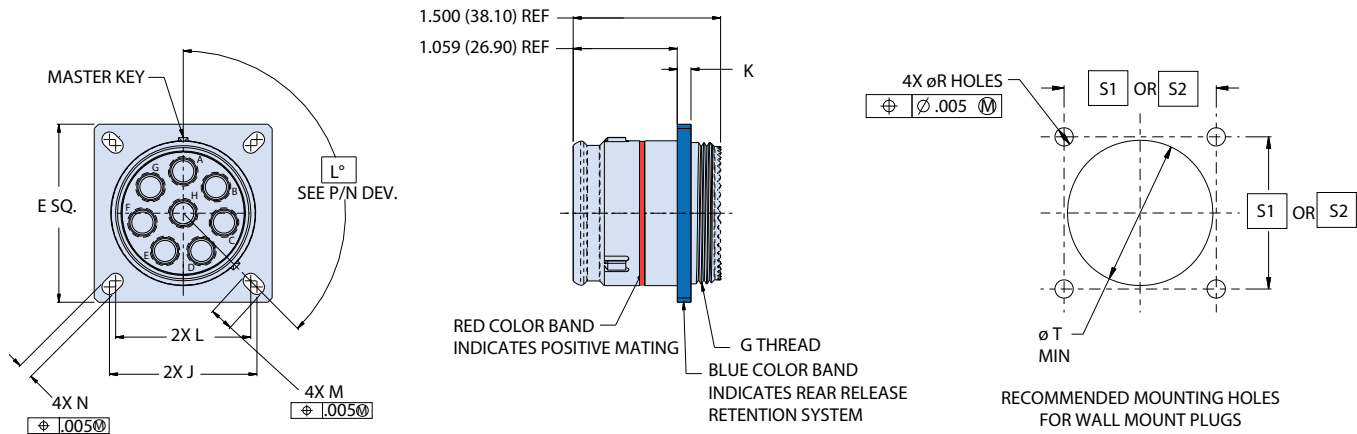

253-044-D0 WALL MOUNT MOUNT PLUG WITH SLOTTED HOLLS, ROLL-ON/ROLL-OFF NOSE, ACCESSORY THREADS AND SIZE 8 HIGH-SPEED CONTACTS

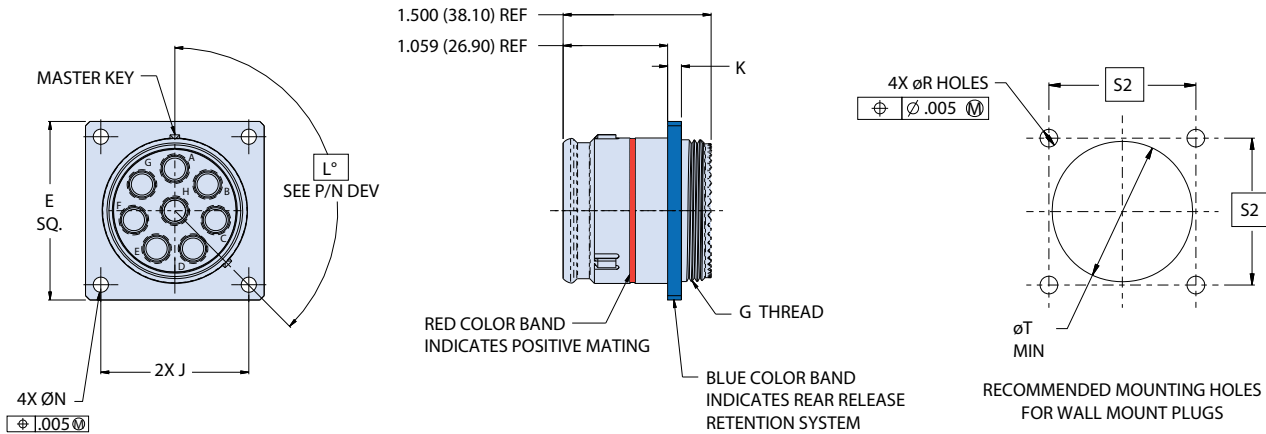

Shell Size	Wall Mount Plug with Slotted Holes and Round Holes										
	E	L	J	M	N	G Thd UNEF Class 2A	Flange Thickness	Panel Mount			
								S1	S2	T Dia.	R Dia.
11	1.031 (26.19)	0.719 (18.26)	0.812 (20.62)	0.194 (4.93)	0.128 (3.25)	.5625-24	0.109 (2.77)	0.719 (18.26)	0.812 (20.62)	0.718 (18.24)	0.133 (3.38) 0.123 (3.12)
13	1.126 (28.60)	0.812 (20.62)	0.906 (23.01)	0.194 (4.93)	0.128 (3.25)	.6875-24	0.109 (2.77)	0.812 (20.62)	0.906 (23.01)	0.844 (21.44)	
15	1.220 (30.99)	0.906 (23.01)	0.969 (24.61)	0.173 (4.39)	0.128 (3.25)	.8125-20	0.109 (2.77)	0.906 (23.01)	0.969 (24.61)	0.968 (24.59)	
17	1.311 (33.30)	0.969 (24.61)	1.062 (26.97)	0.194 (4.93)	0.128 (3.25)	.9375-20	0.109 (2.77)	0.969 (24.61)	1.062 (26.97)	1.096 (27.84)	
19	1.437 (36.50)	1.062 (26.97)	1.156 (29.36)	0.194 (4.93)	0.128 (3.25)	1.0625-18	0.140 (3.56)	1.062 (26.97)	1.156 (29.36)	1.222 (31.04)	
21	1.563 (39.70)	1.156 (29.36)	1.250 (31.75)	0.194 (4.93)	0.128 (3.25)	1.1875-18	0.140 (3.56)	1.156 (29.36)	1.250 (31.75)	1.344 (34.14)	
23	1.689 (42.90)	1.250 (31.75)	1.375 (34.92)	0.242 (6.15)	0.154 (3.91)	1.3125-18	0.140 (3.56)	1.250 (31.75)	1.375 (34.92)	1.468 (37.29)	0.159 (4.04) 0.149 (3.78)
25	1.811 (46.00)	1.375 (34.92)	1.500 (38.10)	0.242 (6.15)	0.154 (3.91)	1.4375-18	0.140 (3.56)	1.375 (34.92)	1.500 (38.10)	1.594 (40.49)	0.155 (3.94) 0.145 (3.68)

Part Number Development											
Sample Part Number	253-045 - 07 ME 25 - 8 A N NS -909CP										
Series / Basic Part No.	253-045 = Blind-mate receptacle (float mnt)										
Accessory Style	B = Integral Backshell - (Dash) = Accessory Thread										
Connector Style	L7 = Jam nut (locating pin) 00 = Wall mount rcpt; slotted holes 07 = Jam nut mount (flat thread) D0 = Wall mount rcpt; through holes										
Material/Finish	ME = Alum./electroless nickel MT = Alum./nickel PTFE ZL = CRES/electrodeposited nickel Z1 = CRES/passivated										
Shell Size	9 11 13 17 19 21 23 25										
Ground Option	G = Common ground - (dash) = None										
Insert Arrangement	Per MIL-STD-1560 plus custom layouts; symmetrical layouts only, consult factory for complete details										
Insert Designator	A = Pin insert, less contacts B = Socket insert, less contacts										
Alternate Polarization (L°)	A = 40°, B = 65°, C = 80°, D = 210°, E = 250°, N = 135° Normal										
Non Sealing	NS = Non sealing version Omit = Sealing version										
Optional Mod Code	909** = See Mod Code specifications below										

*Refer to section A for complete details. Refer to Space-Grade Guidelines material (IAW NASA EEE INST-002) for outgassing and screening modification codes, on pages 80 and 81. Modification codes may be added directly to the end of any valid part number

Modification code 909xx is used to supply D38999 Series III Type connectors featuring crimp removable type contacts with high-speed contact kits. Kits include spares, tools, and sealing plugs. See example below.

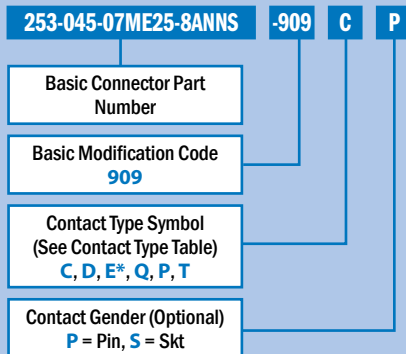

*For El Ochito see Contact Configuration Table on following page for appropriate code and dash number symbol.

FIGURE 2: REFERENCE ORIENTATION OF INNER PINS RELATIVE TO CONNECTOR MAIN KEY/KEYWAY

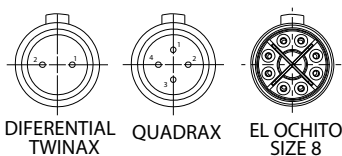

Contact Type					
Sym	Description	Glenair P/N	Wire Type	Grommet Follower	Application Notes
C	Size 16, contact for coax cable, per M39029/76 & /77;	Pin: 852-008-16-424 Skt: 852-009-16-428	RG174, RG316, RG179	N/A	Analog radio frequency or microwave applications
	Size 12, contact for coax cable, per M39029/102 & /103	Pin: 852-004-12-558 Skt: 852-005-12-559	RG174, RG316, RG179	N/A	
	Size 8, contact for coax cable, per M39029/59 & /60	Pin: 852-007-08-367 Skt: 852-006-08-366	M17 /95-RG180	859-042-02	
C1	Size 8, contact for 75 ohm coax cable	Pin: 852-056-01 Skt: 852-057-01	V73263, V75268, V76261	859-042-01	aerospace-grade digital video
D	Size 8, diff. twinax contact for 24 AWG twinax cable	Pin: 853-014-05 Skt: 853-013-05	M17 /176-00002	859-042-01	1553 databus / differential signal
E*	Size 8, El Ochito® contact for 26 AWG	White Pin: 858-003-02 Skt: 858-004-02	963-003-26 963-033-26	687-643-8-2	1G/10G Base-T Ethernet (white)
	Size 8, El Ochito® contact for 24/26-30 AWG Cable	Blue Pin: 858-028-02 Skt: 858-029-02	963-110 & 963-118	687-643-8-2	USB 3.0 (Blue)
	Size 8, El Ochito® contact for 26-30 AWG Cable	Red Pin: 858-030-02 Skt: 858-031-02	963-033-26	687-643-8-2	SATA 3.0 General High Speed (red)
Q	Size 8, contact for 24 AWG Quadrax	Pin: 854-001-02 Skt: 854-002-02	963-020	859-042-02	10/100Base-T ethernet
P	Size 8, power contact for 8 AWG	Pin: 850-014 Skt: 850-013	M22759/11 or equivalent	859-042-03	Power
T	Size 8, triax/concentric twinax for twinax cable	Pin: 853-003-08-625 Skt: 853-004-08-628	M17 /176-00002	859-042-01	1553 Databus

* See Table II for Contact Positions. See Figure 2 for orientation of inner pins relative to connector main key/keyway.

MIL-DTL-38999 Series III Type Space-Grade Connectors

253-044 Fixed mount plug with roll off nose an crimp contacts

HIGH-SPEED SPACE-GRADE CONNECTORS

EI Ochito Protocols		
WHITE	BLUE	RED
10GBASE-T	USB 3.0	Multi Gigabit 100 ohm protocols HDMI, SATA, DisplayPort



Example Code E7



Example Code E5

PANEL TO PANEL DIMENSIONS

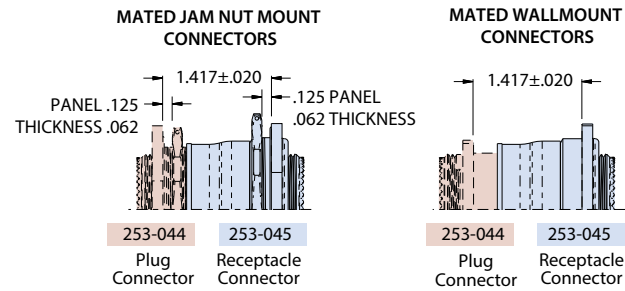

NOTES:

- Glenair 253-044 is designed to mate with 253-045 with same insert arrangement and polarization
- Stainless steel locating pin to be shipped with L7 jam-nut connector
- Misalignment capabilities are possible with 253-045, when mated to 253-044.
- See page 80 for outgassing options
- 253-045 connectors are rear panel mount only. Panel to panel dimensions the same for all configurations. Tolerance as shown
- Contact Manufacturer for outgassing options
- Material/finish
 - Shell, jam-nut: see P/N development, finish
 - Insulator: high grade rigid dielectric/N.A.
 - Seals: fluorosilicone blend/N.A.
 - Contacts: copper alloy/gold plated

EI Ochito Contact Configuration								
SYM	CAVITY A	CAVITY B	CAVITY C	CAVITY D	CAVITY E	CAVITY F	CAVITY G	CAVITY H
E	W	W	W	W	W	W	W	W
E2	B	W	W	W	W	W	W	W
E3	R	W	W	W	W	W	W	W
E4	B	B	W	W	W	W	W	W
E5	R	B	W	W	W	W	W	W
E6	R	R	W	W	W	W	W	W
E7	B	B	B	W	W	W	W	W
E8	R	B	B	W	W	W	W	W
E9	R	R	B	W	W	W	W	W
E10	R	R	R	W	W	W	W	W
E11	B	B	B	B	W	W	W	W
E12	R	B	B	B	W	W	W	W
E13	R	R	B	B	W	W	W	W
E14	R	R	R	B	W	W	W	W
E15	R	R	R	R	W	W	W	W
E16	B	B	B	B	B	W	W	W
E17	R	B	B	B	B	W	W	W
E18	R	R	B	B	B	W	W	W
E19	R	R	R	B	B	W	W	W
E20	R	R	R	R	B	W	W	W
E21	R	R	R	R	R	W	W	W
E22	B	B	B	B	B	B	W	W
E23	R	B	B	B	B	B	W	W
E24	R	R	B	B	B	B	W	W
E25	R	R	R	B	B	B	W	W
E26	R	R	R	R	B	B	W	W
E27	R	R	R	R	R	B	W	W
E28	R	R	R	R	R	R	W	W
E29	B	B	B	B	B	B	B	W
E30	R	B	B	B	B	B	B	W
E31	R	R	B	B	B	B	B	W
E32	R	R	R	B	B	B	B	W
E33	R	R	R	R	B	B	B	W
E34	R	R	R	R	R	B	B	W
E35	R	R	R	R	R	R	B	W
E36	R	R	R	R	R	R	R	W
E37	B	B	B	B	B	B	B	B
E38	R	B	B	B	B	B	B	B
E39	R	R	B	B	B	B	B	B
E40	R	R	R	B	B	B	B	B
E41	R	R	R	R	B	B	B	B
E42	R	R	R	R	R	B	B	B
E43	R	R	R	R	R	R	B	B
E44	R	R	R	R	R	R	R	B
E45	R	R	R	R	R	R	R	R

253-045-L7 JAM-NUT MOUNT, FLOAT MOUNT RECEPTACLE WITH LOCATING PIN, ROLL-ON/ROLL-OFF NOSE, ACCESSORY THREADS AND SIZE 8 HIGH-SPEED CONTACTS

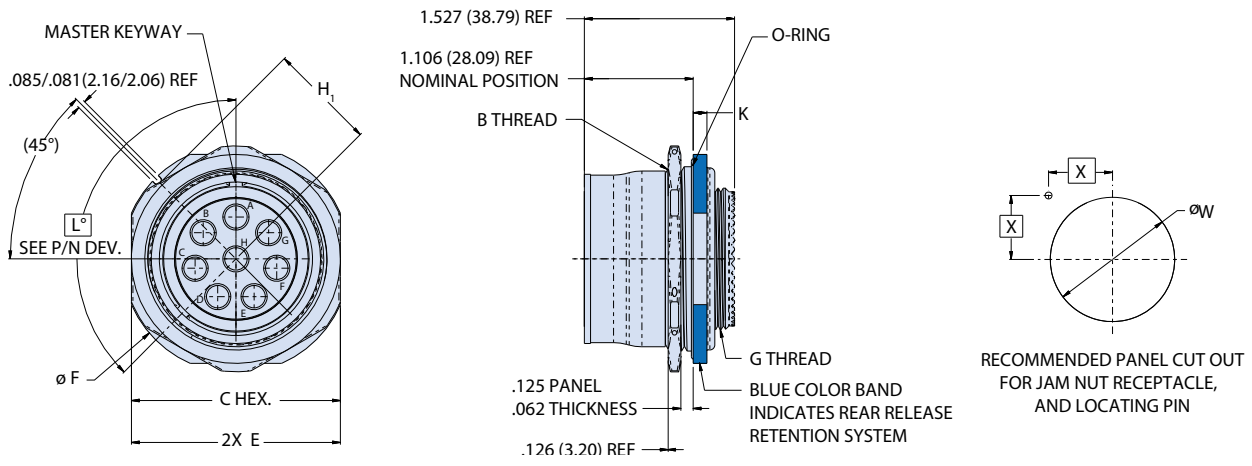

HIGH-SPEED SPACE-GRADE CONNECTORS

253-045-L7 Dimensions

SHELL SIZE	B THREAD CLASS 2A	C ±.015	E ±.015	ø F	H ₁ +.000/-0.008	G THREAD UNEF CLASS 2A	K FLANGE THICKNESS
11	1.0000-20 UNEF	1.175 (29.85)	1.266 (32.16)	1.500 (38.10)	0.666 (16.92)	.5625-24	0.109 (2.77)
13	1.1250-18 UNEF	1.294 (32.87)	1.391 (35.33)	1.641 (41.68)	0.729 (18.52)	.6875-24	0.109 (2.77)
15	1.2500-18 UNEF	1.451 (36.86)	1.516 (38.51)	1.750 (44.45)	0.791 (20.09)	.8125-20	0.109 (2.77)
17	1.3750-18 UNEF	1.569 (39.85)	1.641 (41.68)	1.938 (49.23)	0.893 (22.68)	.9375-20	0.109 (2.77)
19	1.5000-18 UNEF	1.687 (42.85)	1.828 (46.43)	2.062 (52.37)	0.955 (24.26)	1.0625-18	0.140 (3.56)
21	1.6250-18 UNEF	1.875 (47.63)	1.954 (49.63)	2.188 (55.58)	1.017 (25.83)	1.1875-18	0.140 (3.56)
23	1.7500-18 UNS	2.010 (51.05)	2.078 (52.78)	2.312 (58.72)	1.080 (27.43)	1.3125-18	0.140 (3.56)
25	1.8750-16 UN	2.125 (53.97)	2.128 (54.05)	2.327 (59.11)	1.086 (27.58)	1.4375-18	0.140 (3.56)

Panel Mount Dimensions

SHELL SIZE	ø W +.010/0.000	X
11	1.010 (25.65)	0.504 (12.80)
13	1.135 (28.83)	0.549 (13.94)
15	1.260 (32.00)	0.593 (15.06)
17	1.385 (35.18)	0.665 (16.89)
19	1.510 (38.35)	0.709 (18.01)
21	1.635 (41.53)	0.753 (19.13)
23	1.760 (44.70)	0.797 (20.24)
25	1.885 (47.88)	0.799 (20.29)

253-045-07 JAM-NUT MOUNT, FLOAT MOUNT RECEPTACLE WITH LOCATING PIN, ROLL-ON/ROLL-OFF NOSE, ACCESSORY THREADS AND SIZE 8 HIGH-SPEED CONTACTS

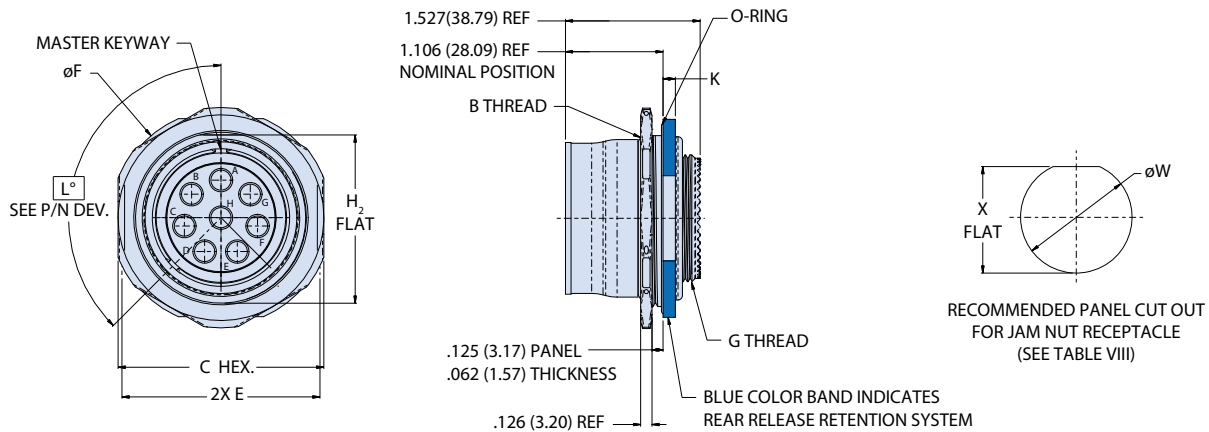

253-045-L7 Dimensions								
SHELL SIZE	B THREAD CLASS 2A	C $\pm .015$	E $\pm .015$	ϕF	H_1 $+.000/-0.008$	H_2 $+.000/-0.006$	G THREAD CLASS 2A	K FLANGE THICKNESS
11	1.0000-20 UNEF	1.175 (29.85)	1.266 (32.16)	1.500 (38.10)	0.666 (16.92)	1.066 (27.08)	.5625-24	0.109 (2.77)
13	1.1250-18 UNEF	1.294 (32.87)	1.391 (35.33)	1.641 (41.68)	0.729 (18.52)	1.191 (30.25)	.6875-24	0.109 (2.77)
15	1.2500-18 UNEF	1.451 (36.86)	1.516 (38.51)	1.750 (44.45)	0.791 (20.09)	1.316 (33.43)	.8125-20	0.109 (2.77)
17	1.3750-18 UNEF	1.569 (39.85)	1.641 (41.68)	1.938 (49.23)	0.893 (22.68)	1.441 (36.60)	.9375-20	0.109 (2.77)
19	1.5000-18 UNEF	1.687 (42.85)	1.828 (46.43)	2.062 (52.37)	0.955 (24.26)	1.566 (39.78)	1.0625-18	0.140 (3.56)
21	1.6250-18 UNEF	1.875 (47.63)	1.954 (49.63)	2.188 (55.58)	1.017 (25.83)	4.691 (119.15)	1.1875-18	0.140 (3.56)
23	1.7500-18 UNS	2.010 (51.05)	2.078 (52.78)	2.312 (58.72)	1.080 (27.43)	1.816 (46.13)	1.3125-18	0.140 (3.56)
25	1.8750-16 UN	2.125 (53.97)	2.128 (54.05)	2.327 (59.11)	1.086 (27.58)	1.941 (49.30)	1.4375-18	0.140 (3.56)

Panel Mount Dimensions		
SHELL SIZE	ϕW $+.010/0.000$	X FLAT $+.000/-0.010$
11	1.135 (28.83)	1.085 (27.56)
13	1.260 (32.00)	1.210 (30.73)
15	1.385 (35.18)	1.335 (33.91)
17	1.510 (38.35)	1.460 (37.08)
19	1.635 (41.53)	1.585 (40.26)
21	1.760 (44.70)	1.710 (43.43)
23	1.885 (47.88)	1.835 (46.61)
25	2.010 (51.05)	1.960 (49.78)

253-045-00 WALL MOUNT FLOAT MOUNT RECEPTACLE WITH SLOTTED HOLES, ROLL-ON/ROLL-OFF NOSE, ACCESSORY THREADS AND SIZE 8 HIGH-SPEED CONTACTS

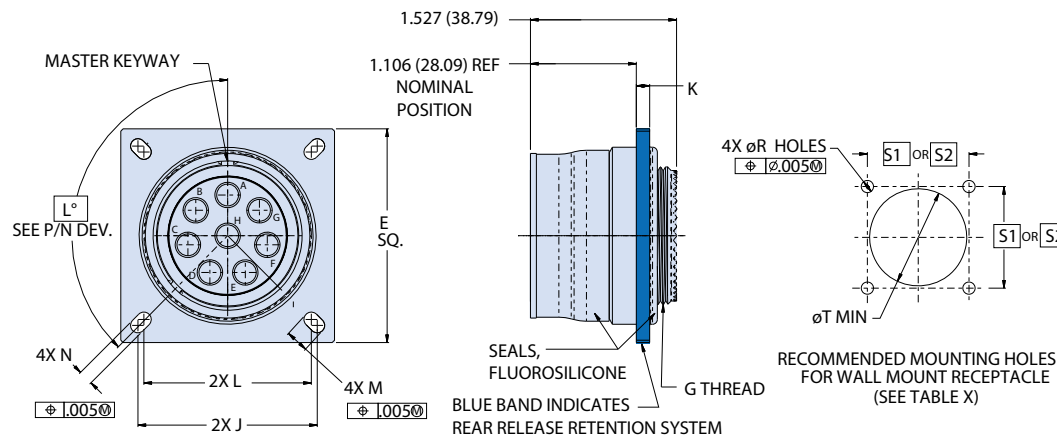

Panel Mount		
SHELL SIZE	T DIA. +.010 0.000	R DIA.
11	0.970 (24.64)	0.133 (3.38)
13	1.095 (27.81)	0.123 (3.12)
15	1.200 (30.48)	0.155 (3.94)
17	1.335 (33.91)	0.145 (3.68)
19	1.450 (36.83)	
21	1.575 (40.00)	
23	1.720 (43.69)	
25	1.845 (46.86)	

253-045-00 Dimensions with Sealing

SHELL SIZE	E	L	J	M	N	G THREAD UNEF CLASS 2A	K FLANGE THICKNESS	S1	S2
11	1.311 (33.30)	0.969 (24.61)	1.062 (26.97)	0.194 (4.93)	0.128 (3.25)	.5625-24	0.109 (2.77)	0.969 (24.61)	1.062 (26.97)
13	1.437 (36.50)	1.062 (26.97)	1.156 (29.36)	0.194 (4.93)	0.128 (3.25)	.6875-24	0.109 (2.77)	1.062 (26.97)	1.156 (29.36)
15	1.563 (39.70)	1.156 (29.36)	1.250 (31.75)	0.194 (4.93)	0.128 (3.25)	.8125-20	0.109 (2.77)	1.156 (29.36)	1.250 (31.75)
17	1.689 (42.90)	1.250 (31.75)	1.375 (34.92)	0.216 (5.49)	0.128 (3.25)	.9375-20	0.109 (2.77)	1.250 (31.75)	1.375 (34.92)
19	1.811 (46.00)	1.375 (34.92)	1.500 (38.10)	0.242 (6.15)	0.154 (3.91)	1.0625-18	0.140 (3.56)	1.375 (34.92)	1.500 (38.10)
21	1.952 (49.58)	1.500 (38.10)	1.625 (41.28)	0.242 (6.15)	0.154 (3.91)	1.1875-18	0.140 (3.56)	1.500 (38.10)	1.625 (41.28)
23	2.093 (53.16)	1.625 (41.28)	1.750 (44.45)	0.242 (6.15)	0.154 (3.91)	1.3125-18	0.140 (3.56)	1.625 (41.28)	1.750 (44.45)
25	2.234 (56.74)	1.750 (44.45)	1.875 (47.63)	0.242 (6.15)	0.154 (3.91)	1.4375-18	0.140 (3.56)	1.750 (44.45)	1.875 (47.63)

253-045-00 Dimensions without Sealing

SHELL SIZE	EE	LL	JJ	MM	NN	GG THREAD UNEF CLASS 2A	KK FLANGE THICKNESS	SS1	SS2
11	1.126 (28.60)	0.812 (20.62)	0.906 (23.01)	0.194 (4.93)	0.128 (3.25)	.5625-24	0.109 (2.77)	0.812 (20.62)	0.906 (23.01)
13	1.220 (30.99)	0.906 (23.01)	0.969 (24.61)	0.173 (4.39)	0.128 (3.25)	.6875-24	0.109 (2.77)	0.906 (23.01)	0.969 (24.61)
15	1.311 (33.30)	0.969 (24.61)	1.062 (26.97)	0.194 (4.93)	0.128 (3.25)	.8125-20	0.109 (2.77)	0.969 (24.61)	1.062 (26.97)
17	1.437 (36.50)	1.062 (26.97)	1.156 (29.36)	0.194 (4.93)	0.128 (3.25)	.9375-20	0.109 (2.77)	1.062 (26.97)	1.156 (29.36)
19	1.563 (39.70)	1.156 (29.36)	1.250 (31.75)	0.220 (5.59)	0.154 (3.91)	1.0625-18	0.140 (3.56)	1.156 (29.36)	1.250 (31.75)
21	1.689 (42.90)	1.250 (31.75)	1.375 (34.92)	0.242 (6.15)	0.154 (3.91)	1.1875-18	0.140 (3.56)	1.250 (31.75)	1.375 (34.92)
23	1.811 (46.00)	1.375 (34.92)	1.500 (38.10)	0.242 (6.15)	0.154 (3.91)	1.3125-18	0.140 (3.56)	1.375 (34.92)	1.500 (38.10)
25	1.952 (49.58)	1.500 (38.10)	1.625 (41.28)	0.242 (6.15)	0.154 (3.91)	1.4375-18	0.140 (3.56)	1.500 (38.10)	1.625 (41.28)

HIGH-SPEED SPACE-GRADE CONNECTORS

253-045-D0 WALL MOUNT FLOAT MOUNT RECEPTACLE WITH ROUND HOLES, ROLL-ON/ROLL-OFF NOSE, ACCESSORY THREADS AND SIZE 8 HIGH-SPEED CONTACTS

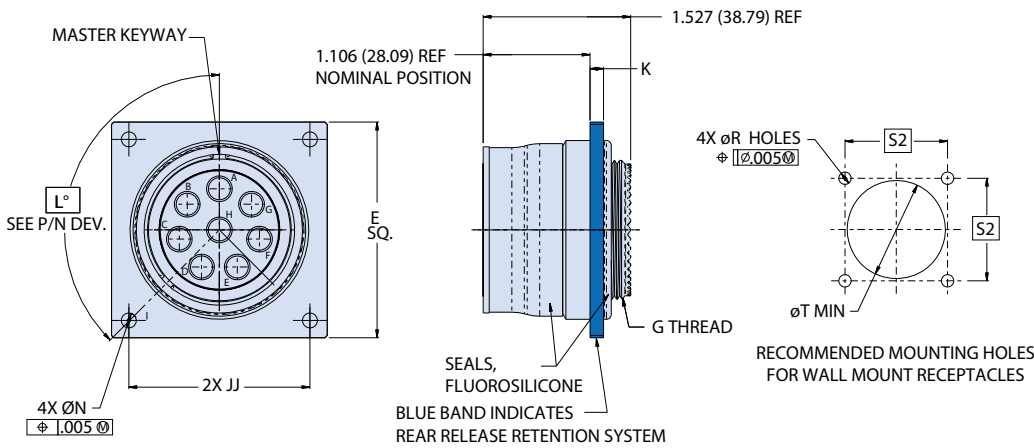

Panel Mount		
SHELL SIZE	T DIA. +.010 0.000	R DIA.
11	0.970	0.133 0.123
13	1.095	
15	1.200	
17	1.335	0.155 0.145
19	1.450	
21	1.575	
23	1.720	
25	1.845	

253-045-D0 Dimensions with Sealing						
SHELL SIZE	E	J	N	G THREAD UNEF CLASS 2A	K FLANGE THICKNESS	S2
11	1.311 (33.30)	1.062 (26.97)	0.128 (3.25)	.5625-24	0.109 (2.77)	1.062 (26.97)
13	1.437 (36.50)	1.156 (29.36)	0.128 (3.25)	.6875-24	0.109 (2.77)	1.156 (29.36)
15	1.563 (39.70)	1.250 (31.75)	0.128 (3.25)	.8125-20	0.109 (2.77)	1.250 (31.75)
17	1.689 (42.90)	1.375 (34.92)	0.128 (3.25)	.9375-20	0.109 (2.77)	1.375 (34.92)
19	1.811 (46.00)	1.500 (38.10)	0.154 (3.91)	1.0625-18	0.140 (3.56)	1.500 (38.10)
21	1.952 (49.58)	1.625 (41.28)	0.154 (3.91)	1.1875-18	0.140 (3.56)	1.625 (41.28)
23	2.093 (53.16)	1.750 (44.45)	0.154 (3.91)	1.3125-18	0.140 (3.56)	1.750 (44.45)
25	2.234 (56.74)	1.875 (47.63)	0.154 (3.91)	1.4375-18	0.140 (3.56)	1.875 (47.63)

253-045-D0 Dimensions without Sealing						
SHELL SIZE	EE	JJ	NN	GG THREAD UNEF CLASS 2A	KK FLANGE THICKNESS	SS2
11	1.126 (28.60)	0.906 (23.01)	0.128 (3.25)	.5625-24	0.109 (2.77)	0.906 (23.01)
13	1.220 (30.99)	0.969 (24.61)	0.128 (3.25)	.6875-24	0.109 (2.77)	0.969 (24.61)
15	1.311 (33.30)	1.062 (26.97)	0.128 (3.25)	.8125-20	0.109 (2.77)	1.062 (26.97)
17	1.437 (36.50)	1.156 (29.36)	0.128 (3.25)	.9375-20	0.109 (2.77)	1.156 (29.36)
19	1.563 (39.70)	1.250 (31.75)	0.154 (3.91)	1.0625-18	0.140 (3.56)	1.250 (31.75)
21	1.689 (42.90)	1.375 (34.92)	0.154 (3.91)	1.1875-18	0.140 (3.56)	1.375 (34.92)
23	1.811 (46.00)	1.500 (38.10)	0.154 (3.91)	1.3125-18	0.140 (3.56)	1.500 (38.10)
25	1.952 (49.58)	1.625 (41.28)	0.154 (3.91)	1.4375-18	0.140 (3.56)	1.625 (41.28)