

**Product selection guide  
MIL-DTL-38999 Series III Type**

**SuperNine® High-Speed Size #8 Contacts**

High-Speed Technology Overview	C-2
Contacts and insert arrangements	C-4
Insert Arrangements	C-5
Performance Summary, Material/Finish and Panel Cutout Dimensions	C-7
Shielded PC Tail Contacts - Dimensions and Footprints	C-46

**El Ochito® Octaxial Contacts**

*High-Speed, Keyed Crimp Contacts*

Technology Overview	C-8	Contact Dimensions	C-14
Ordering Information	C-10	Signal Integrity Data	C-15
Technical Data and sealing boots	C-11	Ethernet & USB Cables	C-17
Contact Config. Table	C-12	Cable Asemblies, Single and Double Ended	C-20
Assembly Tools	C-13	Ethernet Test Adapters	C-29

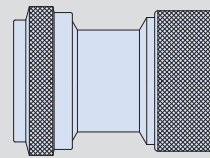

**377HS121** C-49  
Series 37 Aluminum Backshells: for SuperNine plug and receptacle connectors. Straight, 45°, and 90° configurations available.

**SuperNine® with SpeedMaster™ Contacts**

SpeedMaster 10G Technology Overview	C-50
Pre-Wired Contact Modules	C-52
Contact Modules	C-54
10G Compliance Testing	C-55
Performance Specifications	C-56
Assembly Instructions	C-67

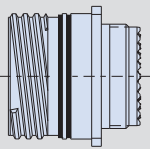

**233-217 and 233-224** C-31  
SuperNine® Plug and Receptacle Connectors with Accessory Threads or Integral Banding Porch and Removable High-Speed, Keyed Crimp Contacts.

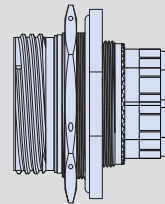

**233-219** C-58  
Plug and receptacle SuperNine Connector with SpeedMaster High-Speed Contact Modules and Size 22 Contacts

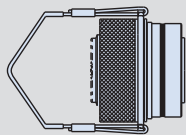

**233-260** C-35  
SuperNine® Quick-Disconnect Plug with Rear Crimp Removable Contacts.

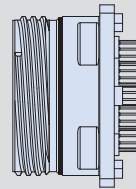

**233-220** C-62  
Wall mount dimensions SuperNine receptacle with PC tail SpeedMaster™ contacts

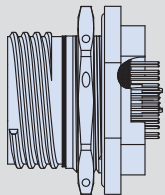

**233-218** C-37  
SuperNine® PC Tail Receptacle Connectors with Potted Non-Removable, PC Tail Contacts.

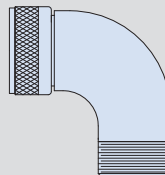

**377-119** C-65  
Series 37 Aluminum Backshells: for SpeedMaster™ SuperNine plug and receptacle connectors. Straight, 45°, and 90° configurations available.

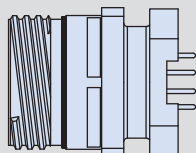

**233-225** C-41  
SuperNine® PC Tail Dual Flange Receptacle Connectors with Potted PC Tail Contacts