

# HIGH TEMPERATURE ThermaRex HT Series 806 Backshell

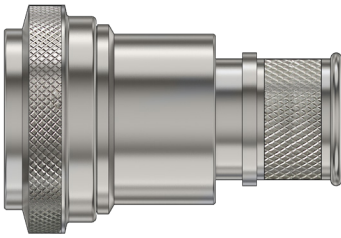

## Banding Backshell, Shrink Boot, Self-Locking 440VS191-1181

THERMAREX™ HT

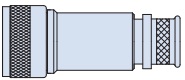
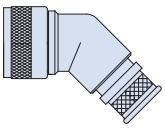
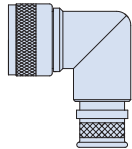
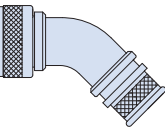
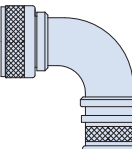

Self-Locking. Band-Master ATS® shield termination. 440V\*191 banding backshell fits Glenair's Series 806 connectors. Anti-decoupling mechanism provides audible detented coupling and prevents backoff under high vibration. Terminate cable braid shield to backshell with optional band strap. Stainless steel, silicone O-ring, stainless steel detent spring, stainless steel band. Tested for 1000 hours at 300°C and in random vibration at 300°C.

Profile Selection Guide	
<b>S Straight</b> 	
<b>H 45°</b> 	<b>J 90°</b> 
<b>M 45°</b> 	<b>N 90°</b> 

How To Order							
Sample Part Number	440VS191 Z1 20 12- 4 K -1181						
Series / Basic Part No.	440VS191 440VH191 440VJ191 440VM191 440VN191						
Material/Finish	Z1 = SST/ Passivated						
Shell Size	08, 09, 10, 11, 12, 14, 16, 18, 20, 22, 24						
Entry Size	See Entry Size table						
Length	3 1.5 inches Applies to Profile S only. 4 2.0 inches If Entry Size is greater than "Maximum 5 2.5 inches Entry Size" (see next page), then 2 inch 6 3.0 inches minimum applies.						
Band	Omit if not required K = Pre-Coiled Band						
Mod	-1181 = ThermaRex Elastomers						

ENTRY SIZE										
Entry Size	Shell Sizes*	± .015 (0.4)			Entry Size	Shell Sizes*	± .015 (0.4)			
		øX	øY	øZ			øX	øY	øZ	
02	08-24	.125 (3.18)	.250 (6.35)	.312 (7.92)	13	18-24	.812 (20.62)	.938 (23.83)	1.000 (25.40)	
03	08-24	.188 (4.78)	.312 (7.92)	.374 (9.50)	14	20-24	.875 (22.23)	1.000 (25.40)	1.062 (26.97)	
04	08-24	.250 (6.35)	.375 (9.52)	.438 (11.13)	15	20-24	.938 (23.83)	1.062 (26.97)	1.124 (28.55)	
05	09-24	.312 (7.92)	.438 (11.13)	.500 (12.70)	16	22-24	1.000 (25.40)	1.125 (28.58)	1.187 (30.15)	
06	10-24	.375 (9.52)	.500 (12.70)	.562 (14.27)	17	22-24	1.062 (26.97)	1.188 (30.18)	1.250 (31.75)	
07	11-24	.438 (11.13)	.562 (14.27)	.624 (15.85)	18	24	1.125 (28.58)	1.250 (31.75)	1.312 (33.32)	
08	12-24	.500 (12.70)	.625 (15.88)	.687 (17.45)	20	-	1.250 (31.75)	1.375 (34.92)	1.437 (36.50)	
09	14-24	.562 (14.27)	.688 (17.48)	.750 (19.05)	22	-	1.375 (34.92)	1.500 (38.10)	1.562 (39.67)	
10	16-26	.625 (15.88)	.750 (19.05)	.812 (20.62)	24	-	1.500 (38.10)	1.625 (41.28)	1.687 (42.85)	
11	16-24	.688 (17.48)	.812 (20.62)	.874 (22.20)	26	-	1.625 (41.28)	1.750 (44.45)	1.812 (46.02)	
12	18-24	.750 (19.05)	.875 (22.23)	.937 (23.80)	28	-	1.750 (44.45)	1.875 (47.63)	1.937 (49.20)	

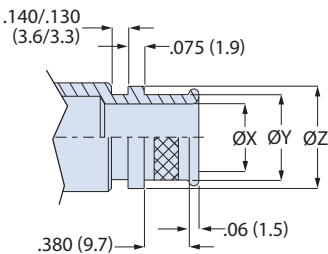

# HIGH TEMPERATURE ThermaRex HT Series 806 Backshell

## Banding Backshell, Shrink Boot, Self-Locking 440VS191-1181

THERMAREX™ HT

Dimensions										
	Profile S Straight	Profile H Cut/Weld 45°	Profile J Cut/Weld 90°	Profile M Full Radius 45°	Profile N Full Radius 90°					
Shell Size	A Thread ISO Metric	ØC Max.	F Max.	G Max.	H Max.	J Max.	K Max.	L Max.	M Max.	N Max.
08	M10 x 1.0-6H	.692 (17.58)	.64 (16.26)	.92 (23.37)	.76 (19.30)	1.13 (28.70)	.79 (20.07)	1.19 (30.23)	.94 (23.88)	1.35 (34.29)
09	M12 x 1.0-6H	.786 (19.96)	.65 (16.51)	.96 (24.38)	.79 (20.07)	1.18 (29.97)	.79 (20.07)	1.19 (30.23)	.94 (23.88)	1.35 (34.29)
10	M14 x 1.0-6H	.883 (22.43)	.68 (17.27)	.99 (25.15)	.84 (21.34)	1.23 (31.24)	.79 (20.07)	1.26 (32.00)	.97 (24.64)	1.45 (36.83)
11	M15 x 1.0-6H	.911 (23.14)	.69 (17.53)	1.02 (25.91)	.85 (21.59)	1.24 (31.50)	.79 (20.07)	1.26 (32.00)	.97 (24.64)	1.45 (36.83)
12	M17 x 1.0-6H	1.002 (25.45)	.72 (18.29)	1.05 (26.67)	.90 (22.86)	1.29 (32.77)	.83 (21.08)	1.34 (34.04)	1.04 (26.42)	1.55 (39.37)
14	M19 x 1.0-6H	1.066 (27.08)	.73 (18.54)	1.08 (27.43)	.93 (23.62)	1.32 (33.53)	.83 (21.08)	1.34 (34.04)	1.04 (26.42)	1.55 (39.37)
16	M22 x 1.0-6H	1.196 (30.38)	.77 (19.56)	1.15 (29.21)	1.00 (25.40)	1.40 (35.56)	.84 (21.34)	1.41 (35.81)	1.08 (27.43)	1.65 (41.91)
18	M25 x 1.0-6H	1.311 (33.30)	.80 (20.32)	1.21 (30.73)	1.05 (26.67)	1.49 (37.85)	.89 (22.61)	1.49 (37.85)	1.14 (28.96)	1.74 (44.20)
20	M28 x 1.0-6H	1.430 (36.32)	.84 (21.34)	1.27 (32.26)	1.11 (28.19)	1.58 (40.13)	.92 (23.37)	1.56 (39.62)	1.21 (30.73)	1.84 (46.74)
22	M31 x 1.0-6H	1.548 (39.32)	.87 (22.10)	1.32 (33.53)	1.17 (29.72)	1.66 (42.16)	.95 (24.13)	1.62 (41.15)	1.28 (32.51)	1.94 (49.28)
24	M34 x 1.0-6H	1.696 (43.08)	.92 (23.37)	1.39 (35.31)	1.25 (31.75)	1.77 (44.96)	.97 (24.64)	1.68 (42.67)	1.33 (33.78)	2.04 (51.82)

Maximum Entry Size			
If the selected entry size exceeds the maximum size in this table, the backshell will have a front adapter. This is called a <b>Style 2</b> backshell.			
Shell Size	Max. Entry Size	Shell Size	Max. Entry Size
08	04	16	11
09	05	18	13
10	06	20	15
11	07	22	17
12	08	24	18
14	09		

**Style 2 Straight Backshell**

Style 2 profile S straight backshell minimum length code is 4 (2 inches).

**Style 2 45° and 90° Backshells**

For 45° and 90° backshells, the front adapter adds 1 inch.

**Band**

Optional SST band strap provides fast, cost-effective and highly reliable termination of braided metallic shielding.

**Banding Tool 601-100**

Entry Sizes	Pre-Coiled Band P/N	Length	Max Diameter
02 - 12	601-006	9.00 (229)	1.00 (25.4)
13 - 24	601-041	14.25 (362)	1.80 (45.7)
26 - 28	601-050	18.00 (457)	2.50 (63.5)