

5

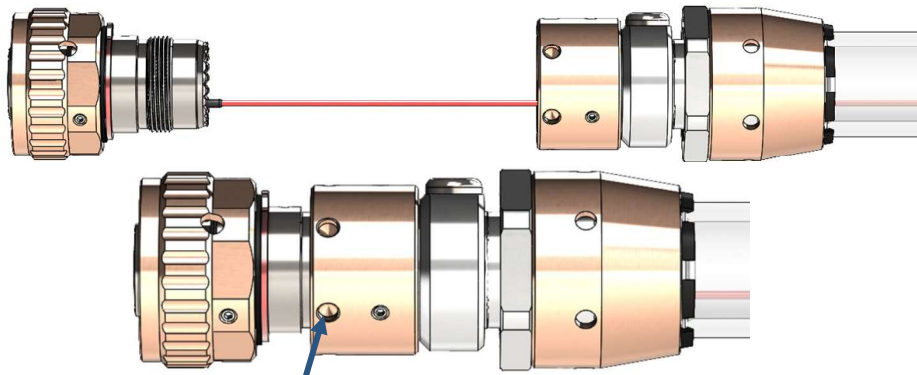

RECOMMENDED TORQUE

$\approx 10 \pm 0.5$ ft-lbs



Contact Us: Glenair, Inc.
1211 Air Way
Glendale, CA 91201

phone: (818)247-6000
email: sales@glenair.com
web: www.glenair.com

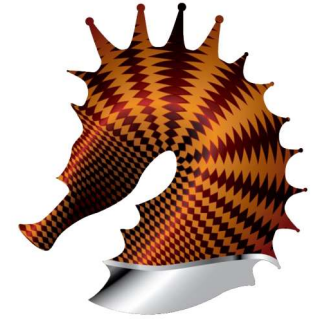

SeaKing

Assembly Instruction Card

Pressure Balanced Oil-Filled (PBOF) Cable Connector
Plug (CCP) Assembly

Refer to
709-099: SeaKing Contact Patterns
709-123: SeaKing PBOF Backshell
Dimensions and Information

Scan QR code for detailed, online
installation instructions and video.



6

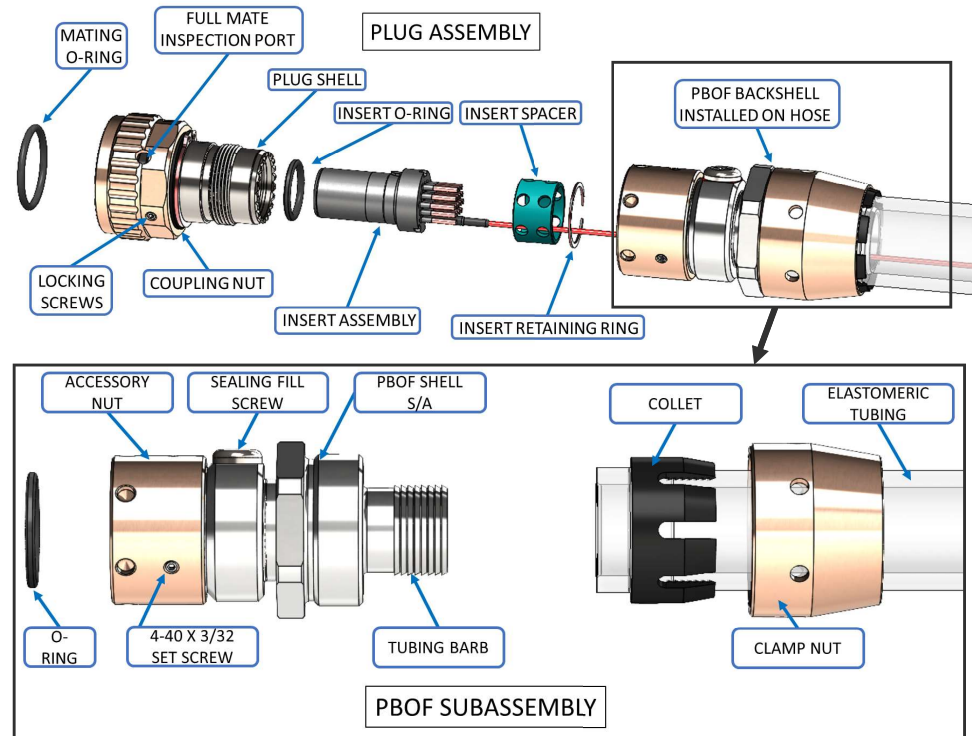
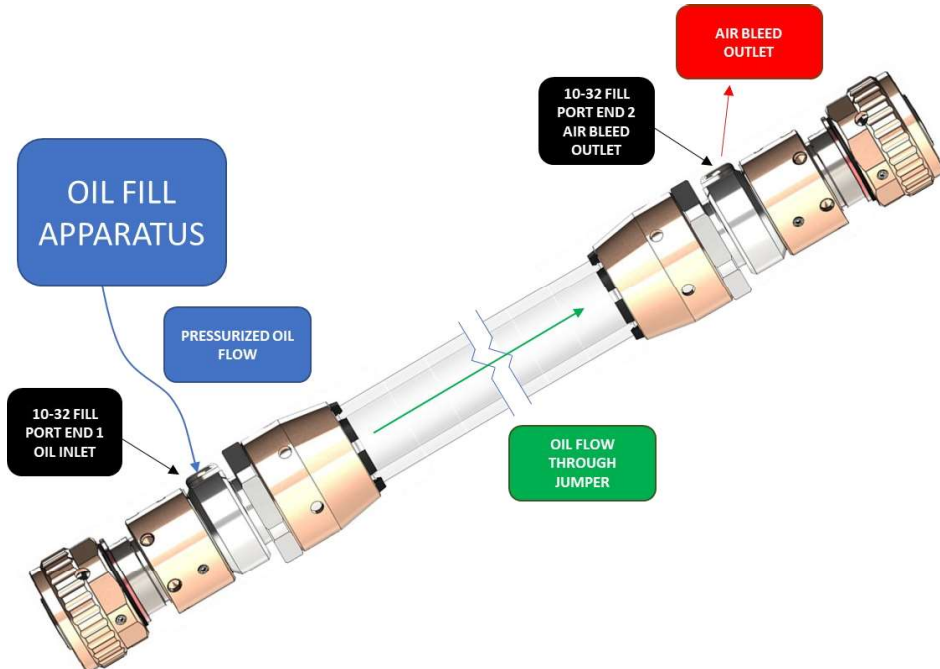

1

INSPECT AND CLEAN ALL SURFACES AND LUBRICATE ALL O-RINGS AND BOOTS PRIOR TO INSTALLATION. DO NOT LUBRICATE ELASTOMERIC HOSE OR HOSE BARB.

- Caution
- Inspection
- Verification
- PPE Required

WARNING: DO NOT SCRATCH O-RING SEALING SURFACES

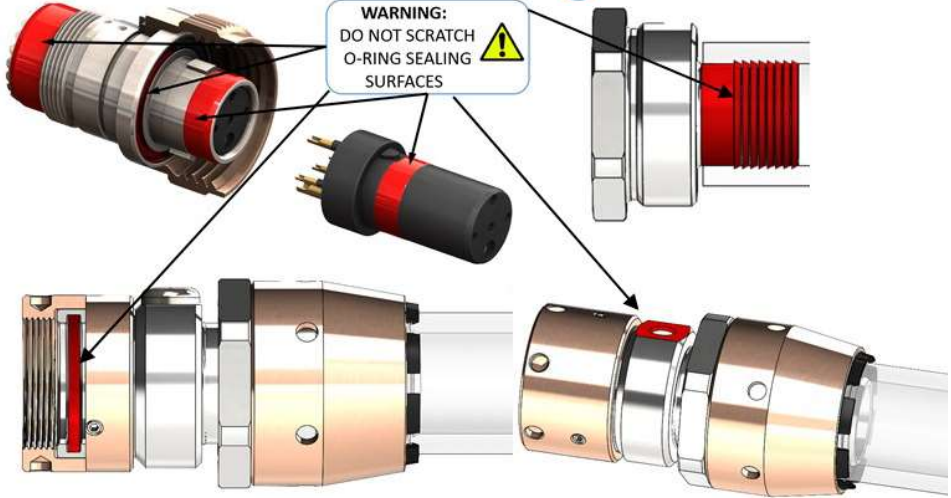

2

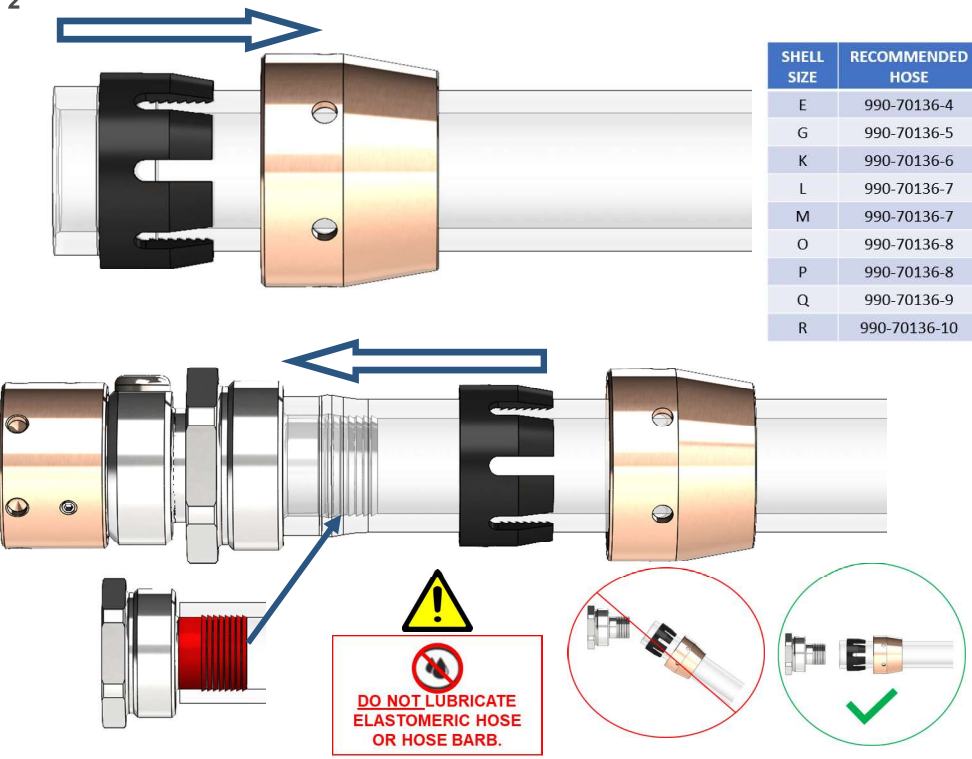

3

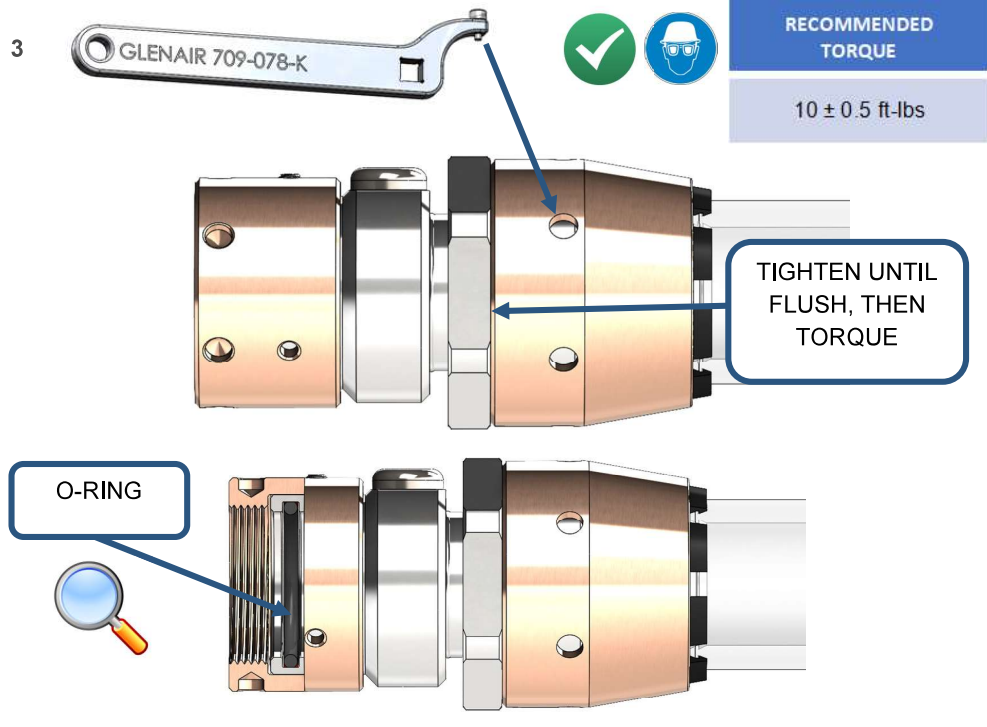

4

